

New Collections

2017

Knoll

Knoll



Modern Always

"Our legacy is the product and the product culture we leave behind. What we have done at Knoll with the products we inherited, and what we have done to create new things to move the company forward, we have done to honour and preserve the Knoll legacy."

Andrew B. Cogan
CEO Knoll, Inc.

" Notre patrimoine est à la fois le produit et la culture qui lui a donné naissance. Ce que nous avons fait chez Knoll des produits dont nous avons hérité, et ce que nous avons fait pour en créer de nouveaux et avancer, nous l'avons fait pour honorer cet héritage et le préserver. "

"Il prodotto e la cultura di prodotto sono il nostro patrimonio. Ciò che abbiamo ereditato dal nostro passato e quello che ci prefiggiamo per il futuro sono il nostro impegno per onorare e preservare il nostro retaggio culturale."

"Unser Vermächtnis ist es, unsere Produkte und die Produktkultur bleibend zu hinterlassen. Was wir, als Unternehmen Knoll getan haben, neue Dinge zu gestalten, um das Unternehmen vorwärts zu führen, haben wir getan, um das Knoll-Vermächtnis zu ehren und zu bewahren."





Avio is the new, contemporary and versatile sofa system that re-interprets and makes better use of any space. It is ideal for those who appreciate elegant design that epitomises a comfortable, relaxed lifestyle.

Avio est le nouveau système de canapé modulable et contemporain qui permet de ré-interpréter et d'optimiser l'espace. Expression d'un style de vie confortable et décontracté, il séduira les amateurs de design fort et élégant.

Avio è il nuovo, contemporaneo e versatile sistema di divani componibili, per reinterpretare e sfruttare ogni tipo di spazio, ideale per chi ama un design solido ed elegante, espressione di uno stile di vita comodo e rilassato.

Das Sofa Avio ist ein neues, zeitgemäßes und vielseitiges konstruktives Sofasystem, um alle Arten von Räumen neu zu interpretieren und zu nutzen. Es ist ideal für all diejenigen, die solides, elegantes Design schätzen, das Ausdrucksform eines gemütlichen und entspannten Lebensstils ist.

Avio Sofa System
Piero Lissoni, 2016

Platner Side Table
Warren Platner, 1966

Bertoia Bird Chair and Stool
Harry Bertoia, 1952







The Avio structure, transforms the sofa into a flexible system that allows an endless number of benches and sofa configurations. Solid and essential, Matrioska is a credenza conceived as a container made to house other containers. Matrioska can also be used as a central unit, it is perfect as a space divider in the middle of a room.

La structure de l'Avio est un système modulable qui permet un nombre infini de configurations. Matrioska est une crédence conçue comme un contenant pouvant accueillir d'autres contenants. Matrioska peut être également disposé au milieu d'une pièce comme une unité centrale de séparation.

Avio, grazie alla sua struttura, si traduce in un sistema flessibile che può dar luogo ad una sequenza di panche e configurazioni praticamente infinita. Matrioska è una credenza pensata come contenitore fatto per ospitare altri contenitori e può essere utilizzata anche come elemento centro - stanza per dividere gli spazi.

Avio ist wie ein modulares System aufgebaut. Der Aufbau stellt ein flexibles System dar, in dem Bänke, sowie Ablageflächen in einer praktisch unendlichen Abfolge Platz finden. Matrioska ist ein niedriger Schrank, das als Behältnis für weitere Boxen zur Aufbewahrung von Gegenständen dient. Matrioska kann an zentralen Plätzen positioniert sein, als Raumteiler.

Avio Bench
Piero Lissoni, 2016

Matrioska Credenza
Piero Lissoni, 2016

Platner Coffee Table
Warren Platner, 1966





Designed in 1954, the Florence Knoll Bench now stands as a defining example of modern design. Consistent with all of her designs, the bench has a spare, geometric profile that reflects the objective perfectionism and rational design approach Florence Knoll learned from her mentor, Mies van der Rohe.

Conçu en 1954, le Florence Knoll Bench est aujourd'hui l'exemple achevé du design moderne. Fidèle à l'esprit créateur de Florence Knoll, le banc adopte un profil géométrique minimaliste. Il reflète le perfectionnisme objectif et la démarche créatrice rationnelle qu'elle apprit de son mentor, Mies van der Rohe.

Disegnata nel 1954, la panca Florence Knoll è considerata uno degli esempi più rappresentativi del design moderno. Coerente con lo stile che caratterizza tutti i suoi prodotti, la panca ha una linea pulita e geometrica che riflette il perfezionismo e il design razionale che Florence Knoll ha ereditato dal suo mentore, Mies van der Rohe.

Obwohl die Florence Knoll Bank bereits 1954 entworfen wurde, ist sie heute eine unbestrittene Referenz für modernes Design. Wie alle Entwürfe von Florence Knoll hat auch diese Bank ein zurückhaltendes, geometrisches Profil, in dem sich der gegenständliche Perfektionismus und rationale Designansatz ihres Mentors Mies van der Rohe ausdrückt.

Florence Knoll Bench
Florence Knoll, 1954

Platner Lounge Chair
Warren Platner, 1966

Saarinen Coffee Table
Eero Saarinen, 1957



The elegance of Grasshopper derives from the perfect combination of surfaces and structure: the round or rectangular surfaces are characterised by their slenderness, while the structure is formed of very thin, high-performance cast steel elements.

Grasshopper doit son élégance à sa parfaite combinaison entre surfaces et structure : les premières, disponibles aux formats, rond ou rectangulaire, se distinguent par leur extrême finesse ; la seconde, ultra fine mais hautement fonctionnelle grâce à la fusion des éléments.

L'eleganza di Grasshopper si deve alla perfetta combinazione di superfici e struttura: le prime disponibili sia rotonde che rettangolari, sono connotate da spessori estremi; la seconda, esilissima ma ad alte prestazioni mediante elementi in fusione.

Die Eleganz von Grasshopper ergibt sich aus der perfekten Kombination von Oberflächen und Struktur: die runden oder rechteckige Flächen sind charakterisiert durch ihre schlanke Form, während die Struktur aus dünnem Hochleistungs-Stahlguss geformt ist und dabei sehr belastbar ist.

Grasshopper Table
Piero Lissoni, 2017

Avio Sofa System
Piero Lissoni, 2016

Conference Chair
Eero Saarinen, 1946/1950



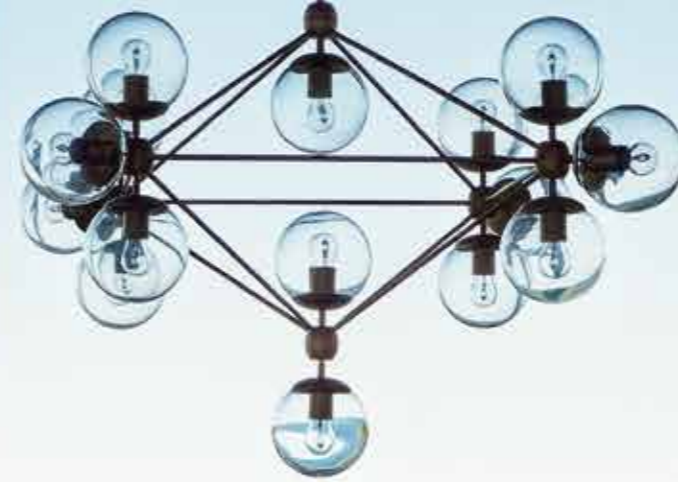

The Grasshopper table tops are available in glass, heat-treated woods and rare and exquisite stone.

La table Grasshopper est proposée avec des dessus en verre, en bois traité thermiquement et en pierre originale de toute beauté.

I piani del tavolo Grasshopper sono disponibili in cristallo, legno e marmi pregiati poco diffusi.

Die Tischplatten der Grasshopper-Kollektion sind in Glas, hitzebehandeltem Holz und in hochwertigem Marmor erhältlich.

Grasshopper Table
Piero Lissoni, 2017

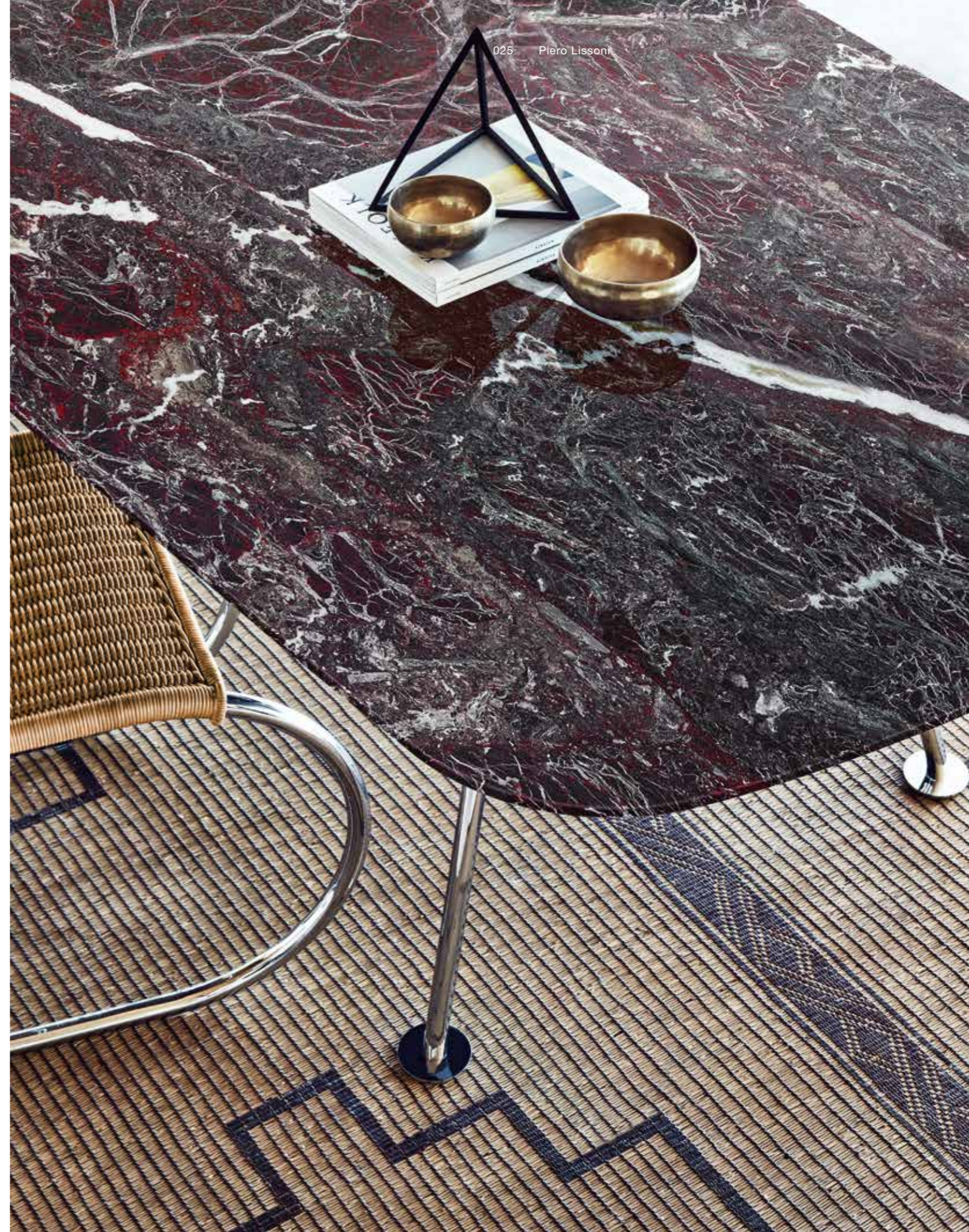





The 1957 introduction of Eero Saarinen's Pedestal Collection signaled Knoll's initial and widespread introduction of marble to its catalogue of furniture. After sixty years, we offer an evolving array of gorgeous stones finished to best show off and protect the surface.

En 1957 fut présentée la collection Pedestal d'Eero Saarinen siglée Knoll et l'utilisation généralisée du marbre fit son apparition dans le catalogue. Soixante ans après, nous proposons une gamme évolutive en pierres absolument superbes bénéficiant d'une finition parfaite pour les mettre en valeur et les protéger.

Nel 1957 l'introduzione della collezione Pedestal di Eero Saarinen ha segnato anche l'introduzione nel catalogo Knoll del marmo come materiale naturale. Dopo sessant'anni la gamma di pietre naturali offerta da Knoll si arricchisce di marmi dai colori sempre più esclusivi e preziosi.

Mit der Einführung des Pedestal Tisches von Eero Saarinen hielt Marmor seinen siegreichen Einzug in den Möbelkatalog von Knoll. 60 Jahre später bieten wir eine immer größere Vielfalt an atemberaubenden Steinen in bester Verarbeitung an, die ihre Schönheit mit geschützter Oberfläche hervorhebt.

Saarinen Pedestal Table
Eero Saarinen, 1957

Platner Lounge Chair
Warren Platner, 1966







The Pilot Chair embodies refinement, comfort and exceptional craftsmanship. A modern piece with a unique silhouette. It is available in a range of fabric and leather coverings, with high and low backs, without arms or with different arm options.

Le fauteuil « Pilot Chair » incarne l'élégance, le confort et un savoir-faire exceptionnel. Objet moderne à la silhouette unique, il est disponible en plusieurs revêtements tissu et cuir, avec dossiers en version haute ou basse, sans accoudoirs ou avec différentes options d'accoudoirs.

La poltrona Pilot racchiude in sé raffinatezza, comfort, ricercatezza dei materiali e altissima artigianalità. Un arredo moderno con una silhouette unica per un design essenziale e senza tempo. È disponibile con schienale alto o basso e con o senza braccioli in una vasta gamma di tessuti e pelli.

Der Pilot Chair verkörpert Raffinesse, Komfort und außergewöhnliche Handwerkskunst. Ein modernes Möbelstück mit einer einzigartigen Silhouette. Der Stuhl ist in einer umfassenden Vielfalt an Stoff- und Lederbezügen, mit hoher und niedriger Rückenlehne, mit verschiedenen Armlehnen-Varianten oder ohne Armlehnen verfügbar.

Pilot Collection for Knoll,
Edward Barber & Jay Osgerby, 2015

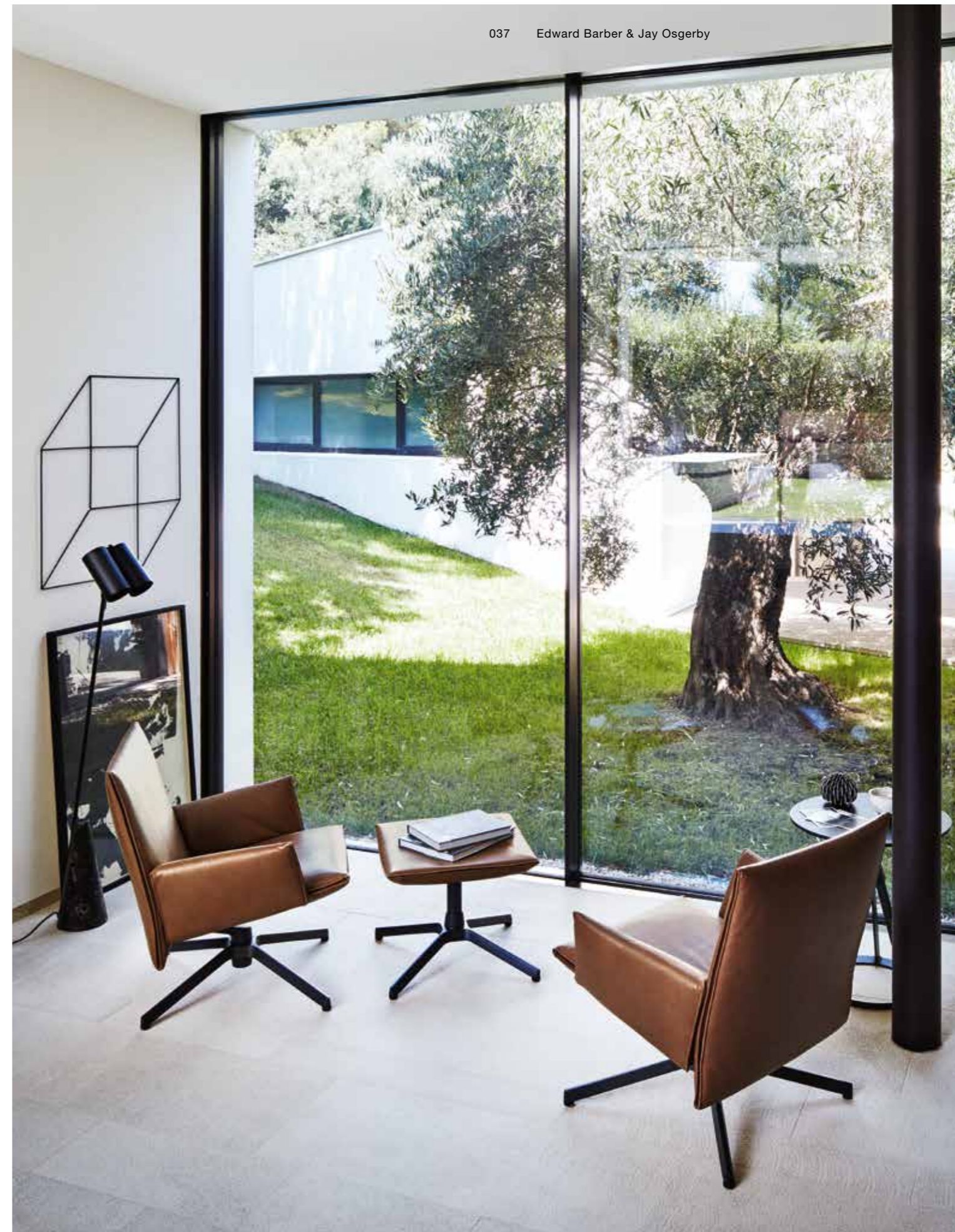





The Krusin Chair has an embedded structure available in solid ash with a variety of finishes. The cover can be chosen from the Knoll range of fabrics and leathers.

La structure de la chaise Krusin est disponible en frêne massif dans différentes finitions. Le revêtement est à choisir dans la gamme Knoll de cuirs et de tissus.

La sedia Krusin è disponibile in massello di frassino in diverse finiture. Il rivestimento può essere scelto nella gamma di pelli e tessuti Knoll.

Das Gestell des Krusin Stuhl ist aus massiv Esche in unterschiedlichen Ausführungen erhältlich. Der Bezug kann aus dem Knoll-Angebot an Ledern und Stoffen ausgewählt werden.

Krusin Collection 016
Marc Krusin, 2016





Eero Saarinen designed the groundbreaking Womb Chair at Florence Knoll's request. With a foam-coated chassis in soft polyurethane and down-filled cushions the Womb Chair Relax provides a comforting sense of security - hence the name.

C'est à la demande de Florence Knoll qu'Eero Saarinen a créé le fauteuil révolutionnaire Womb Chair. Avec sa coque en mousse de polyuréthane et ses coussins en plumes, le Womb Chair Relax invite à se blottir - d'où l'origine de son nom, « womb » signifiant « matrice ».

Eero Saarinen ha progettato l'innovativa poltrona Womb su richiesta di Florence Knoll. Con la sua scocca in poliuretano e i cuscini in piuma, la poltrona Womb Relax garantisce un considerevole e avvolgente comfort di seduta, da qui il nome.

Eero Saarinen entwarf auf Anfrage von Florence Knoll den innovativen Womb-Chair. Mit einer Schaumstoff überzogener Schale aus Softpolyurethan und Daunengefüllten Kissen unterstützt der Womb Chair Relax das komfortable Gefühl von Sicherheit, daher der Name.

Womb Chair Relax
Eero Saarinen, 1946

Platner Low Table
Warren Platner, 1966

Designed by Eero Saarinen in 1948, the fit-for-two settee is the perfect modern refuge for the living room, bedroom or office.

Conçu par Eero Saarinen en 1948, le Womb Settee, deux places, n'a rien perdu de sa modernité et offre l'espace de détente idéal pour le salon, la chambre ou le bureau.

Progettato da Eero Saarinen nel 1948, il Womb Settee è un elemento d'arredo ideale sia per la casa che per l'ufficio.

Entworfen von Eero Saarinen 1948, das Womb Settee ist der perfekte moderne Zufluchtsort im Wohnraum, Schlafzimmer oder Büro.

Womb Settee
Eero Saarinen, 1948

Saarin Coffee Table
Eero Saarinen, 1957

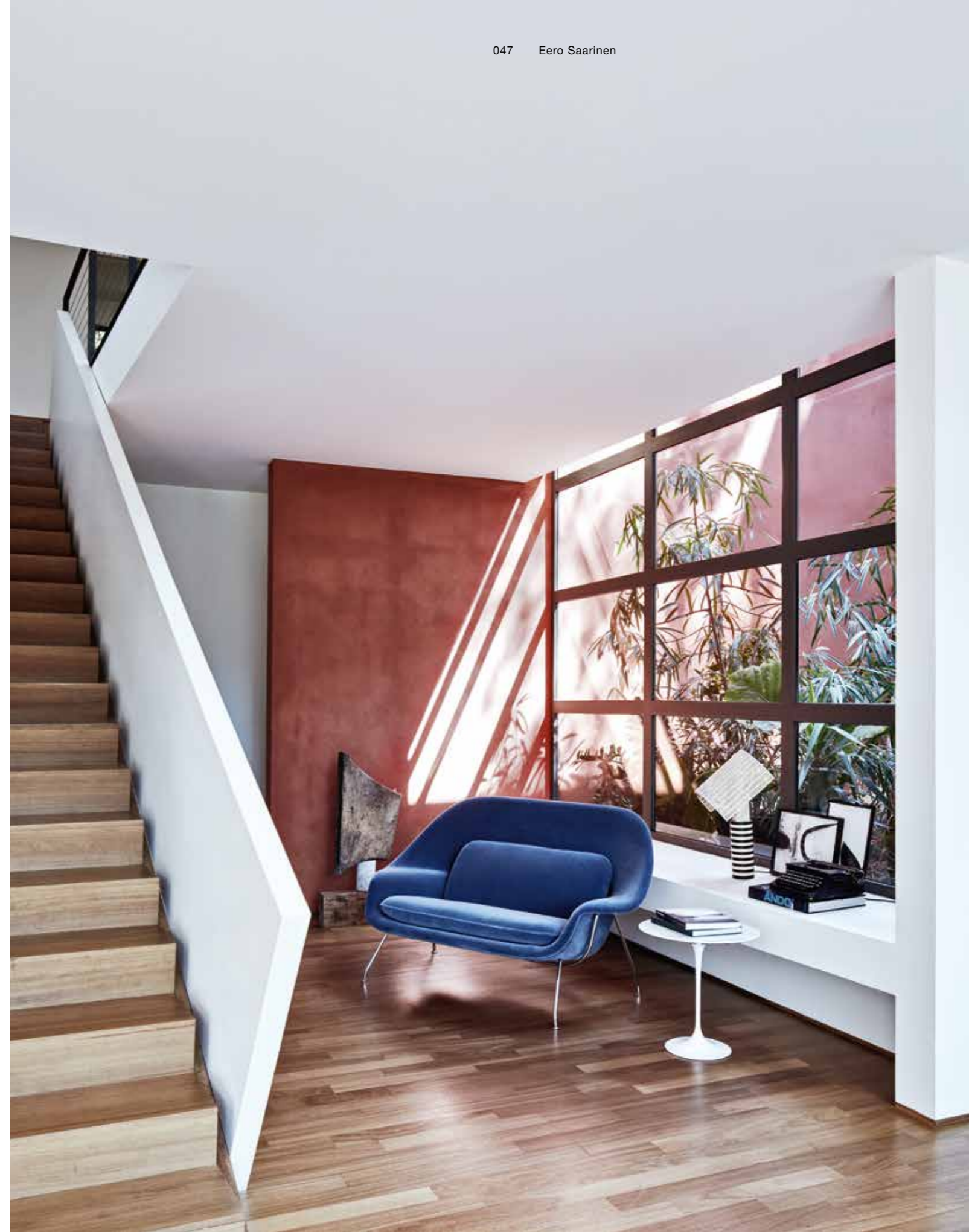





The Bertoia Chair with shell in cowhide is extremely comfortable and perfect in any environment, from residential to contract.

La chaise Bertoia avec la coque en cuir sellier est extrêmement confortable et convient aux espaces résidentiels tout comme professionnels.

La sedia Bertoia con la scocca in cuoio è estremamente comoda, moderna e perfetta in ogni tipo di ambiente, dal residenziale al contract.

Das Bertoia Side Chair mit Kernlederschale ist höchst komfortabel und fügt sich perfekt in jedes Ambiente - vom Wohn- bis zum Objektbereich - ein.

Bertoia Collection
Harry Bertoia, ca. 1950



Technical info

These products are part of a System Sofa Collection. More configurations are available.
 Ces produits font partie d'un système de canapés. Ils sont disponibles dans d'autres configurations.
 Questi prodotti fanno parte di un sistema di divani. Sono disponibili altre configurazioni.
 Diese Produkte sind ein Teil des Systems der Sofakollektion. Mehr Konfigurationen sind erhältlich.

Avio Sofa System

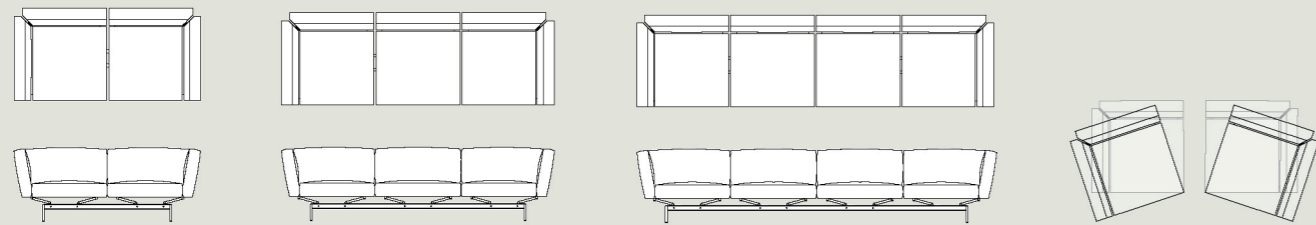

2 Seater Sofa
L 184 x D 93 x H 72 cm

3 Seater Sofa
L 271 x D 93 x H 72 cm

4 Seater Sofa
L 358 x D 93 x H 72 cm

***Optional Rotating end Mechanism**
Right and left

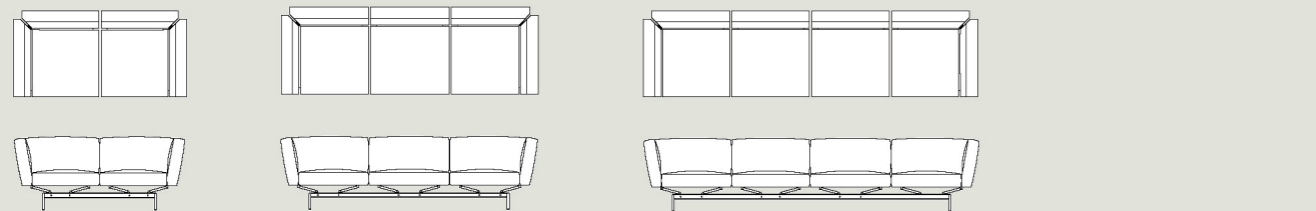

2 Seater Sofa - Compact
L 170 x D 85 x H 72 cm

3 Seater Sofa - Compact
L 247 x D 85 x H 72 cm

4 Seater Sofa - Compact
L 324 x D 85 x H 72 cm

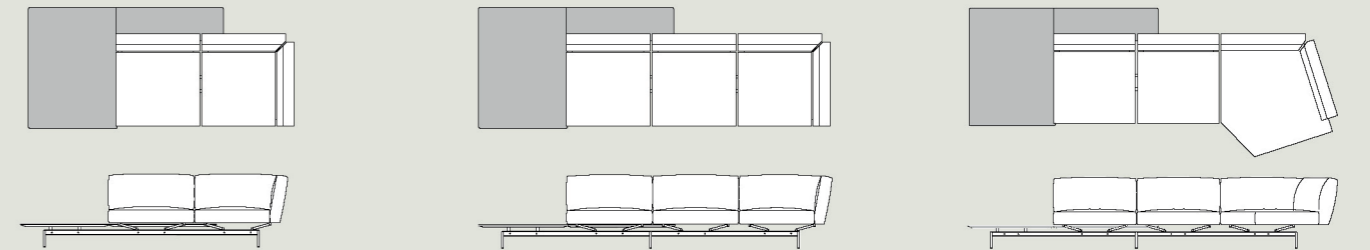

2 Seater Sofa + Left or righthand L-shaped table
L 265 x D 121 x H 72 cm

3 Seater Sofa + Left or righthand L-shaped table
L 352 x D 121 x H 72 cm

3 Seater Sofa + Left or righthand L-shaped table
L 377 x D 146 x H 72 cm

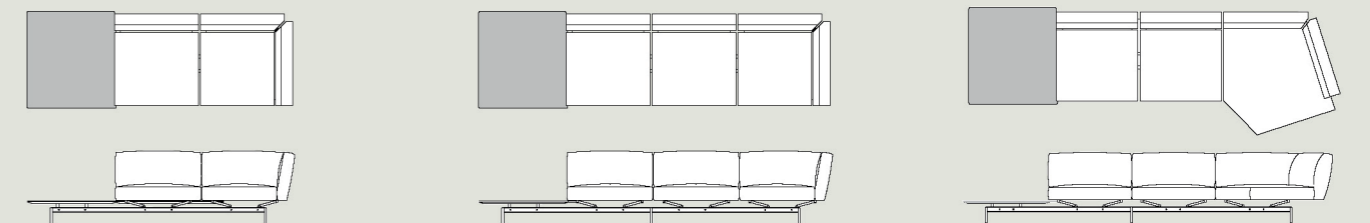

2 Seater Sofa + Left or righthand table
L 265 x D 93 x H 72 cm

3 Seater Sofa + Left or righthand table
L 352 x D 93 x H 72 cm

3 Seater Sofa + Left or righthand L-shaped table
L 377 x D 128 x H 72 cm

Avio Sofa System

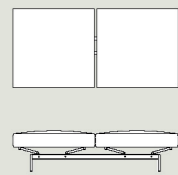

2 Seater Bench
L 172 x D 87 x H 44 cm
2 Seater Bench - Compact
L 156 x D 79 x H 44 cm

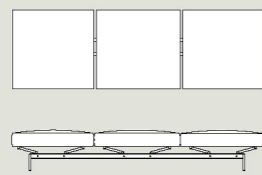

3 Seater Bench
L 257 x D 87 x H 44 cm
3 Seater Bench - Compact
L 233 x D 79 x H 44 cm

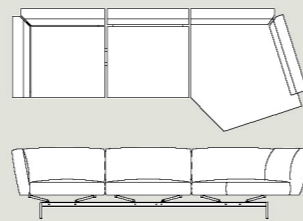

3 Seater Sofa
L 265 x D 93 x H 72 cm

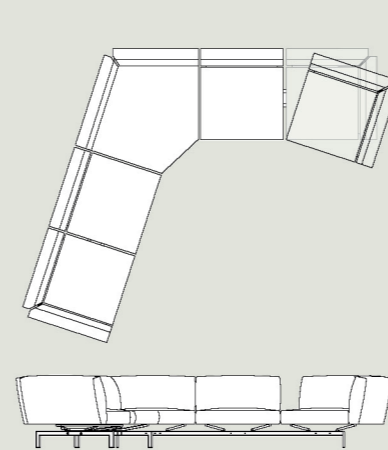

5 Seater Sofa with rotating end mechanism
L 356 x D 297 x H 72 cm

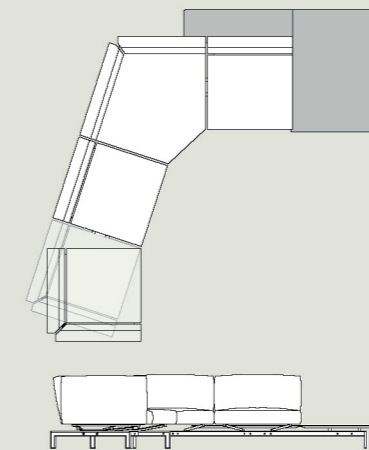

4 Seater Sofa + Right or lefthand L-shaped table and rotating end mechanism
L 314 x D 294 x H 72 cm

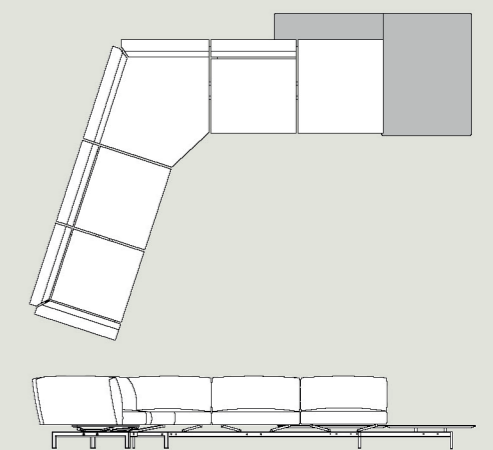

5 Seater Sofa + Right or lefthand L-shaped table
L 380 x D 350 x H 72 cm

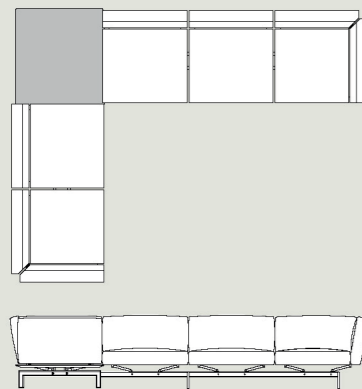

5 Seater Sofa + Left or righthand Corner table
L 358 x D 271 x H 72 cm

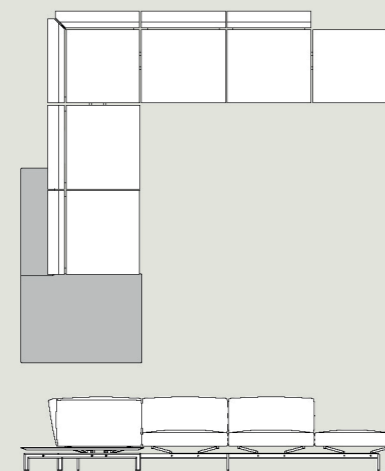

5 Seater Sofa + Ottoman + Left or righthand L-shaped table
L 380 x D 350 x H 72 cm

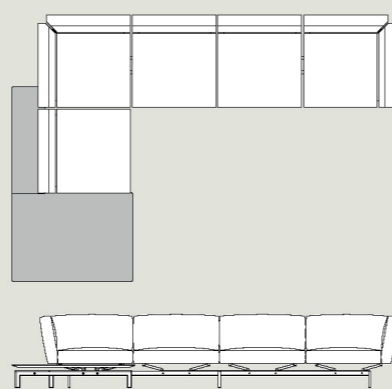

5 Seater Sofa + Left or righthand L-shaped table
L 386 x D 265 x H 72 cm

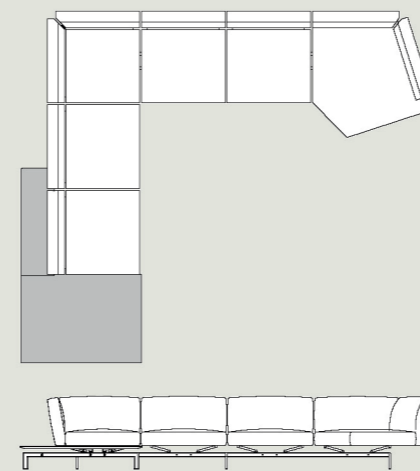

6 Seater Sofa + Left or righthand L-shaped table
L 407 x D 350 x H 72 cm

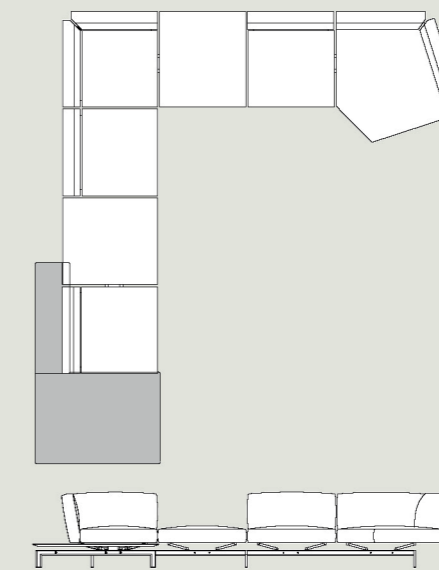

7 Seater Sofa + Left or righthand L-shaped table
L 380 x D 350 x H 72 cm

Grasshopper Table



L 300 x D 120 x H 71 cm

L 270 x D 110 x H 71 cm

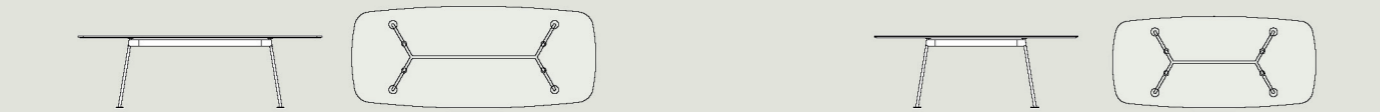

L 240 x D 100 x H 71 cm

L 200 x D 90 x H 71 cm

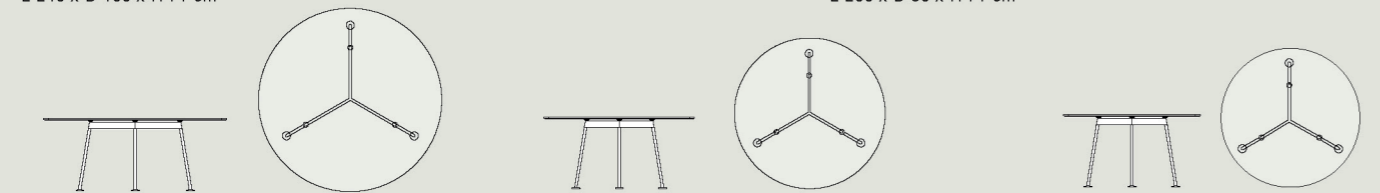

Ø 180 x H 71 cm

Ø 152 x H 71 cm

Ø 137 x H 71 cm

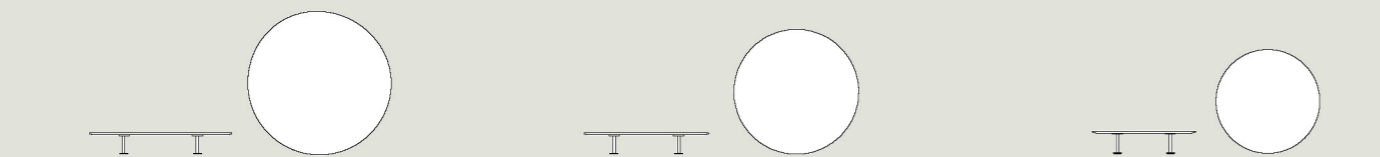

Ø 137 x H 20 cm

Ø 120 x H 20 cm

Ø 100 x H 20 cm

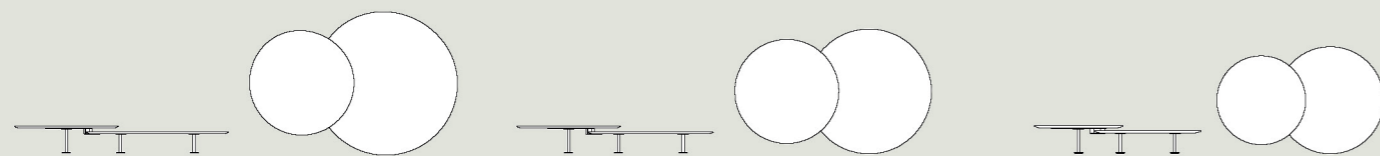

Ø 120/100 x H 20/25 cm

Ø 137/100 x H 20/25 cm

Ø 137/120 x H 20/25 cm

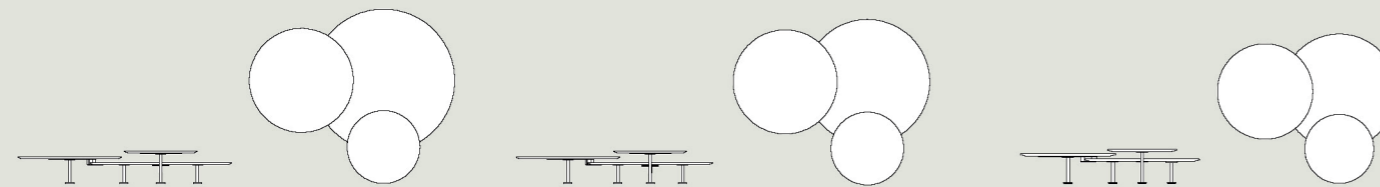

Ø 120/100/70 x H 20/25/30 cm

Ø 137/100/70 x H 20/25/30 cm

Ø 137/120/70 x H 20/25/30 cm

Matrioska



1 module

L 100 x D 45 x H 69 cm

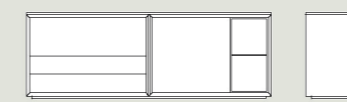

2 module

L 200 x D 45 x H 69 cm

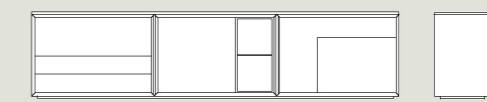

3 module

L 300 x D 45 x H 69 cm

Saarinen Collection



Oval Dining Table

L 198 x D 121 x H 73 cm - L 244 x D 137 x H 73 cm

Oval Low Table

L 57 x D 38 x H 51 cm

Oval Low Table

L 107 x D 70 x H 38 cm



Round Dining Table

Ø 91/107/120/137/152 x H 72 cm

Round Low Table

Ø 91 x H 38 cm

Round Low Table

Ø 107 x H 38 cm



Round Low Table

Ø 51 x H 36 cm

Round Low Table

Ø 51 x H 51 cm

Round Low Table

Ø 41 x H 51 cm

Florence Knoll Collection

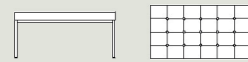

2 Seat Bench
L 92 x D 50 x H 42 cm



3 Seat Bench
L 154 x D 50 x H 42 cm



2 Seat Bench - Relax
L 96 x D 48 x H 42 cm



3 Seat Bench - Relax
L 144 x D 48 x H 42 cm

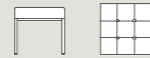

Stool - Relax
L 48 x D 48 x H 42 cm

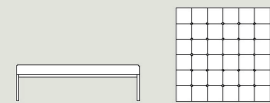

Square Bench - Relax
L 96 x D 96 x H 35 cm

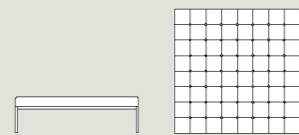

Square Bench - Relax
L 128 x D 128 x H 35 cm

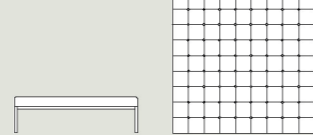

Square Bench - Relax
L 144 x D 144 x H 35 cm

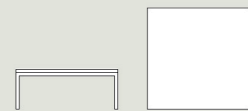

Square Table
L 60/75/90/120/140
x D 60/75/90/120/140 x H 35 cm



Square Table
L 60 x D 60 x H 43 cm



Square Table
L 75/90 x D 75/90 x H 48 cm

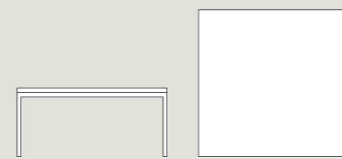

Square Table
L 140 x D 140 x H 72 cm



Rectangular Table
L 114 x D 57 x H 35 cm



Rectangular Table
L 114 x D 57 x H 43 cm



Rectangular Table
L 122 x D 66 x H 72 cm



Rectangular Table
L 200/240 x D 90/100 x H 72 cm

Saarin Collection



Tulip Armchair
L 68 x D 59 x H 81 cm



Tulip Stool
Ø 40 x H 45 cm



Tulip Chair
L 49 x D 53 x H 81 cm

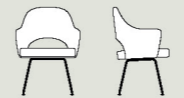

Conference Armchair
L 65.5 x D 63 x H 82.5 cm



Conference Chair
L 57 x D 51.5 x H 79 cm

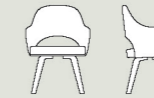

Conference Armchair
L 65.5 x D 63 x H 81.5 cm



Conference Chair
L 57 x D 51.5 x H 80 cm



Conference Armchair - Swivel
L 66.5 x D 64 x H 80/93 cm



Conference Chair - Swivel
L 62 x D 62 x H 76/89 cm



Womb Chair
L 105 x D 94 x H 92 cm



Ottoman
L 64 x D 51.5 x H 40 cm



Womb Chair Medium
L 89 x D 79 x H 79 cm



Ottoman Medium
L 53 x D 44 x H 35 cm

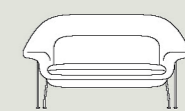

Womb Settee
L 159 x D 94 x H 92 cm



Womb Chair - Relax
L 105 x D 94 x H 92 cm



Ottoman - Relax
L 64 x D 51.5 x H 40 cm

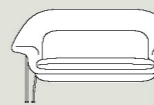

Womb Settee - Relax
L 159 x D 94 x H 92 cm

Bertoia Collection

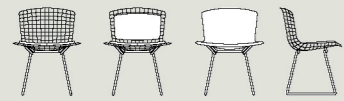

Side chair
L 54 x D 58 x H 73 cm



Side Chair in Plastic
L 52.3 x D 54.6 x H 77 cm



Side Chair in Cowhide
L 54 x D 58 x H 78 cm



Stool
L 54 x D 58 x H 104/100 cm



Stool in Plastic
L 52.3 x D 55.4 x H 107/104

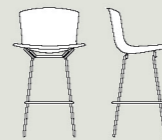

Stool in Cowhide
L 54 x D 58 x H 108/105 cm



Diamond Armchair
L 85/86 x D 75/76 x H 75/76 cm

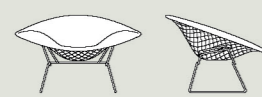

Large Diamond Armchair
L 114 x D 82 x H 71 cm



Bird Armchair
L 98 x D 89 x H 101 cm



Ottoman
L 62 x D 44 x H 39 cm

Krusin Collection 016

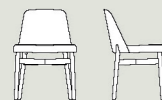

Chair
L 53 x D 53 x H 76 cm

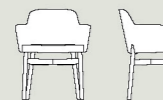

Chair with Arms
L 63 x D 53 x H 76 cm

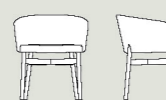

Armchair
L 63 x D 53 x H 71 cm

Mies van der Rohe Collection



MR Armchair in Rattan
L 53 x D 82.5 x H 79 cm



MR Chair in Rattan
L 49 x D 69 x H 79 cm

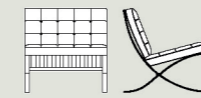

Barcelona® Chair
L 75 x D 77 x H 77 cm



Barcelona® Stool
L 59 x D 59.5 x H 39 cm

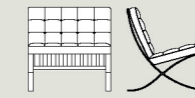

Barcelona® Chair - Relax
L 75 x D 77 x H 77 cm

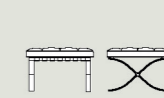

Barcelona® Stool - Relax
L 59 x D 59.5 x H 39 cm

Edward Barber & Jay Osgerby Collection



Pilot Chair - low back
L 60/69 x D 70 x H 81 cm



Pilot Chair - high back
L 60/69 x D 77 x H 100 cm



Piton Stool
Ø 45.7 x H 33.5 cm

Platner Collection



Lounge Chair
L 95 x D 65 x H 77 cm

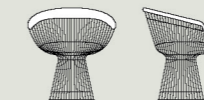

Side Chair
L 73 x D 58 x H 76 cm



Stool
Ø 43.5 x H 54.5 cm

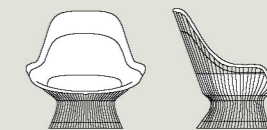

Easy Chair
L 100 x D 95.5 x H 99.5 cm

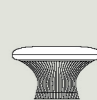

Ottoman
Ø 66.5 x H 41 cm

Benelux

Knoll International S.A./N.V.
Tour & Taxis
Avenue du Port, 86C - b215
Havenlaan, 86C - b215
B - 1000 Bruxelles - Brussel
Belgique - België
Tel: +32 (0) 2 715 13 00
Fax: +32 (0) 2 715 13 07
benelux@knolleurope.com

KnollStudio Customer
Service
Tel: +32 (0) 2 715 13 03
Fax: +32 (0) 2 715 13 07

France

Knoll International SAS
268 Boulevard Saint-Germain
75007 Paris
France
Tel: +33 (0)1 44 18 19 99
Fax: +33 (0)1 44 18 19 93
france@knolleurope.com

KnollStudio Customer
Service
Tel: +33 (0)1 44 18 19 92
Fax: +33 (0)1 44 18 19 93

**Germany, Austria &
Switzerland**

Knoll International GmbH
c/o Via S, Colombano, 67
I-26813 Graffignana-Lodi
Italien
Tel: +39 0371 2069 262
Fax: +39 0371 2069 263
germany@knolleurope.com

KnollStudio Customer
Service
Tel: +39 0371 2069 262
Fax: +39 0371 2069 263

Italy

Knoll International Spa
Piazza Bertarelli 2
20122 Milano
Italia
Tel: +39 02 7222 291
Fax: +39 02 7222 2930
italy@knolleurope.com

KnollStudio Customer
Service Italy
Tel: +39 0371 2069 272
Fax: +39 0371 2069 273

Scandinavia

Knoll International Spa
Piazza Bertarelli 2
20122 Milano
Italia
Tel: +39 0371 2069 270
Fax: +39 0371 2069 263
scandinavia@knolleurope.com

KnollStudio Customer
Service Scandinavia
Tel: +39 0371 2069 270
Fax: +39 0371 2069 263

United Kingdom

Knoll International Ltd
91 Goswell Road
London EC1V 7EX
United Kingdom
Tel: +44 (0) 20 7236 6655
Fax: +44 (0) 20 7248 1744
uk@knolleurope.com

KnollStudio Customer
Service
Tel: +39 0371 2069 266
Fax: +39 0371 2069 261

Spain&Portugal

KnollStudio Customer
Service
Tel: +39 0371 2069 266
Fax: +39 0371 2069 263
spain@knolleurope.com

Knoll International

EMEA
(excluding above mentioned
countries)

Knoll International Ltd
91 Goswell Road
London EC1V 7EX
United Kingdom
Tel: +44 (0) 20 7236 6655
Fax: +44 (0) 20 7248 1744
international@knolleurope.com

KnollStudio Customer
Service
Tel: +39 0371 2069 270
Fax: +39 0371 2069 263

Asia - Pacific

KnollStudio Customer
Service
Tel: +39 0371 2069 270
Fax: +39 0371 2069 263
asia@knolleurope.com

USA

Knoll Inc.
1330 Avenue of the
Americas
New York
NY 10019
U.S.A.
Tel: +1 212 343 40 00
Fax: +1 212 343 41 80

Latin America

Knoll Inc.
Ste. 1111
Merchandising Mart Plaza
Chicago, IL 60654
U.S.A.
Tel: +1 312 454 7010
Fax: +1 312 454 7007

Graphic design

Designwork

Photography

Federico Cedrone

Styling

Vandersandestudio

Thanks to

Altai
Amini
Amleto Missaglia
Astep
Atelier Areti
Bergomi Interiors
Books Import
Cham Ceramica
Dimore Collection
Edizioni Design
Eligo
Gorlan
Loro Piana
Officine Saffi
Flos
Kose Milano
Mani Ceramics
Marco Guazzini
Mingardo
Paola Paronetto
Pescetta antichità
Roll&Hill
Society
The Rug Company

Post production

Studio Azimut

Colour separation

Lucegroup

Set in Helvetica Neue 45/75
and Sh Bodoni

Printed in Italy by Grafiche GFP

October 2017

www.knolleurope.com

