

# BuzziShade Square Beam

INSTALLATION MANUAL

220-240V

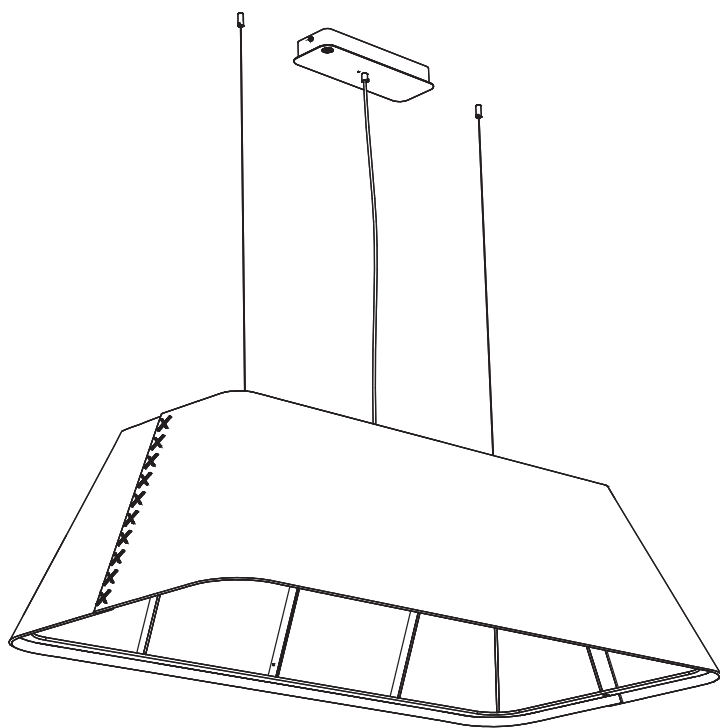

## Technical info

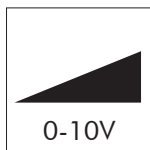
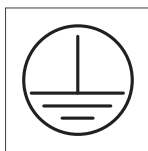
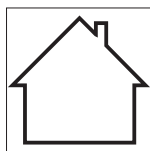

Power factor > 0.8;  
Input current: Max 0.35Amp

## Environmental Protection

Waste electrical products should not be disposed of with household waste. Please recycle where facilities exist. Check with your Local Authority or retailer for recycling advice.

**⚠** The light source of this luminaire is not replaceable; when the light source reaches its end of life the whole luminaire shall be replaced.

**⚠** The BuzziSol is approved to be combined with BuzziShade, BuzziPleat.

**⚠** The control terminals of LED driver need to use SELV control signal.

**⚠** If the external flexible cable or cord of this luminaire is damaged, it shall be exclusively replaced by the manufacturer or his service agent or a similar qualified person in order to avoid a hazard."

## Excluded

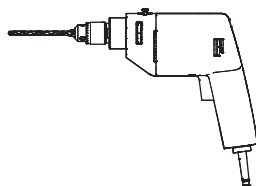
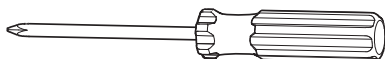
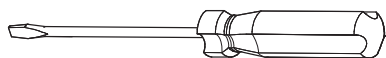

**Included BuzziShade Square Beam Globe | Spot**

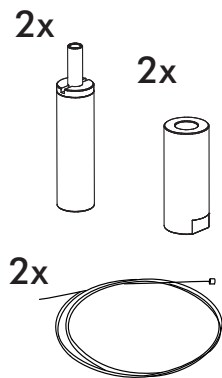
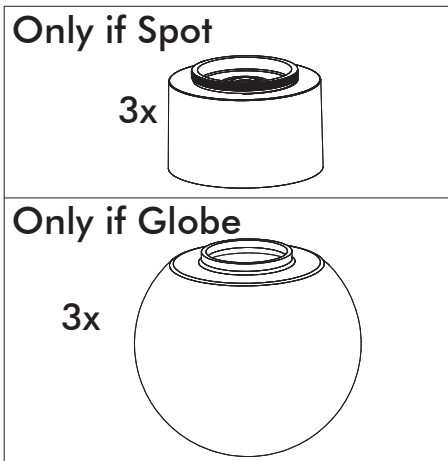
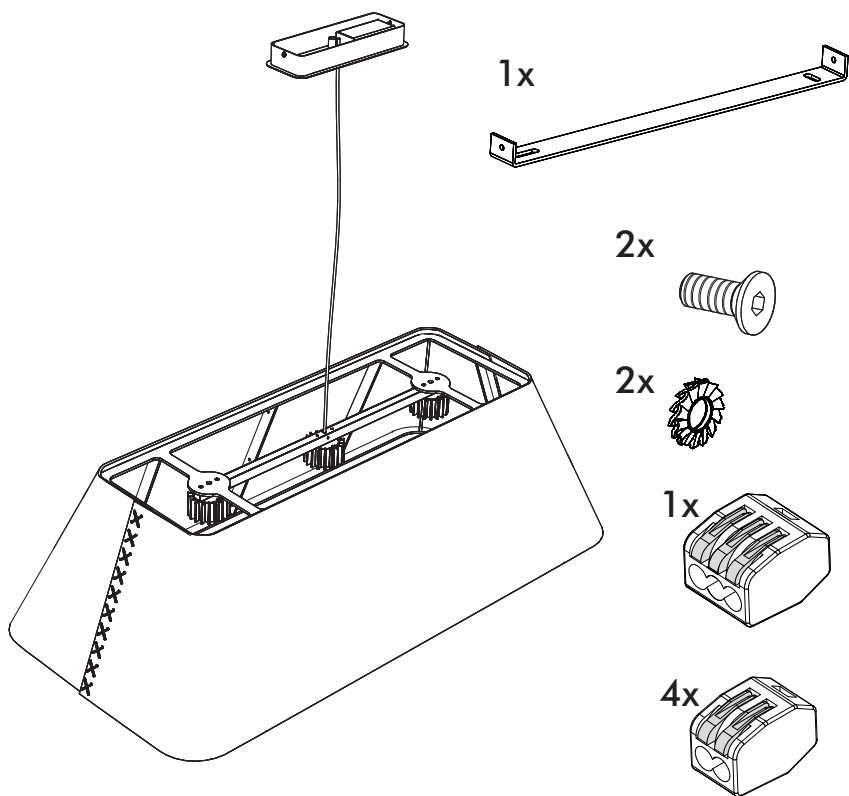

## **Configuration Type A**

---

**P.5**

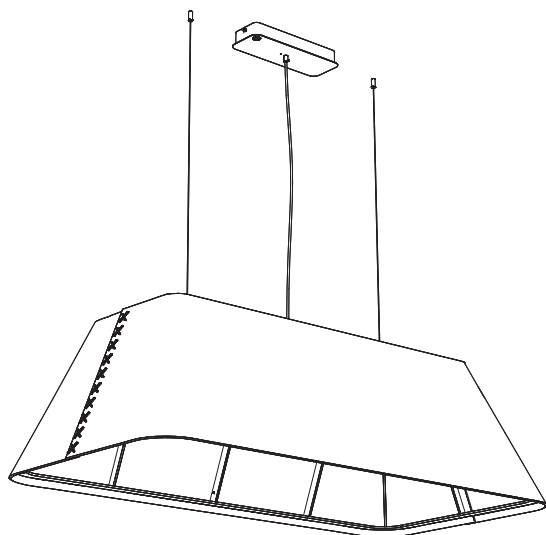

## **Configuration Type B**

---

**P.14**

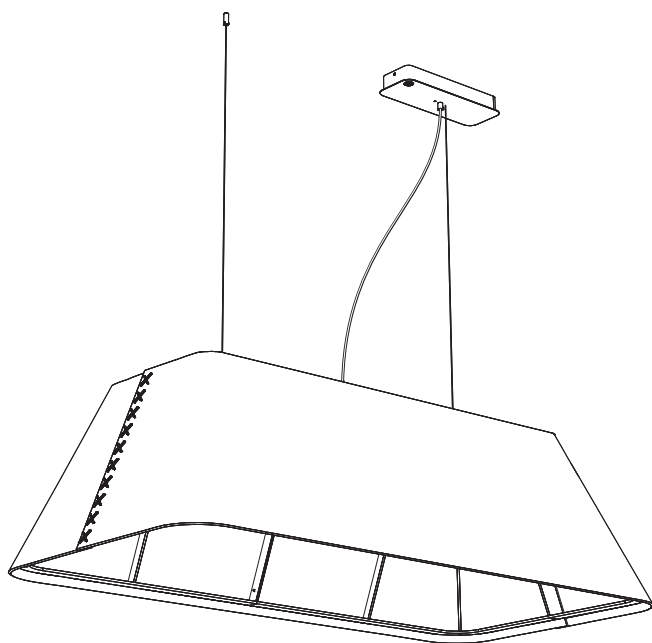

# BuzziShade Square Beam Type A

2 PERS. 

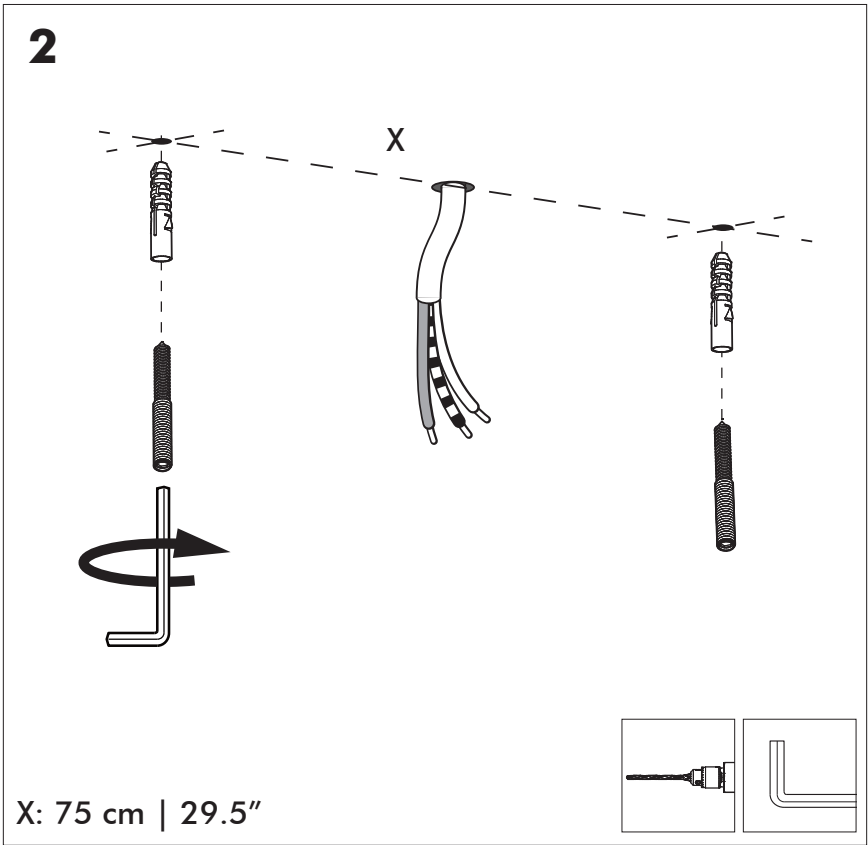
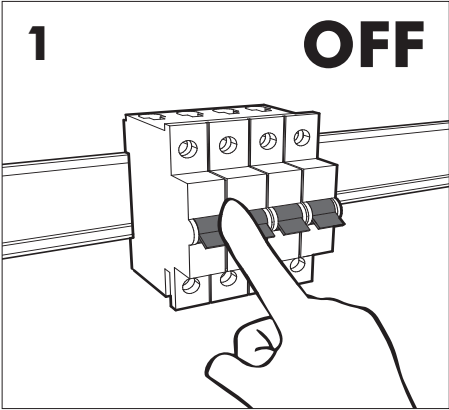

**3**

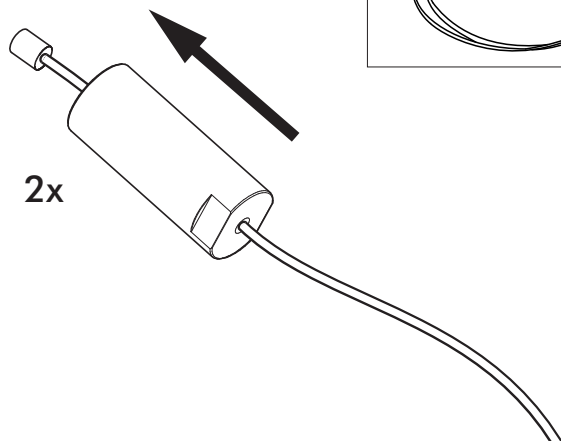

**4**

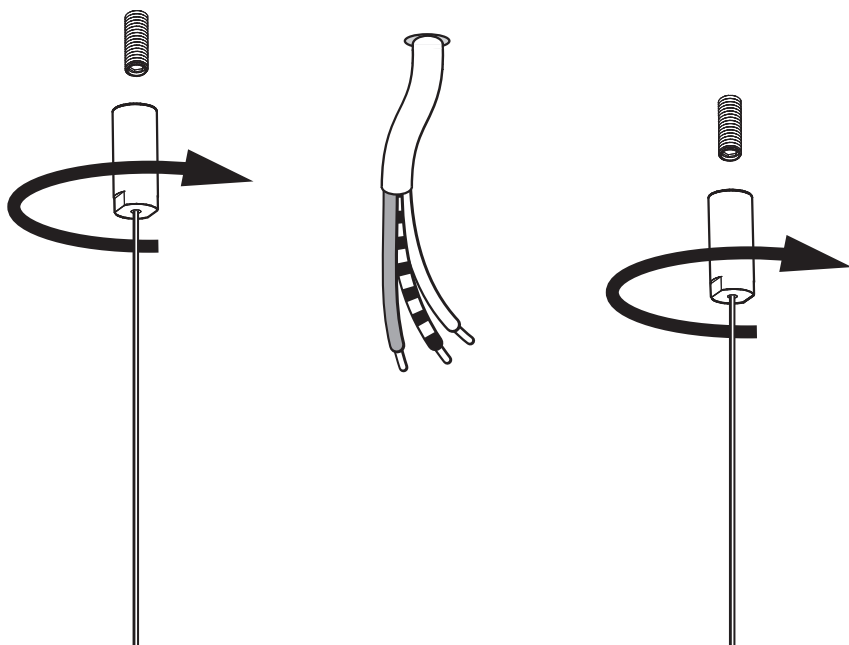

5

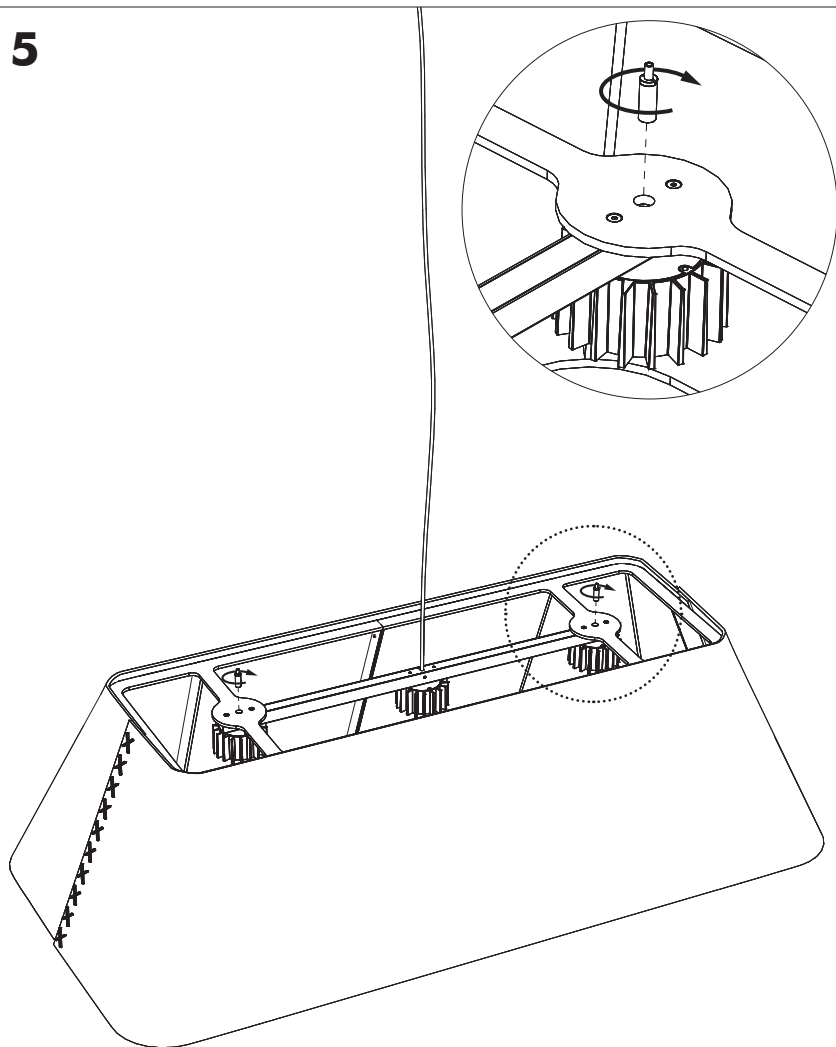

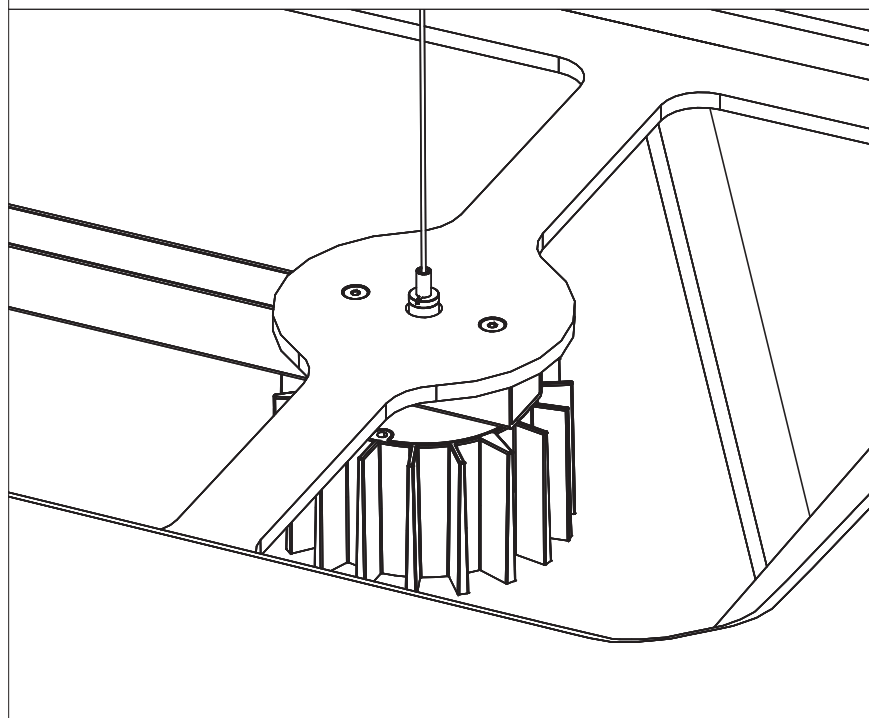
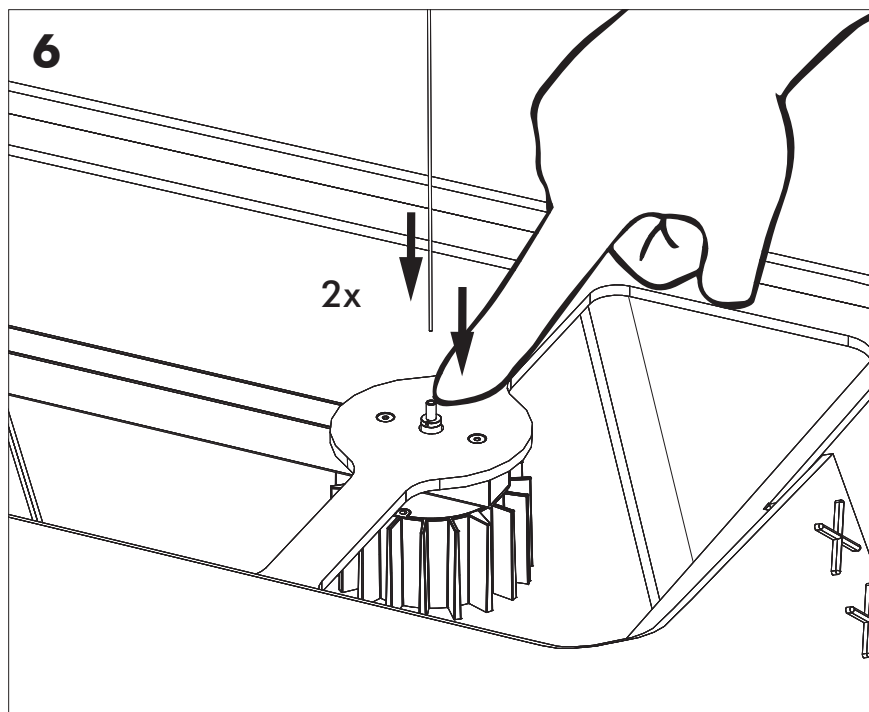



# 7a

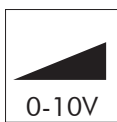

Connection including dimmable function



Dim+

Dim-

Blue	Neutral
Brown	Line
Red	DIM +
Black	DIM -

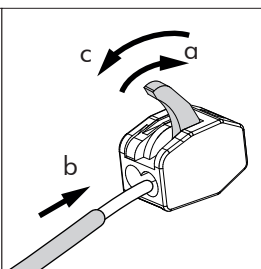
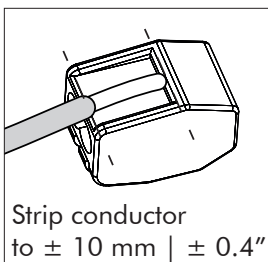

**7b**

Connection excluding dimmable function

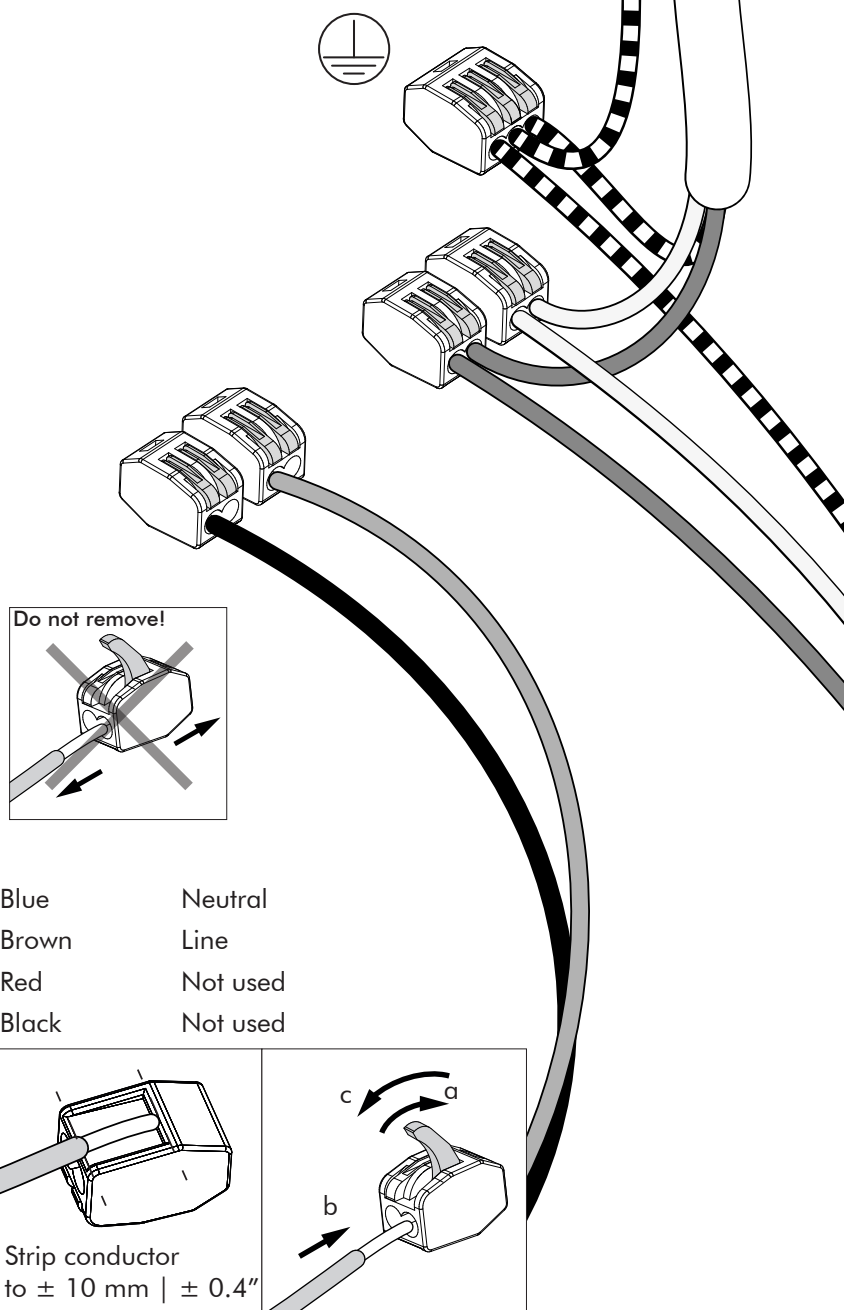

8

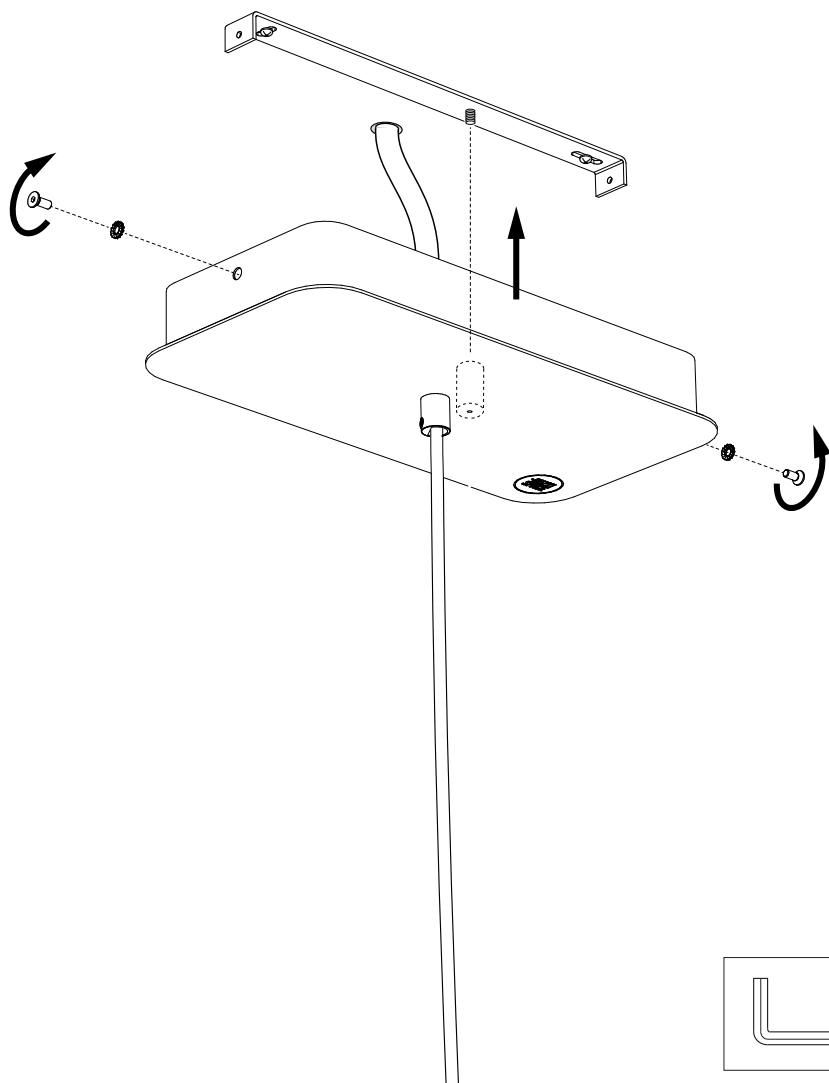

## 9 BuzziShade Square Globe

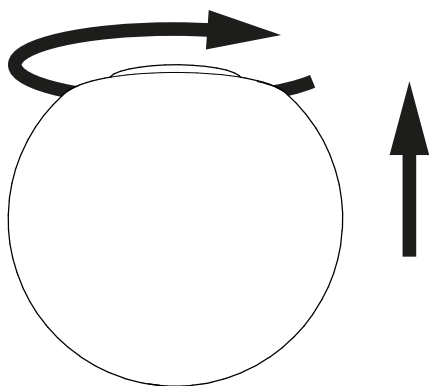
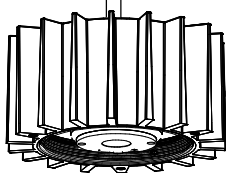

## 9 BuzziShade Square Spot

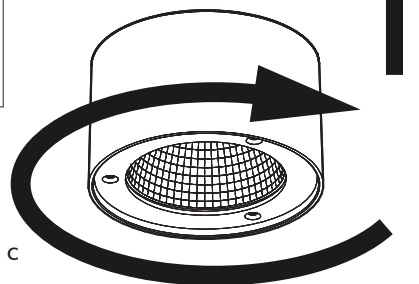
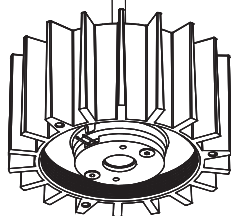
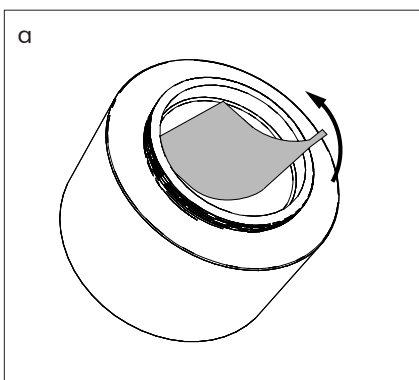

!

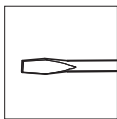
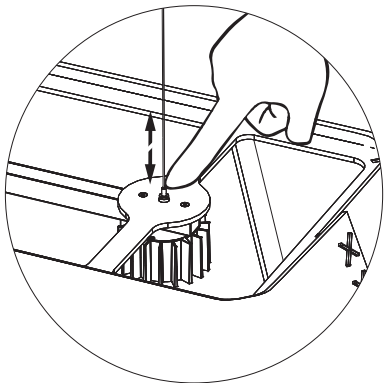
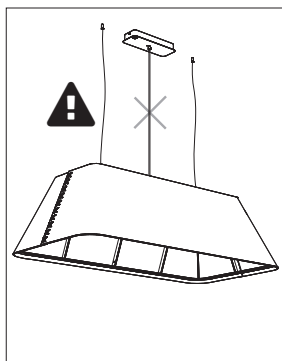
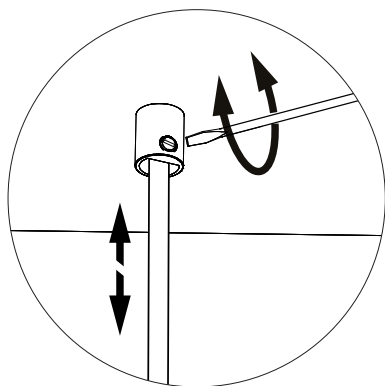
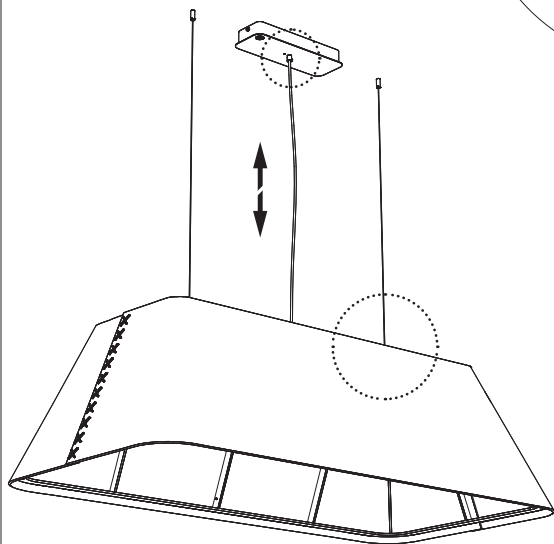

# BuzziShade Square Beam Type B

2 PERS. 

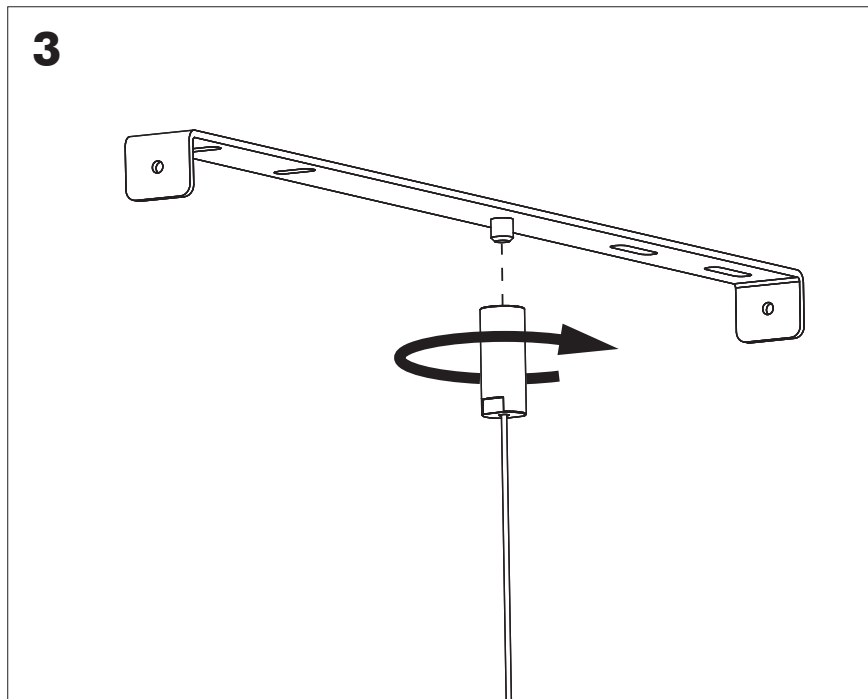
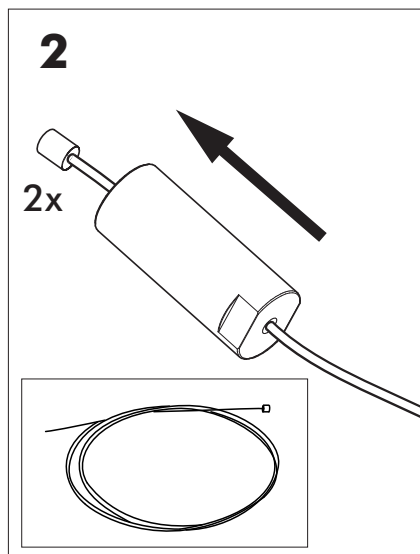
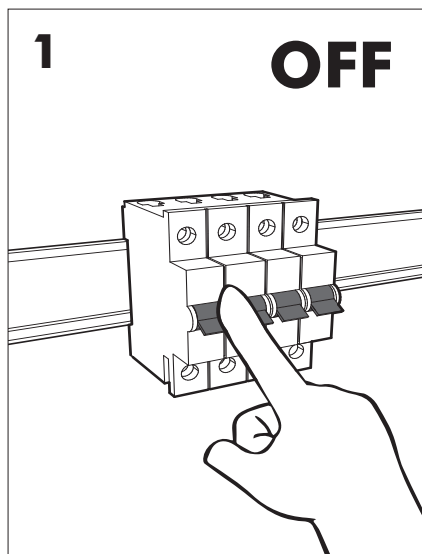

**4**

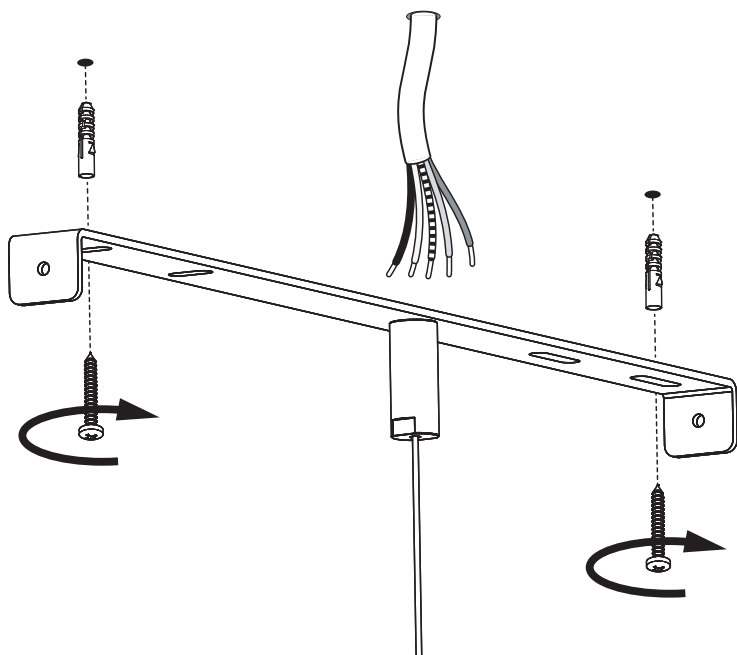

**5**

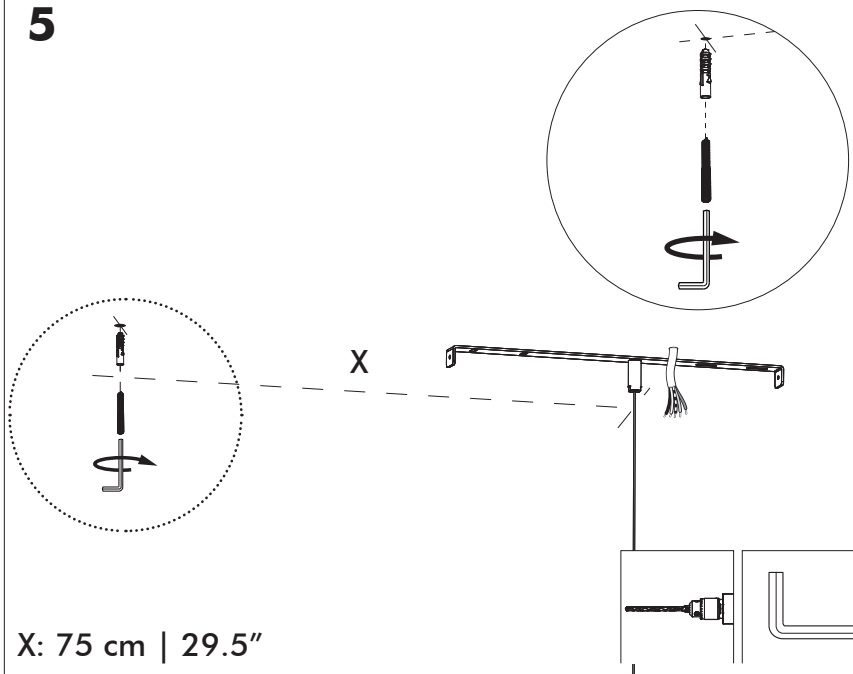

6

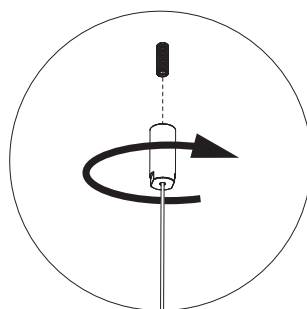
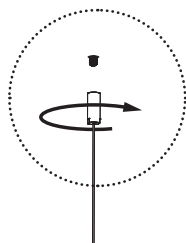

7

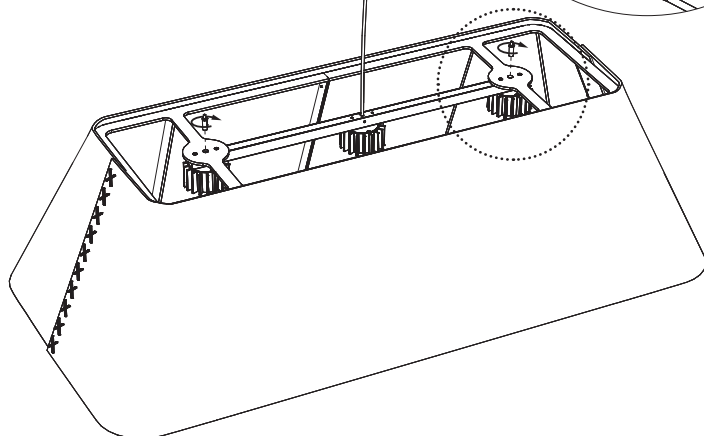
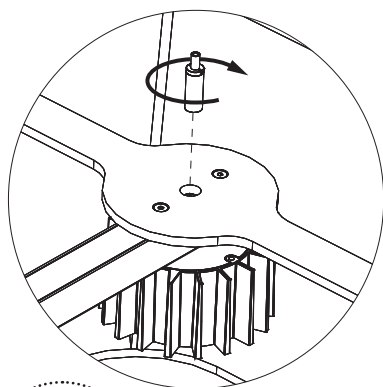



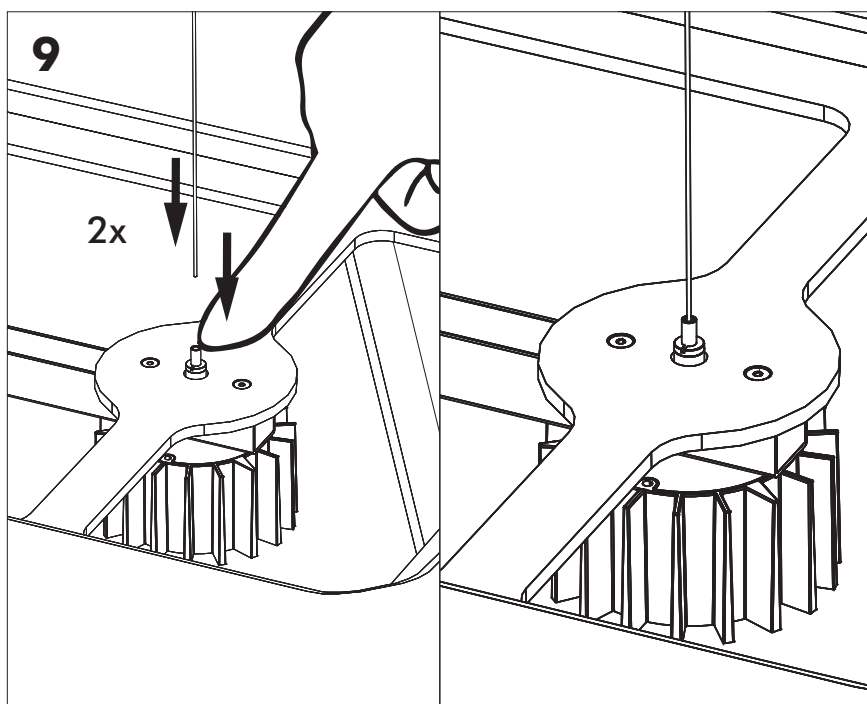
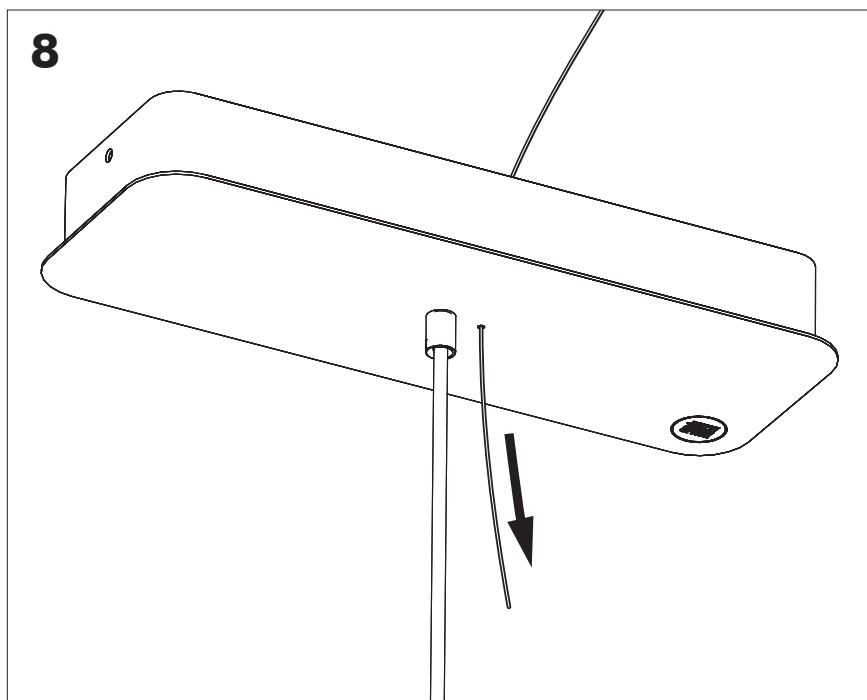

# 10a

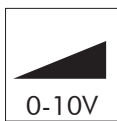

0-10V



DALI



DMX



DST

Connection including dimmable function



0-10V

Dim+

Dim-

Blue	Neutral
Brown	Line
Red	DIM +
Black	DIM -

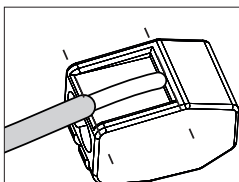

Strip conductor  
to  $\pm 10 \text{ mm}$  |  $\pm 0.4''$

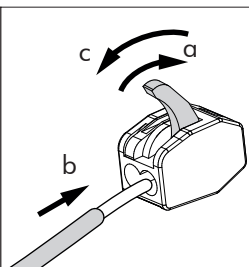

## 10b Connection excluding dimmable function

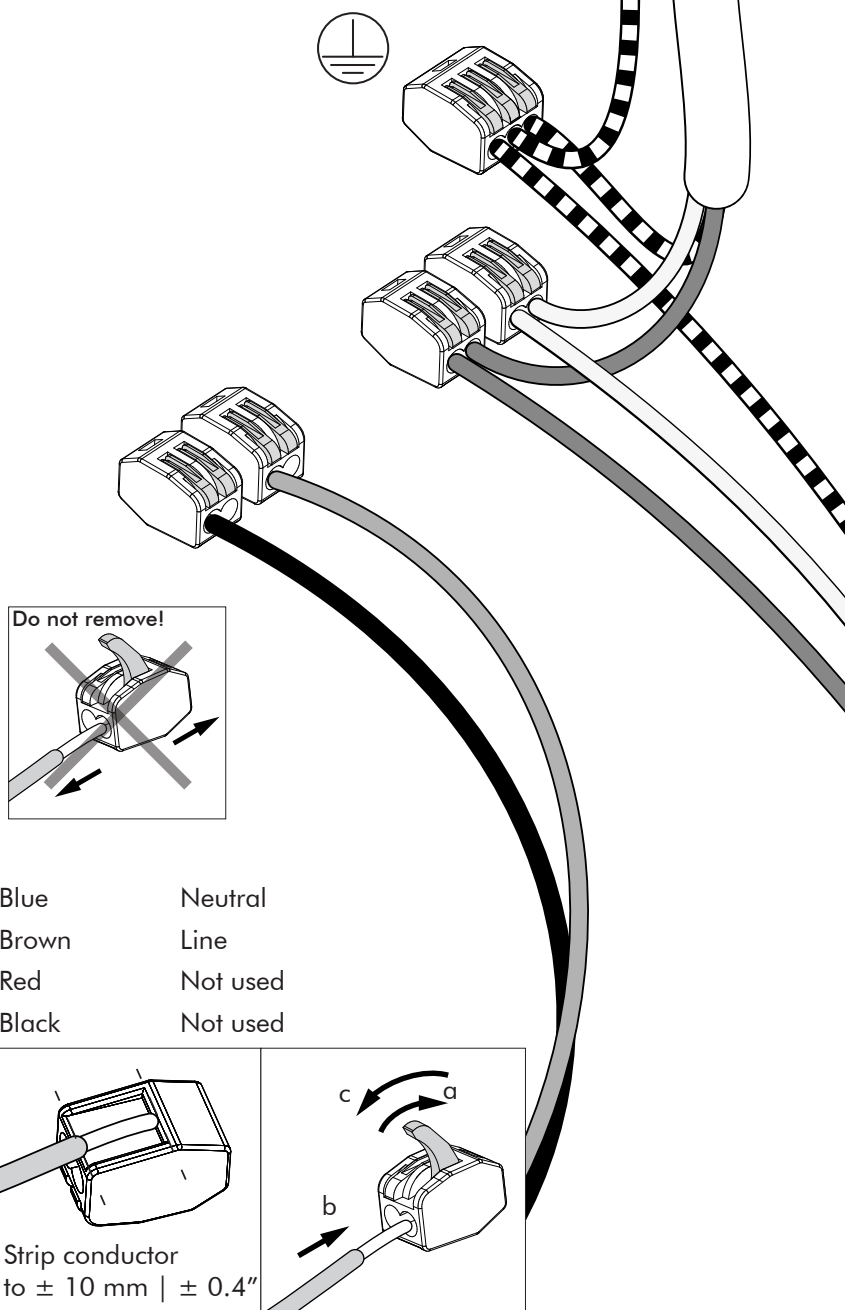

11

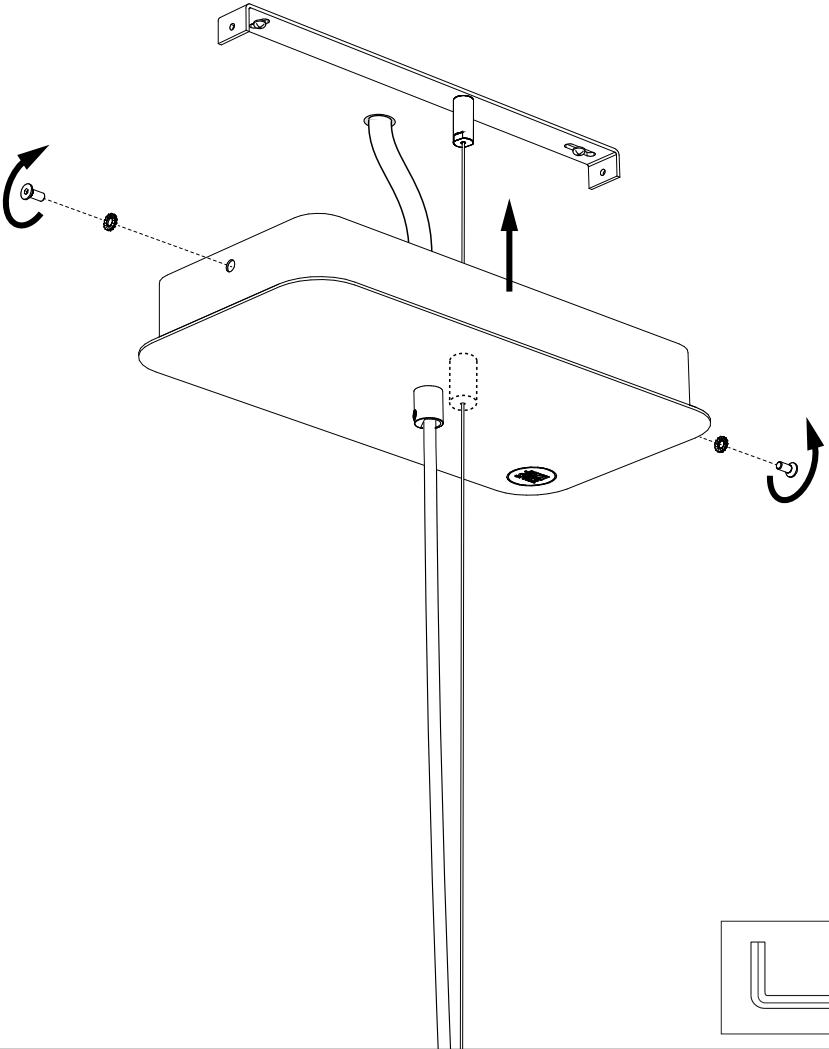

# 12 BuzziShade Square Beam Globe

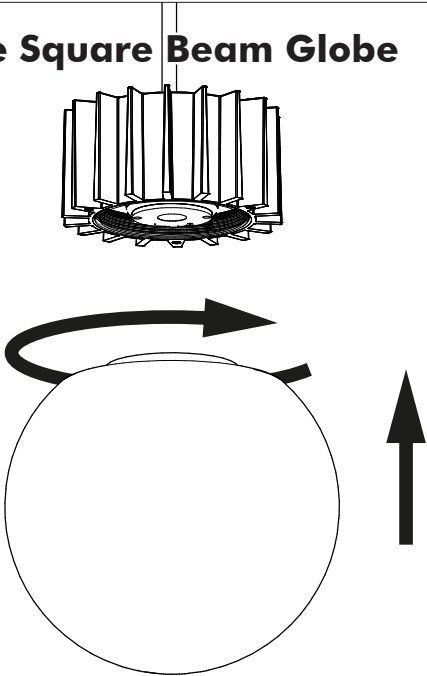

# 12 BuzziShade Square Beam Spot

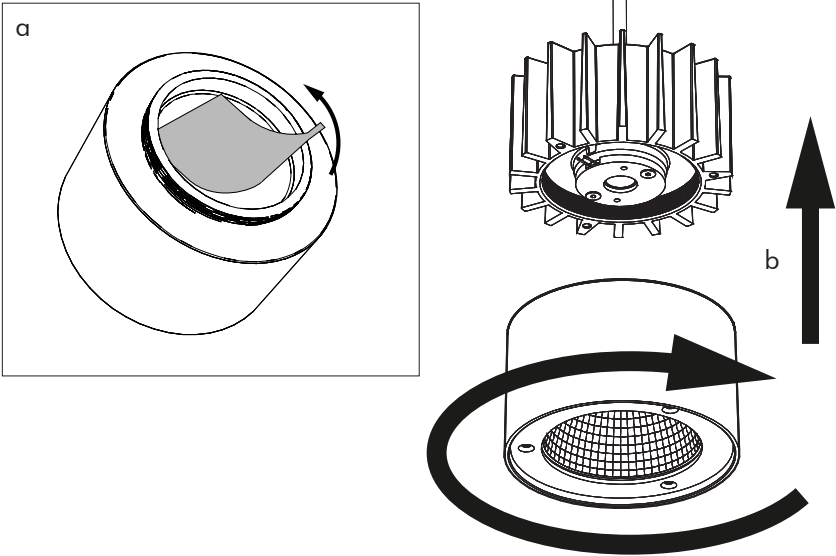

!

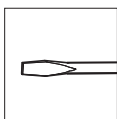
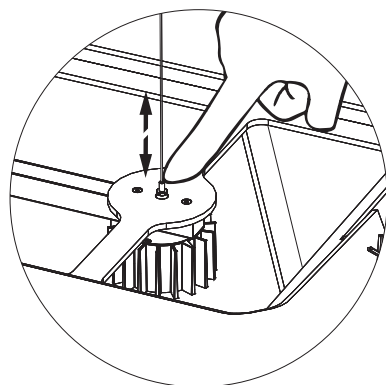
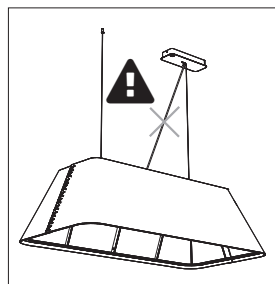
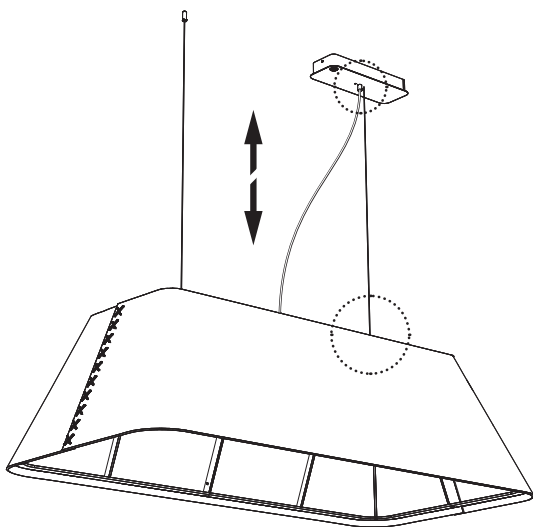
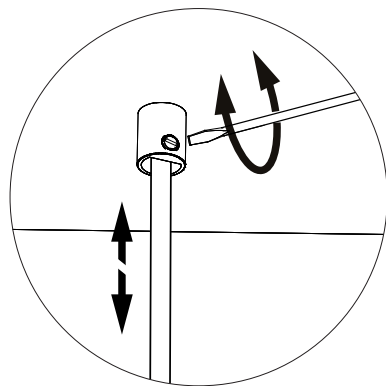



BuzziSpace  
Groeningenlei 141  
2550 Antwerp, Kontich  
Belgium  
☎ +32 (0)3 846 10 00  
✉ info@buzzi.space  
🌐 www.buzzi.space



A-0000007365  
Last update: 07/06/21