



TECHNICAL SPECIFICATION SHEET

PRODUCT NAME: Flo X Triple Mount Kit

PRODUCT CODE: FLX/018/TM1

Doc Rev 3.

23.01.2024 JJ

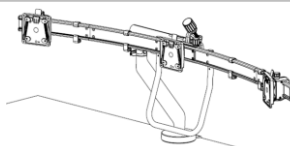
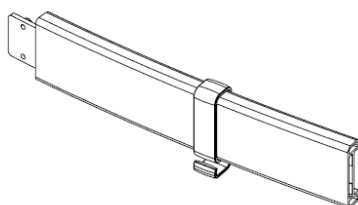
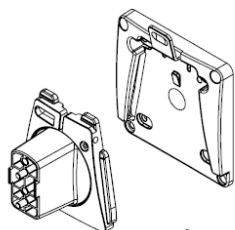
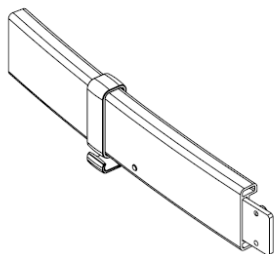

Triple screen configuration shown comprises:
Flo X Triple Mount Kit (FLX/018/TM1)
Flo X Dual Mount Bar (FLX/018/DM1)
Flo X Multi Mount Handle (FLX/018/HA1)
Flo X Multi Mount Arm (FLX/018/012)
Flo X Desk Clamp

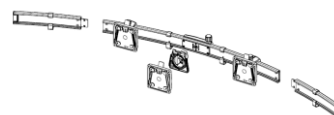

Kit is installed to Flo X Dual Mount Bar (FLX/018/DM1) to expand to triple-screen capability

IMPORTANT NOTE

To ensure optimised adjustability, it is highly recommended that Flo X Multi Mount Handle (FLX/018/HA1) be used with all Flo X dual and triple screen installations.

KEY FEATURES

- Designed to expand Flo X Dual Mount Bar (FLX/018/DM1) to triple-screen capability
- Can support 3 x screens up to circa 27" diagonal (aspect ratio 16:9 or 16:10)
- Side-to-side screen position adjustment on bar with convenient quick-release locking
- Individual fine height adjustment accurately aligns adjacent screens
- Side-to-side swivel of outer screens permits 'cockpit' screen configurations
- Continuous curvature alignment of curved screens up to 1800R and above
- Screen levelling feature permits accurate levelling of complete bar/monitor installation
- Complete bar/monitor installation can be tilted via the hand-operated tilt mechanism on the Flo X Multi Mount Arm
- Centre pieces have two height mounting options to accommodate larger discrepancies in height adjustment of the screens
- Fine angular vertical alignment feature for the centre screen
- Integrated cable management features.
- Landscape-to-portrait screen adjustment

Load support range:

3 x monitors of 2kg to 5kg each*
(Monitors below 2kg arm should be configured to single-spring mode)*

Mounted screen size:

3 x 27" diagonal max
(Aspect Ratio: 16:9 or 16:10)

Horizontal reach:

789mm max
(when installed to Flo X Multi Mount Arm with Dual Mount Bar)

Vertical reach:

529mm max
(when installed to Flo X Multi Mount Arm with Dual Mount Bar)

Vertical motion range:

328mm dynamic motion
(when installed to Flo X Multi Mount Arm with Dual Mount Bar)

Tilt range:

20° upwards, 5° downwards
(when installed to Flo X Multi Mount Arm with Dual Mount Bar)

VESA compatibility:

VESA 100 & VESA 75

Curvature Range 1800R and above

FLAT

4000R

3000R

1800R

Note: Specified screen weights account for the additional weight of the Triple Mount Bar assembly to maintain the total mounted weight within the load limit of the Flo X monitor arm.



colebrook bosson saunders

Maximum Reach & Height Adjustment Range

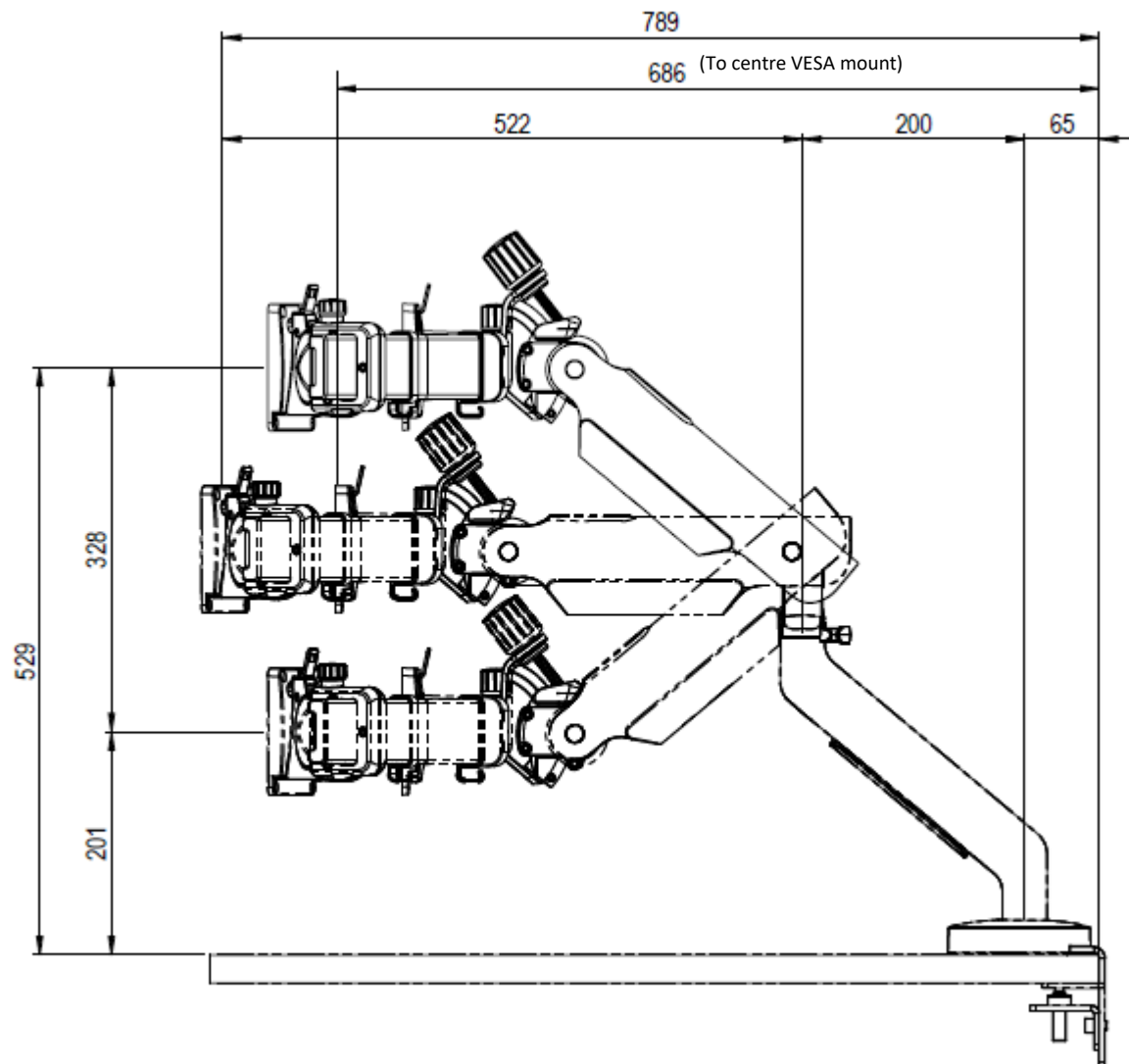
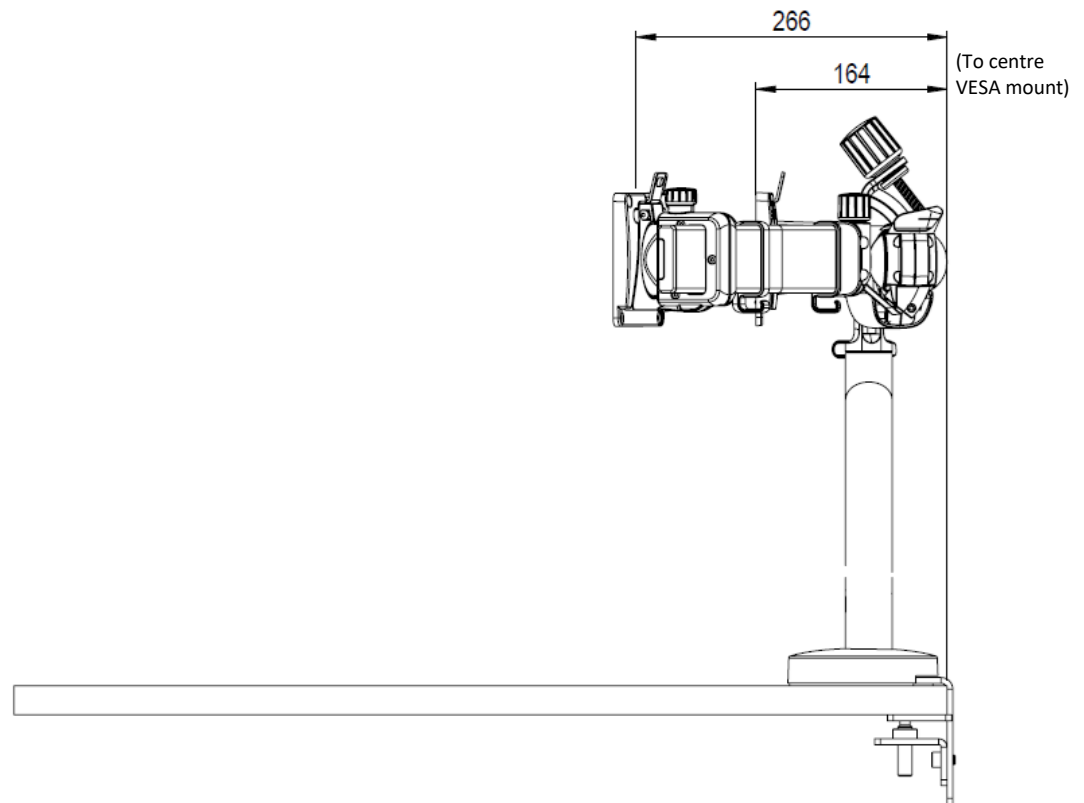
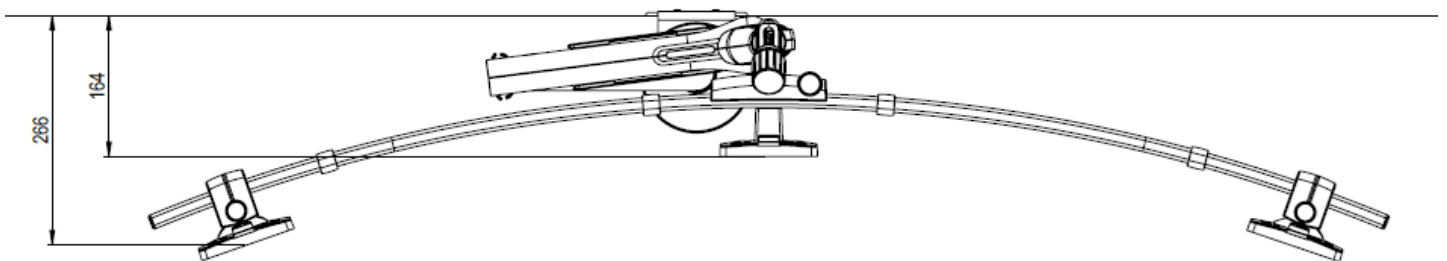

Illustration shows Triple Mount Kit installed onto Flo X Multi Mount Arm (FLX/018/012) with Dual Mount Bar (FLX/018/DM1)
All dimensions are in mm.

Minimum Reach Dimension



Top View



Side-to-Side Mount Adjustment Range

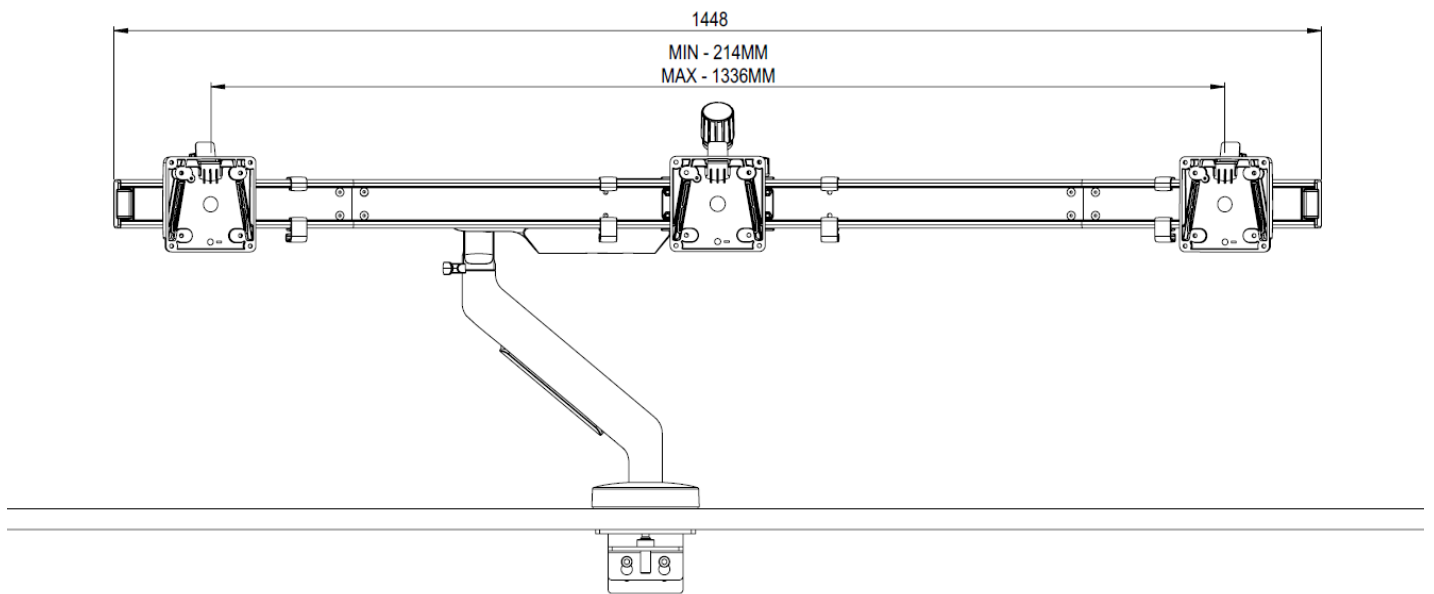

Mount Bar Tilt Range

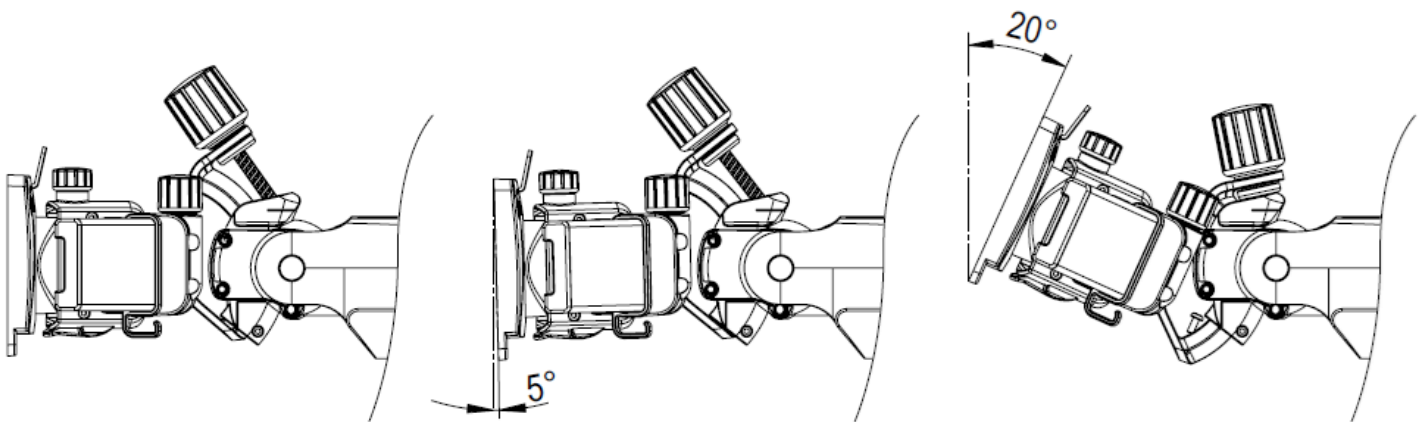

LOGISTICAL

Box contains:	Mount bar extensions x 2, central mount adaptor, VESA plate (incl fixing screws) and instructions
Product net weight:	0.93kg
Box dims:	75mm x 160mm x 470mm
Box gross weight:	1.1kg
Master carton quantity:	4
Master carton dims:	250mm x 345mm x 490mm
Master carton weight:	4.8kg
Country of origin:	Italy

Note: Some logistical data is estimated and may be subject to future confirmation.

ORDERING INFORMATION

<u>Product Description</u>	<u>Product Code</u>	<u>Colour</u>
Flo X Triple Mount Kit	FLX/018/TM1/B	Black

WARRANTY

Warranty Term	12 years
---------------	----------

COMPLIANCE & SAFETY CERTIFICATION

Whilst no mandatory standards apply to the monitor arm product sector, all Colebrook Bosson Saunders monitor arms have been designed with appropriate articulation features, dimensional range and adjustability to conform to the requirements of BS EN ISO 9241:5 1999 Ergonomic requirements for office work with visual display terminals (VDTs).

While every effort is made to ensure the accuracy of our technical information, Colebrook Bosson Saunders (Products) Ltd accept no liability for the accuracy of the information contained in this document and reserve the right to modify the specifications or data contained herein without prior notification.