

BuzziChip

INSTALLATION MANUAL

220-240V

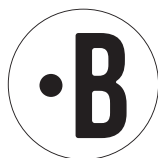
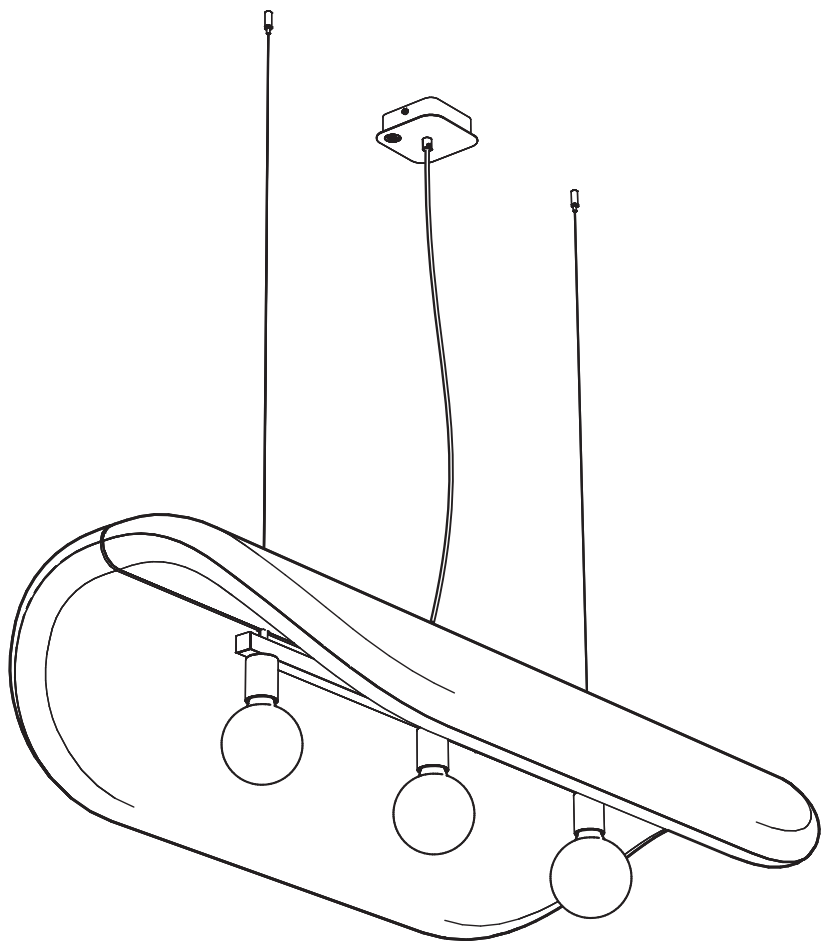

Technical info

E27

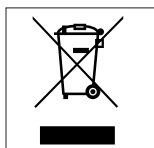
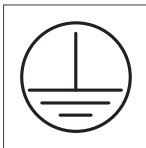
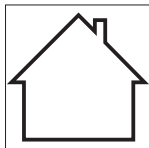
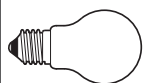

The external flexible cable or cord of this luminaire cannot be replaced; if the cord is damaged, the luminaire shall be destroyed.

Environmental Protection

Waste electrical products should not be disposed of with household waste. Please recycle where facilities exist. Check with your Local Authority or retailer for recycling advice.

Excluded

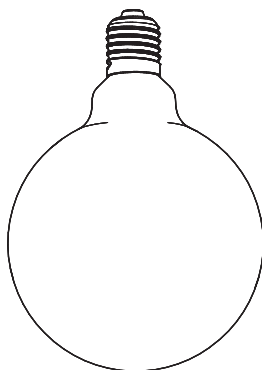
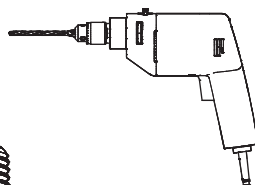
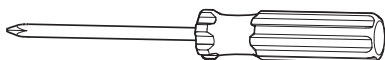

Included BuzziChip Small Retrofit

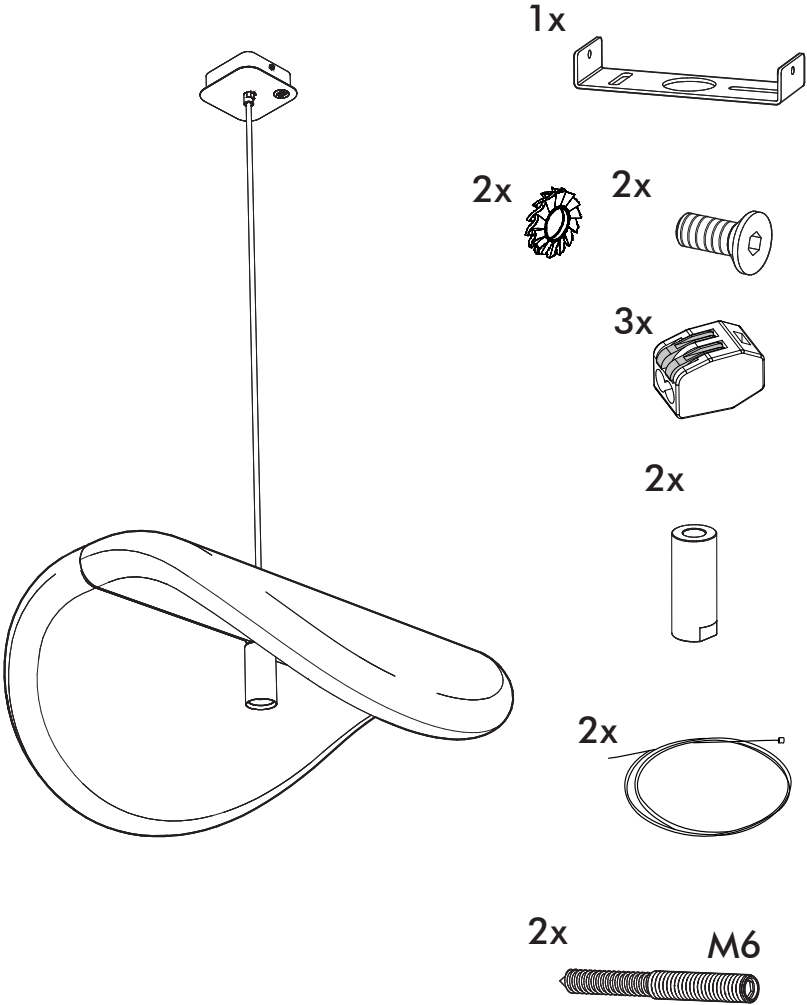

Included BuzziChip Medium Retrofit

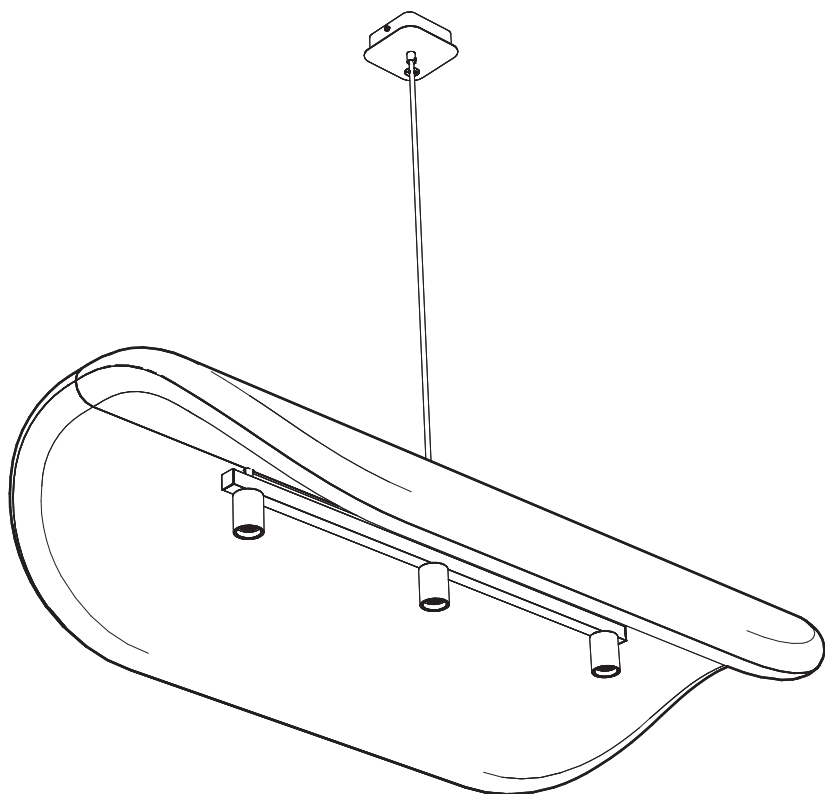

1x



3x



2x



2x



2x



2x

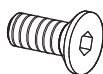

2x



M6

Included BuzziChip Large Retrofit

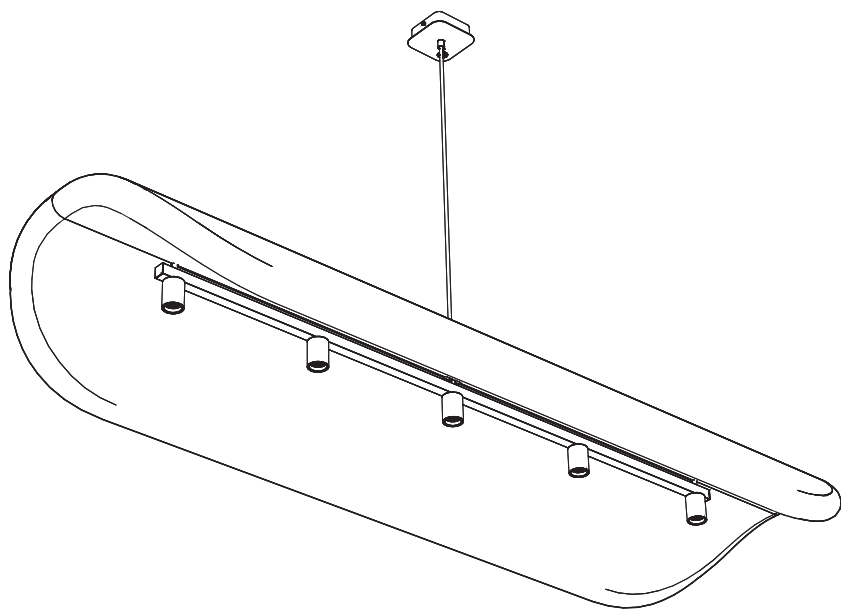

1x



3x

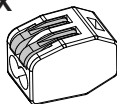

2x



2x



2x

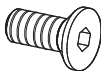

2x



2x



M6

BuzziChip Small | Medium | Large

2 PERS. 

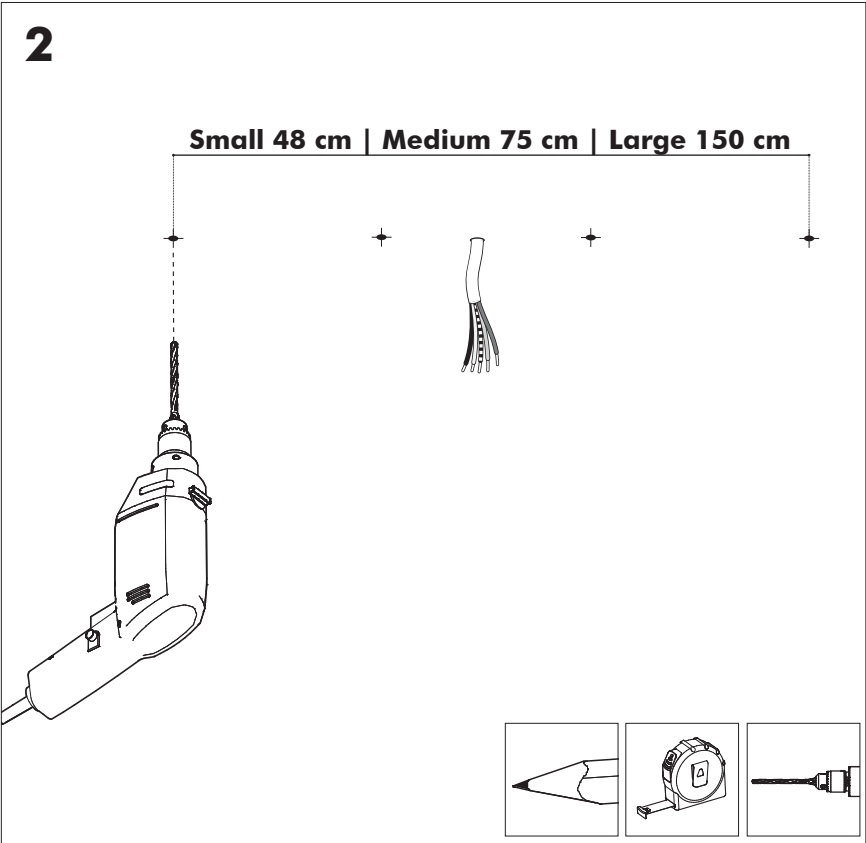
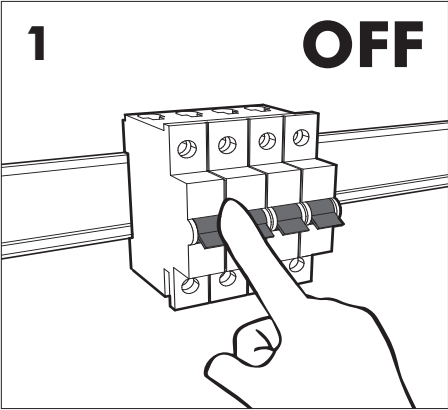

3

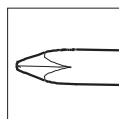
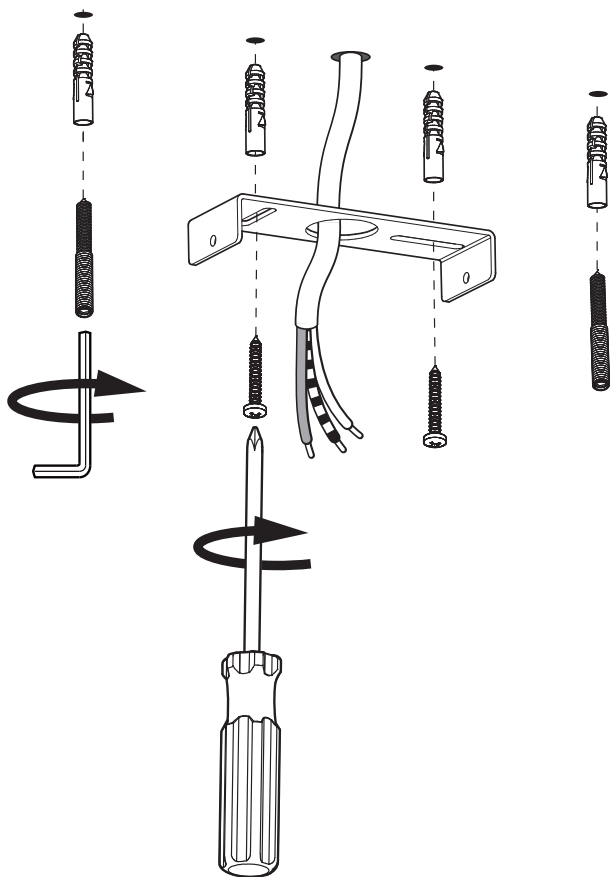

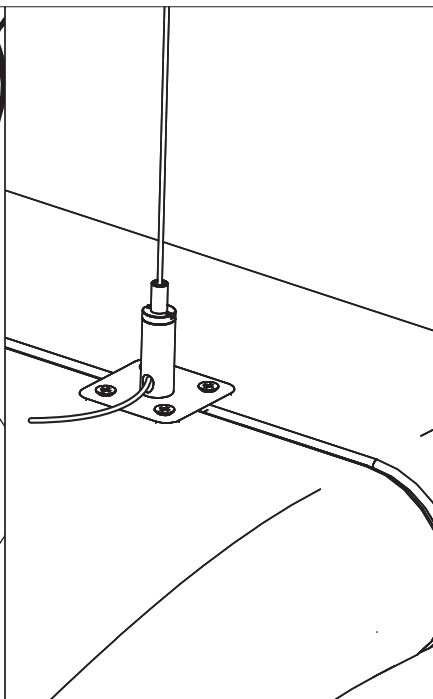
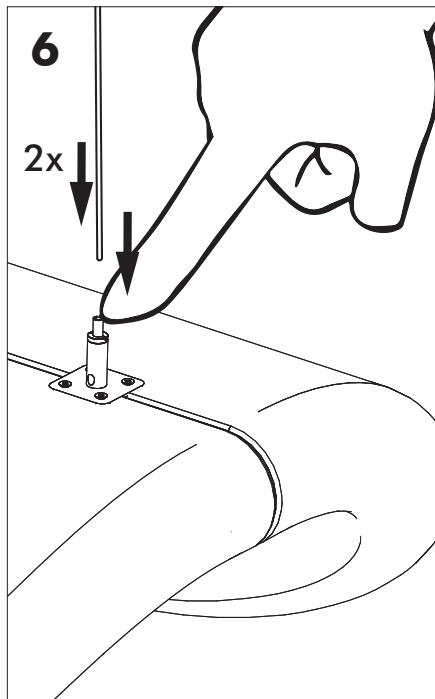
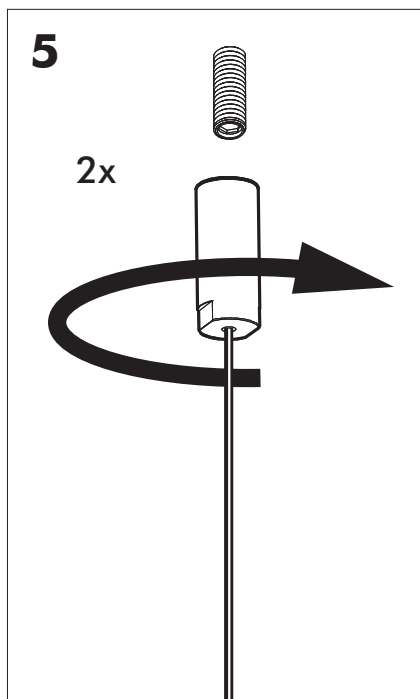
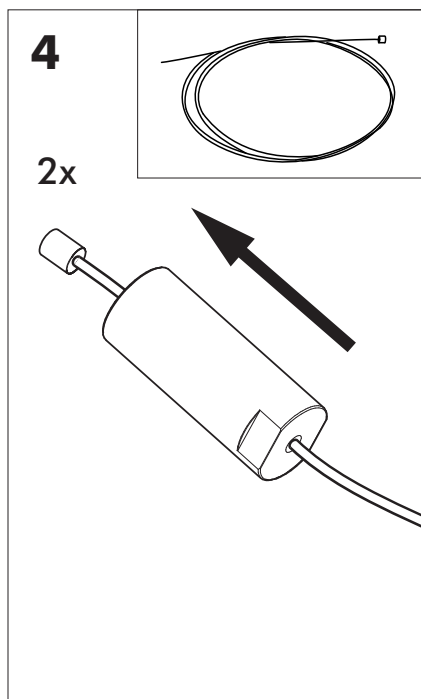

7

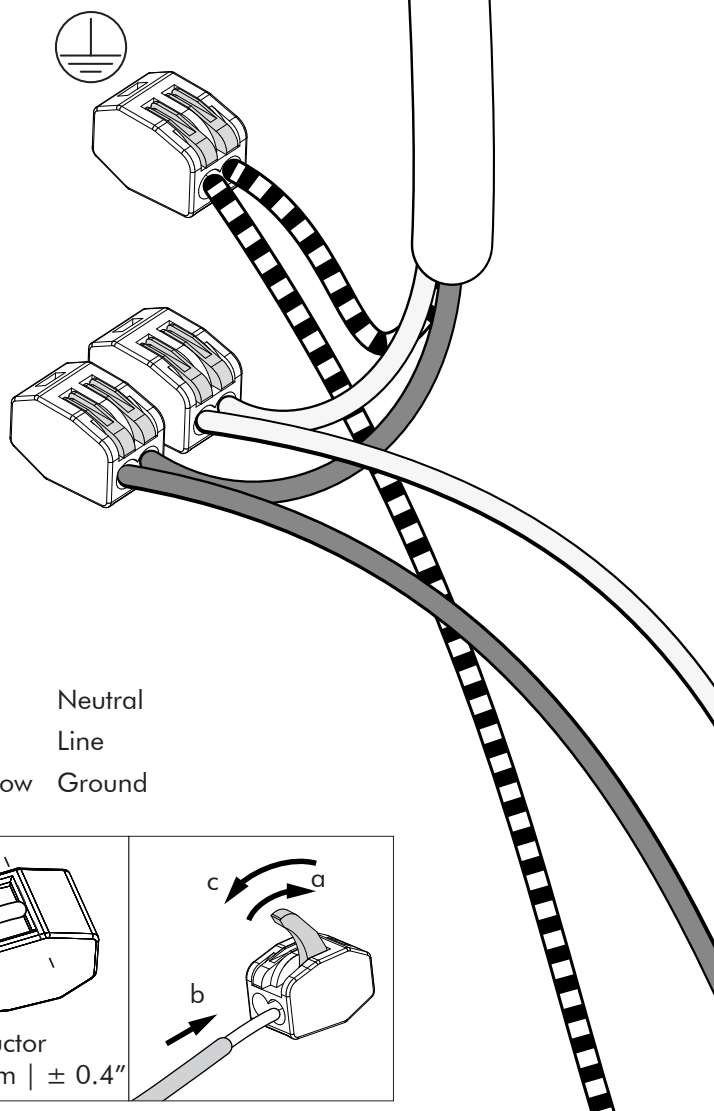

Blue	Neutral
Brown	Line
Green/Yellow	Ground

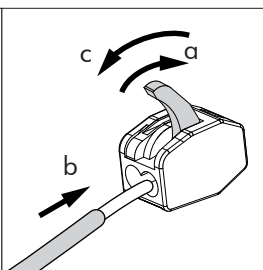
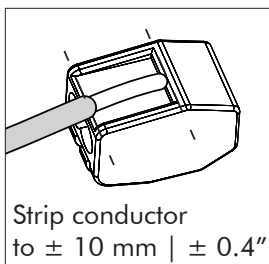

8

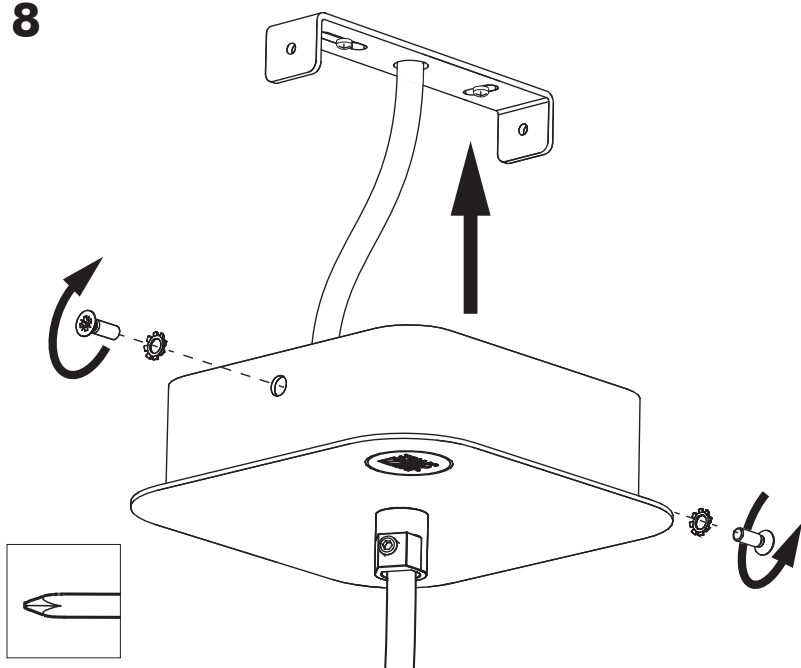

9

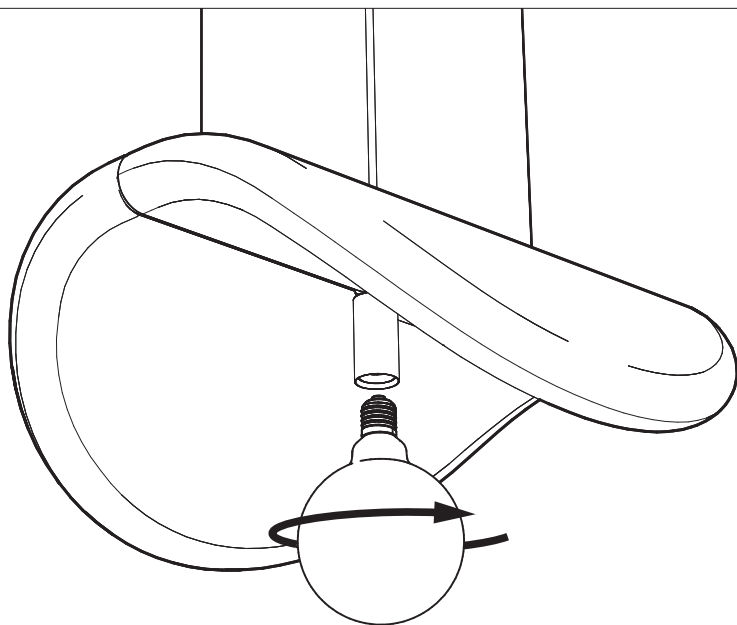

* Bulb Excluded

!

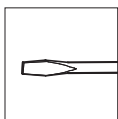
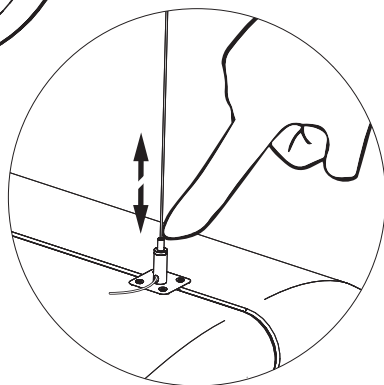
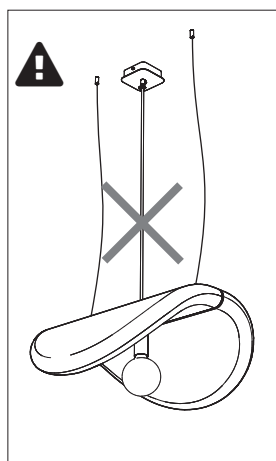
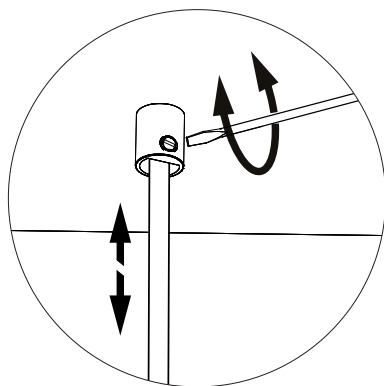
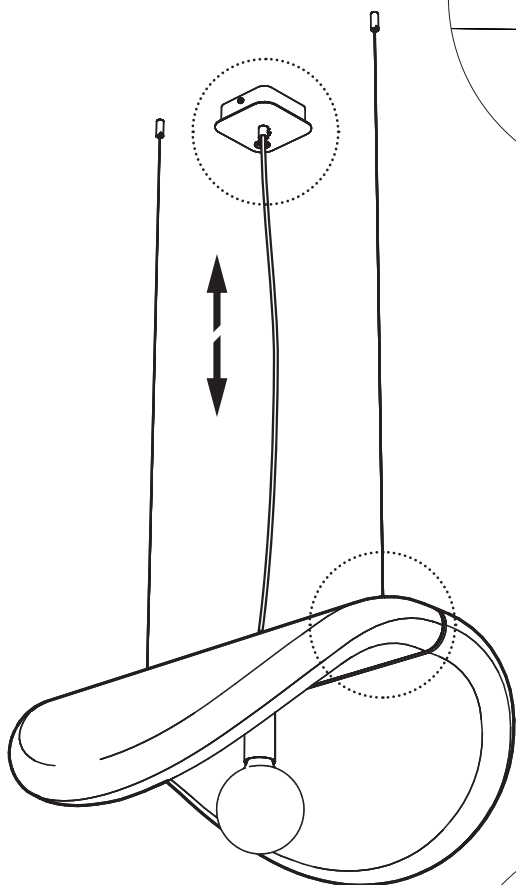

BuzziSpace Group NV
Italiëlei 8, 2000 Antwerp
Belgium

☎ +32 (0)3 846 10 00

✉ info@buzzi.space

🌐 www.buzzi.space



A-0000007939

Last update: 21/02/2024

BuzziChip

INSTALLATION MANUAL

220-240V

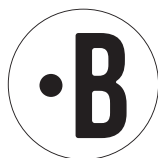
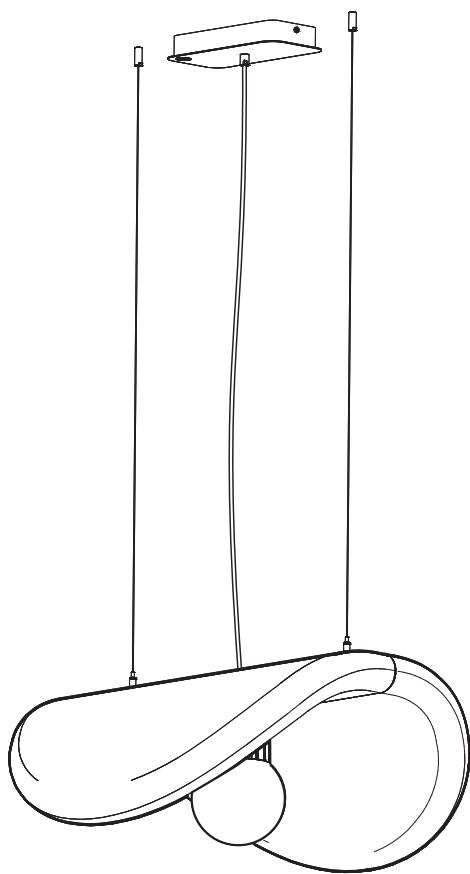

Technical info

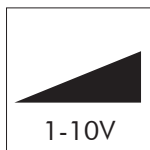

Power factor > 0.8;
Input current: Max 0.35Amp

Environmental Protection

Waste electrical products should not be disposed of with household waste. Please recycle where facilities exist. Check with your Local Authority or retailer for recycling advice.

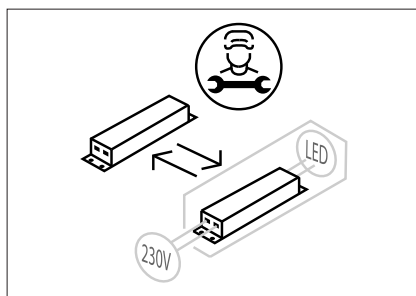
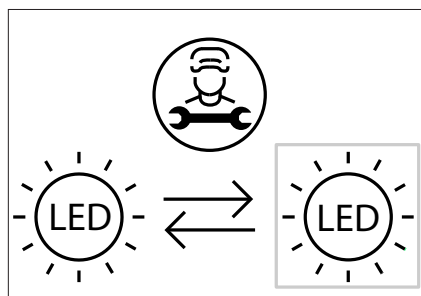

- A** The light source of this luminaire is not replaceable. When the light source reaches its end of life the whole luminaire shall be replaced.

Excluded

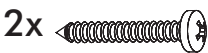
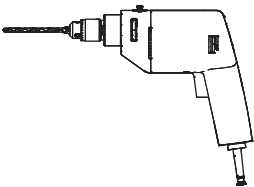
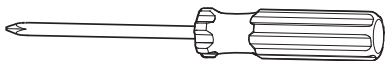
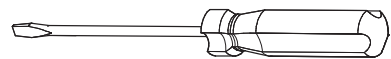

Included BuzziChip Small Globe | Spot

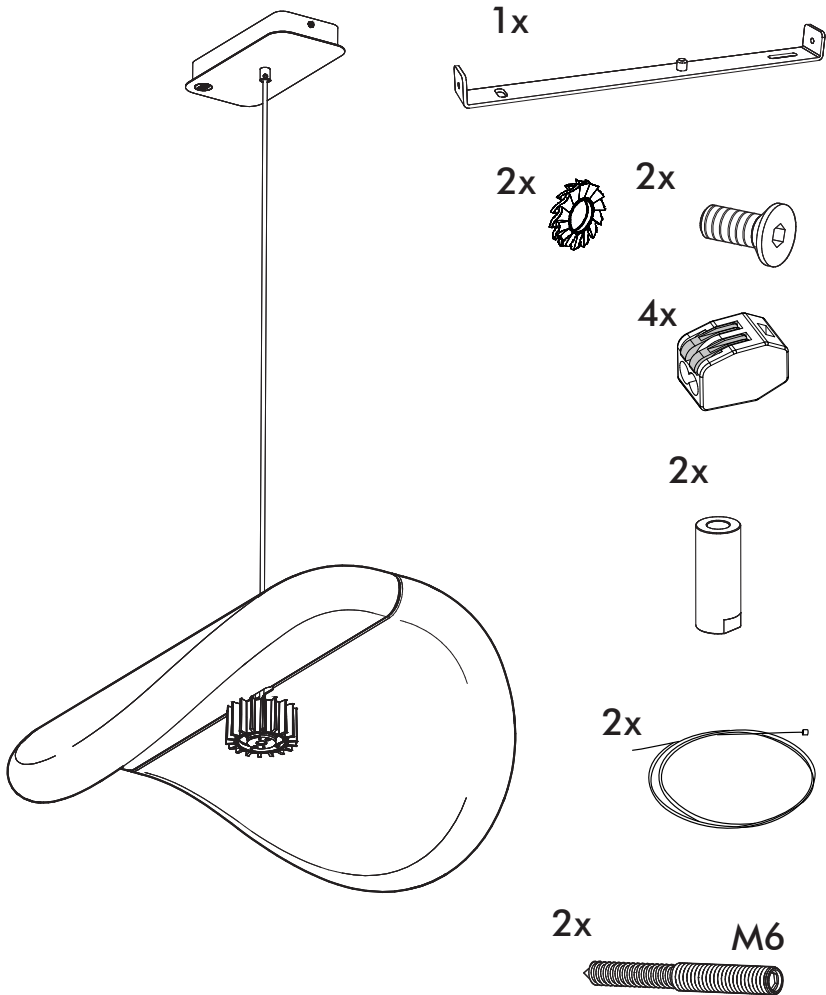

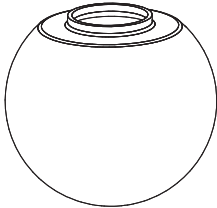
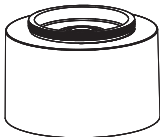
Only if Globe	Only if Spot
1x 	1x 

Included BuzziChip Medium Globe | Spot

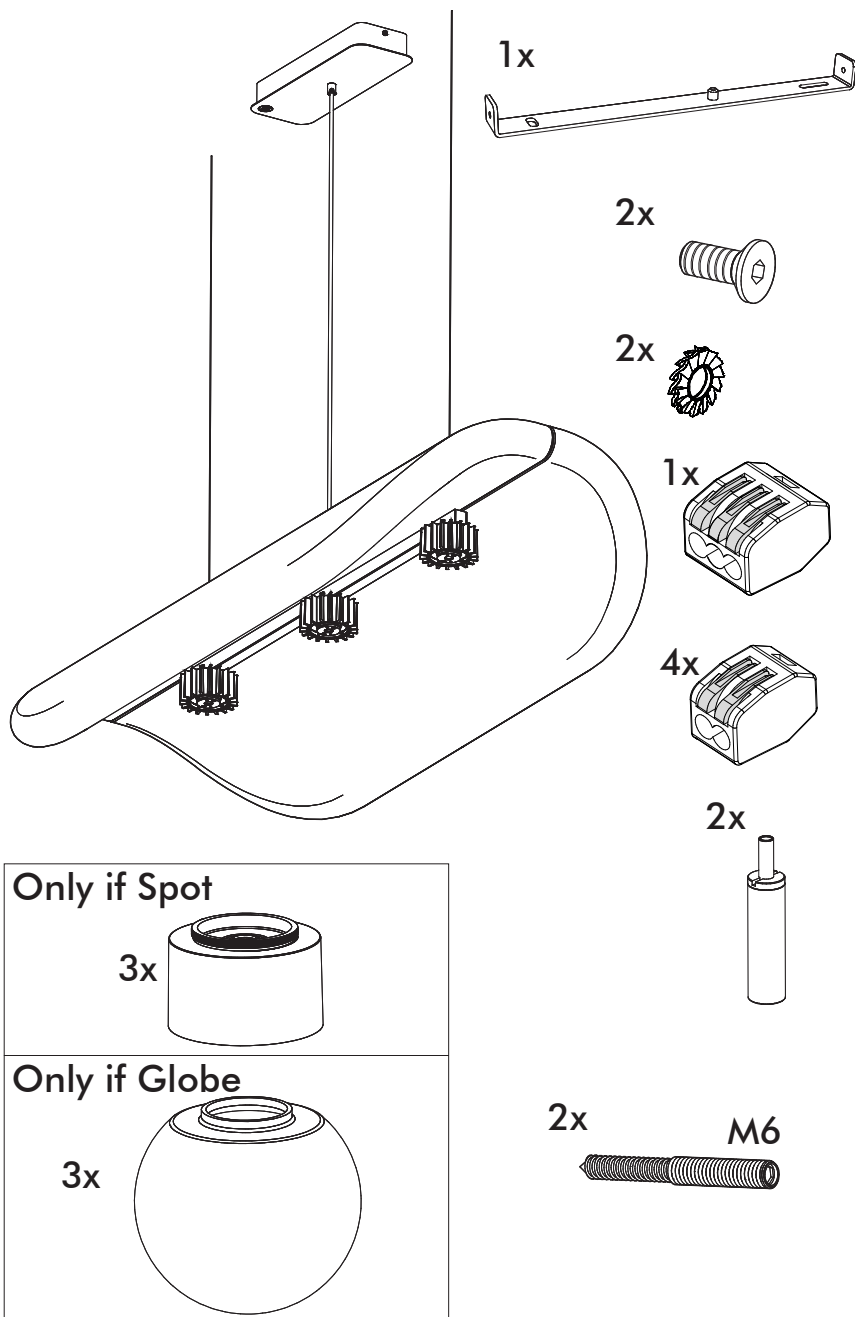

Included BuzziChip Large Globe | Spot

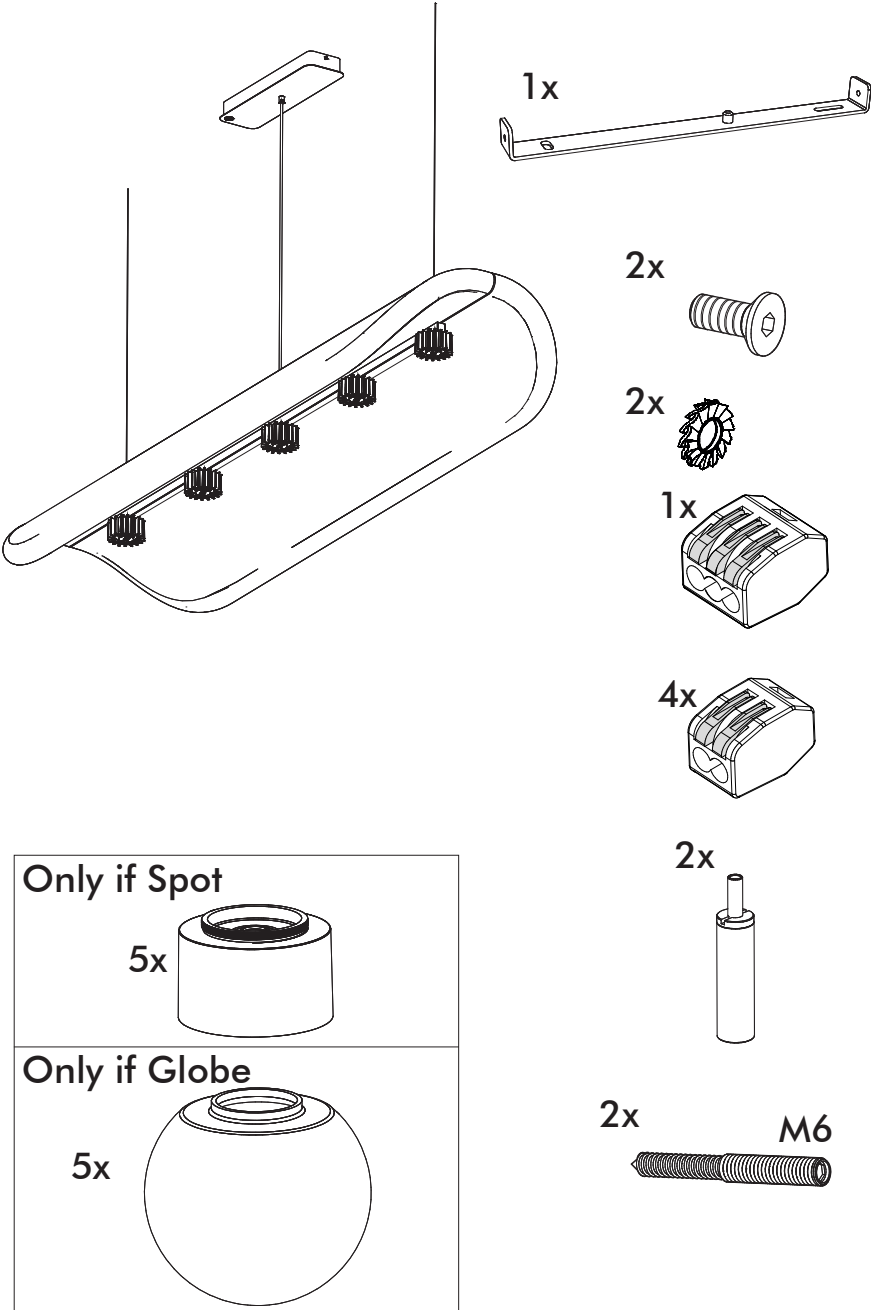

BuzziChip Small

P.8

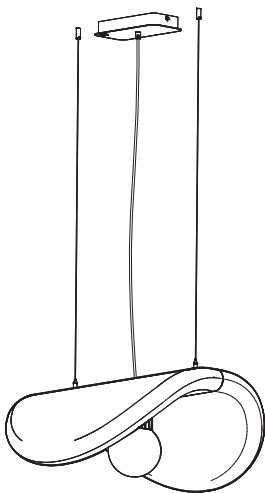

BuzziChip Medium

P.16

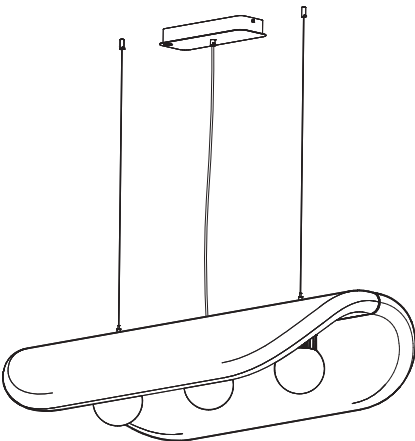

BuzziChip Large

P.16

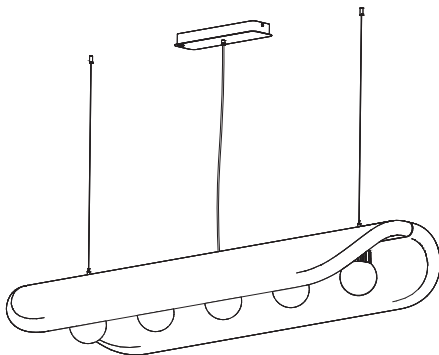

BuzziChip Small

2 PERS. 

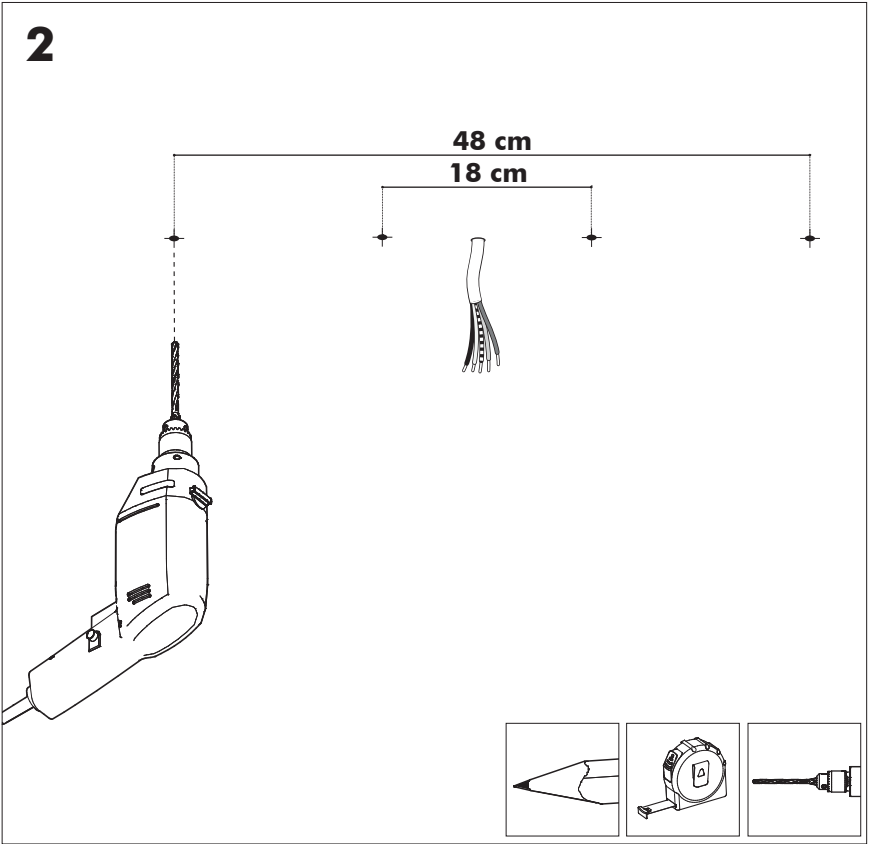
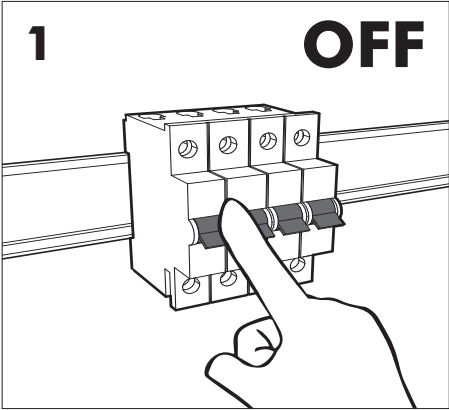

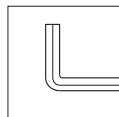
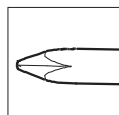
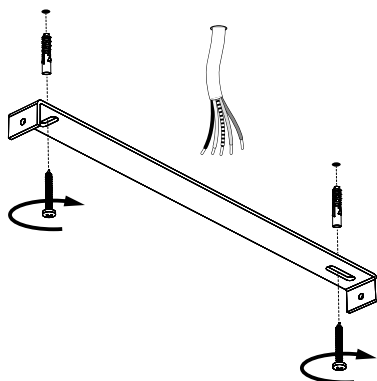
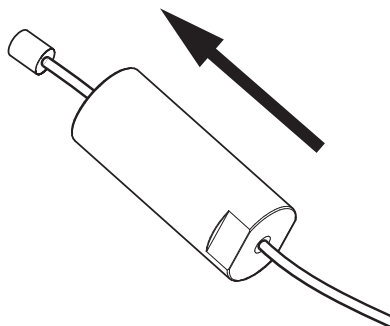
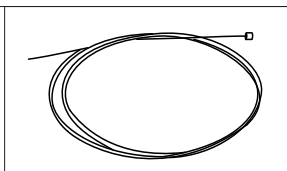
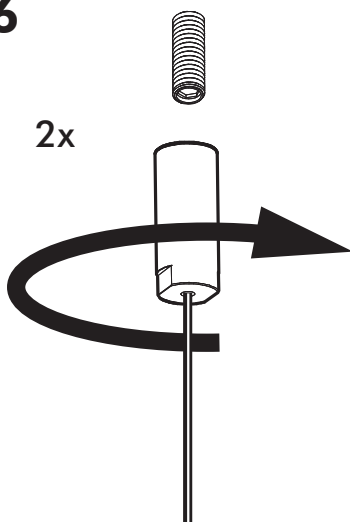
3**4****5****2x****6****2x**

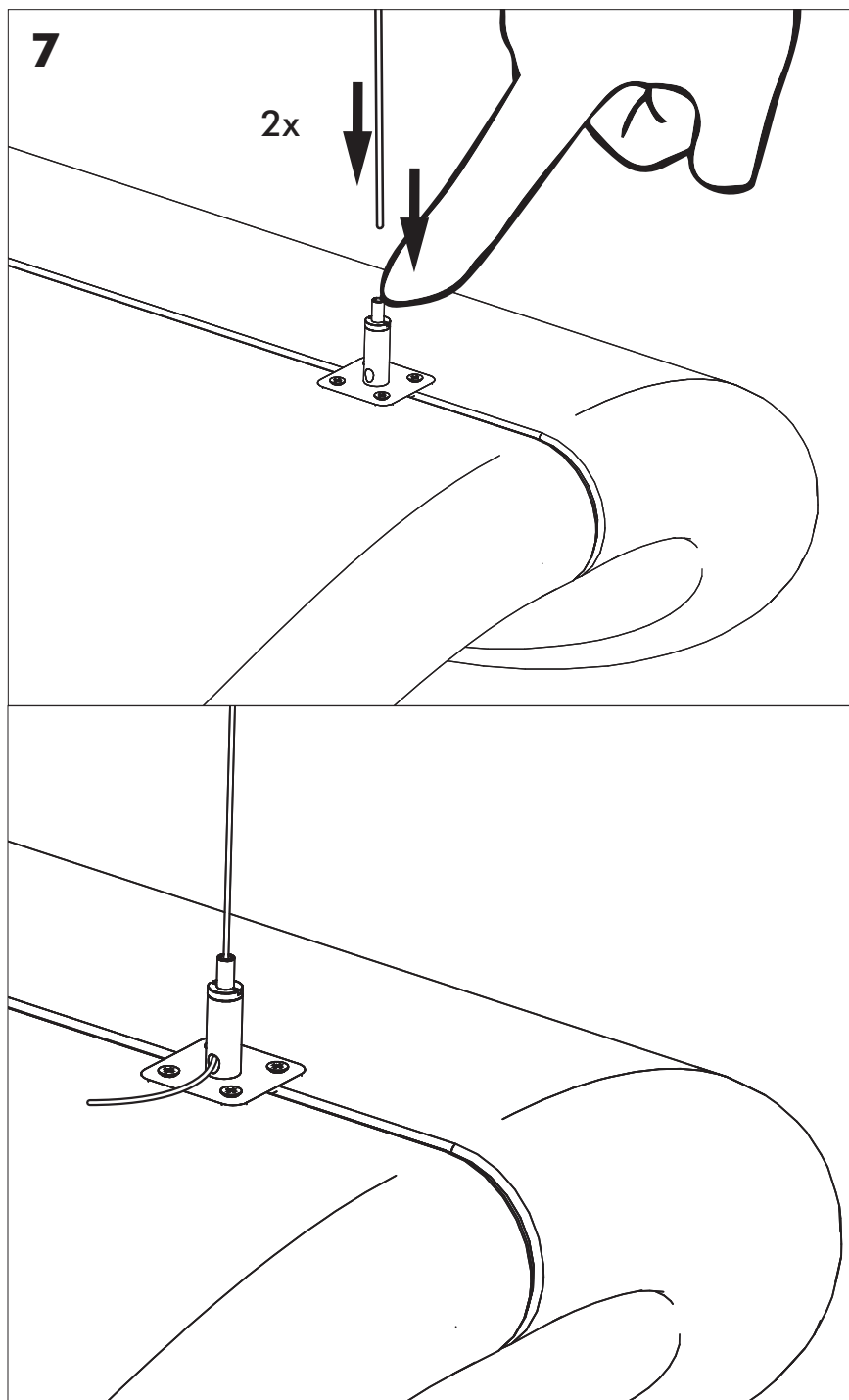

8

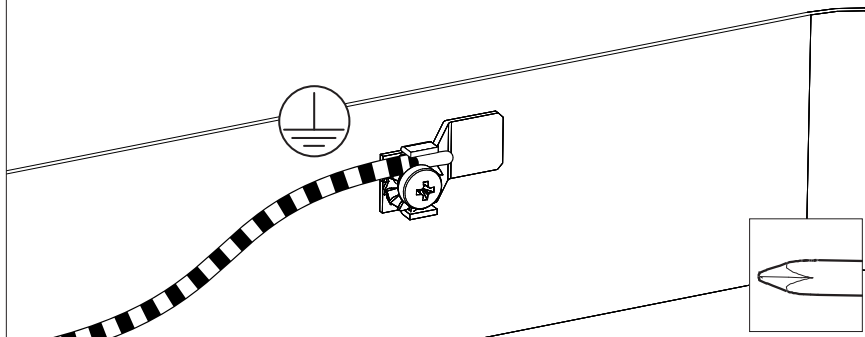

9a

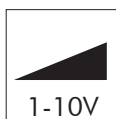

Connection including dimmable function



Dim+

Dim-

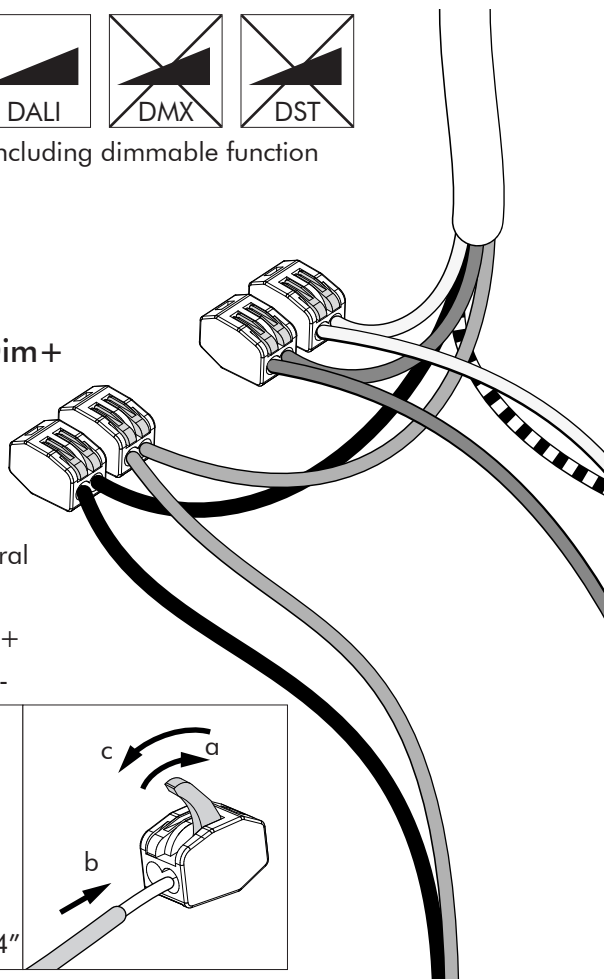

Blue

Neutral

Brown

Line

Red

DIM +

Black

DIM -

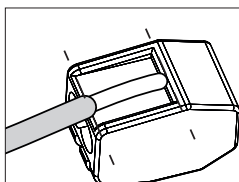

Strip conductor
to $\pm 10 \text{ mm}$ | $\pm 0.4''$

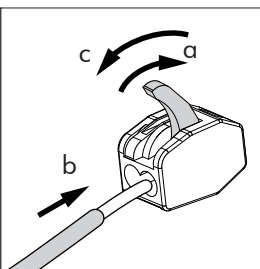

9b

Connection excluding dimmable function

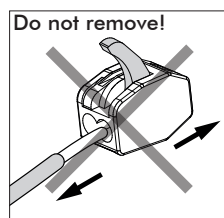

Blue	Neutral
Brown	Line
Red	Not used
Black	Not used

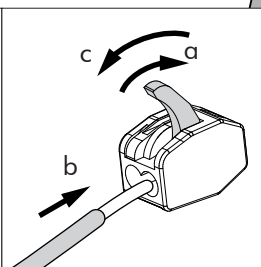
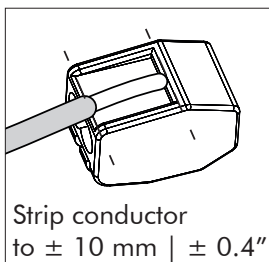

10

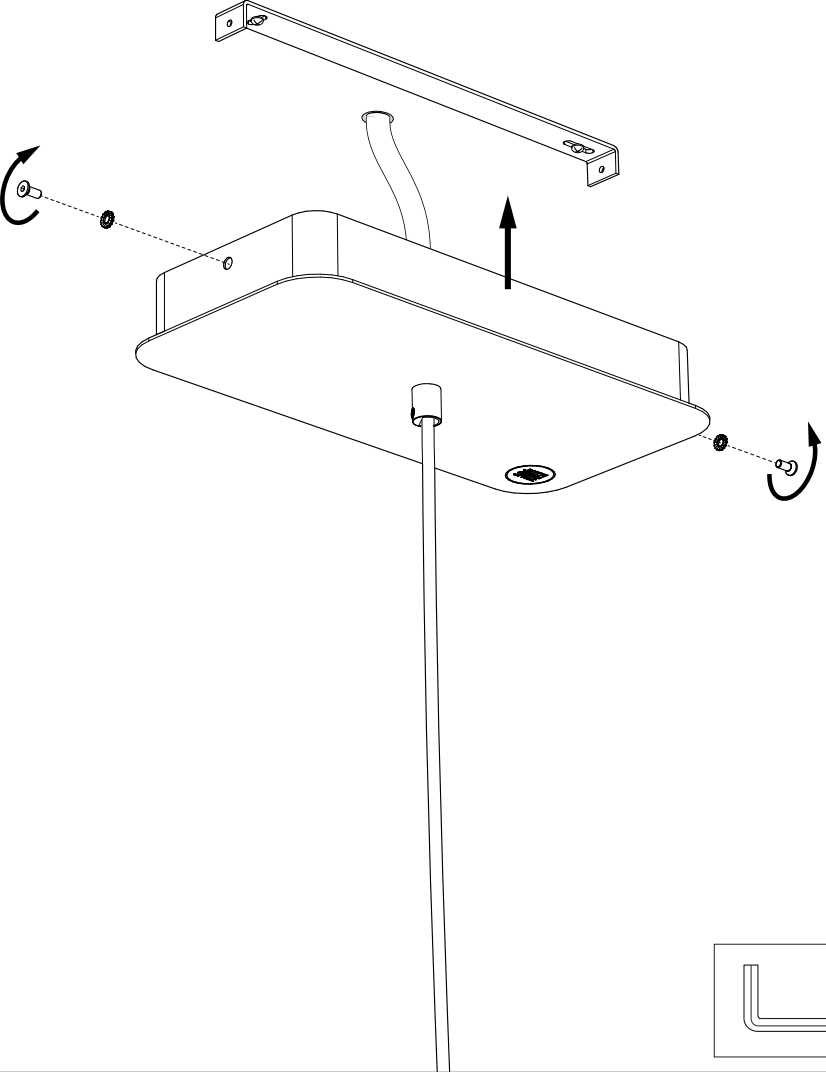

11 Globe

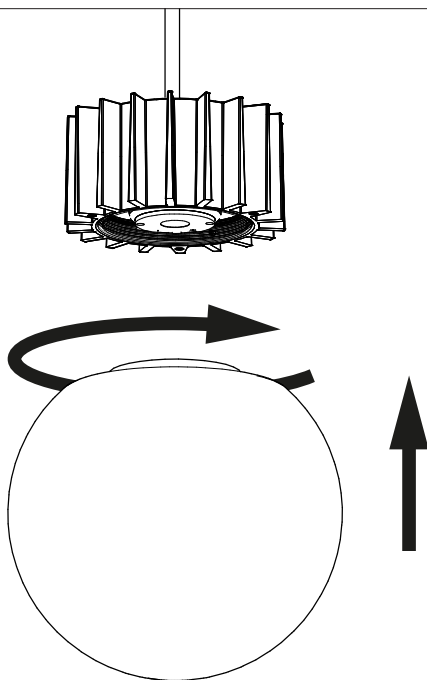

11 Spot

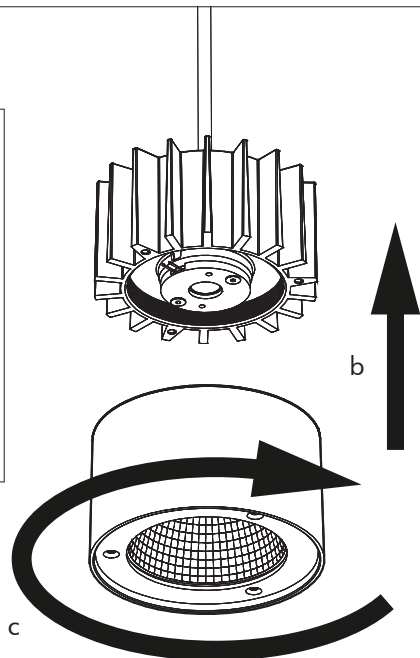
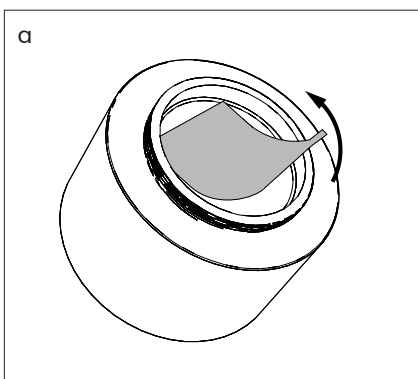

!

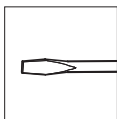
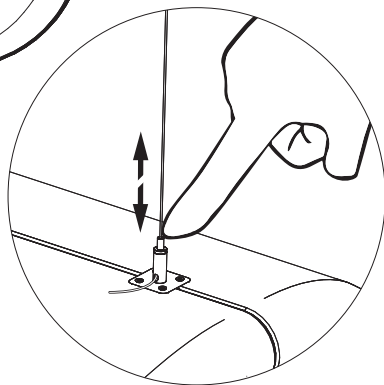
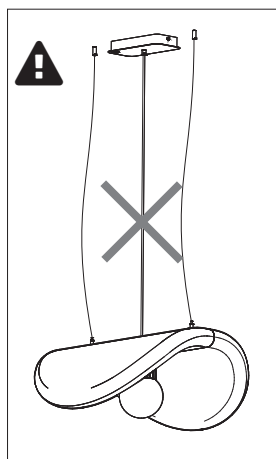
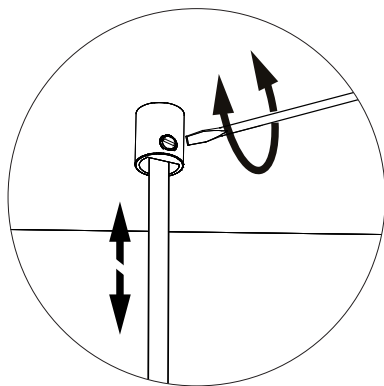
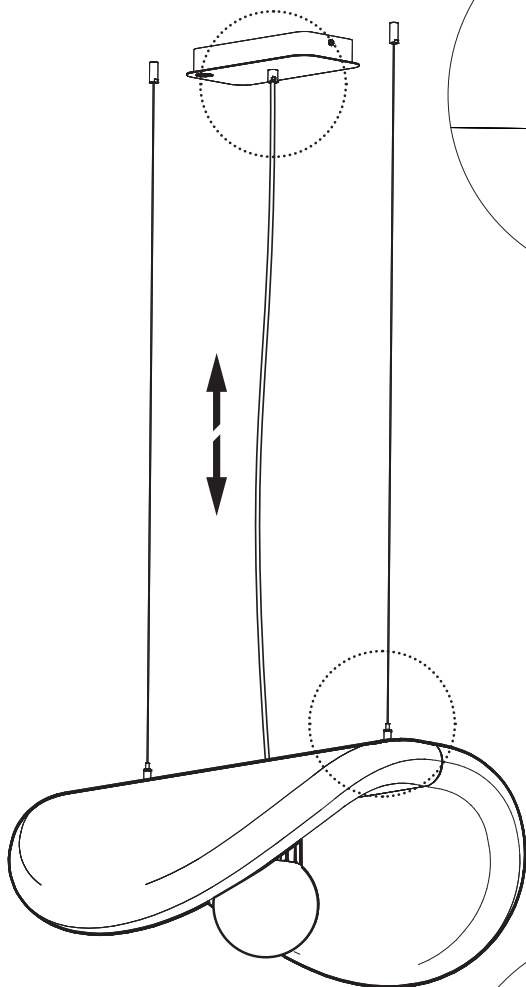

BuzziChip Medium | Large

2 PERS. 

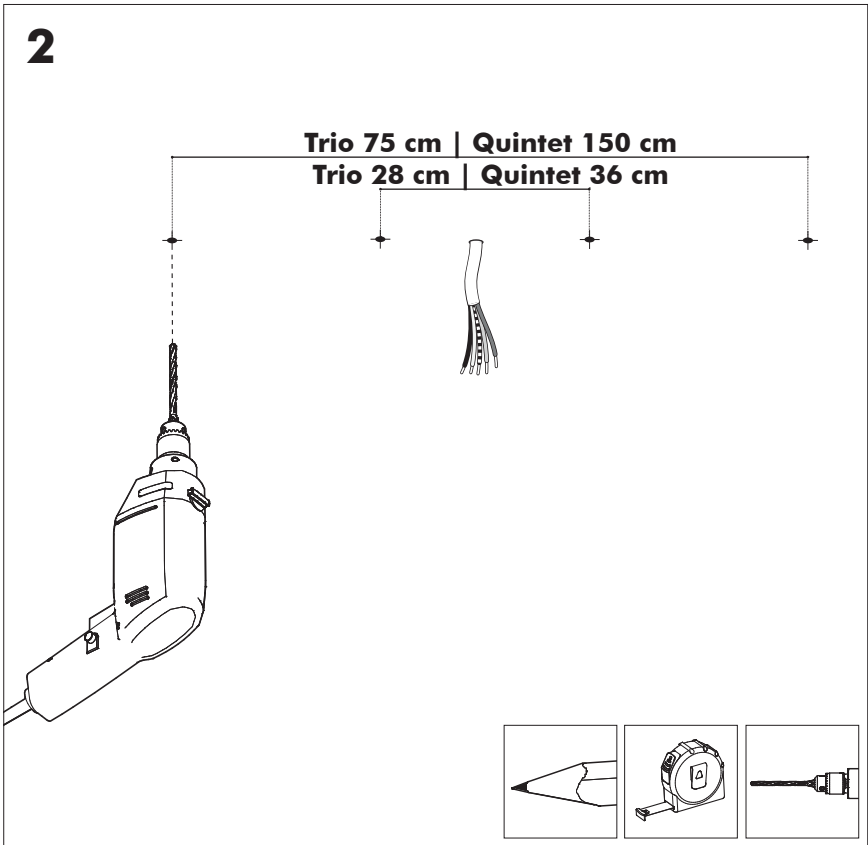
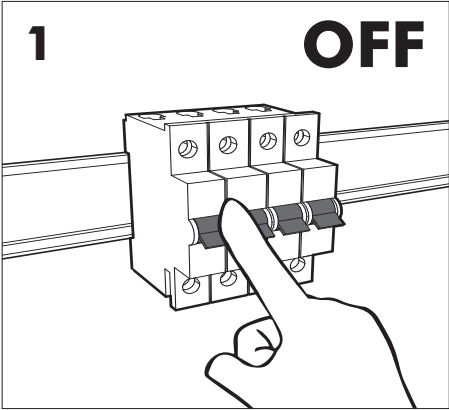

3



4



5

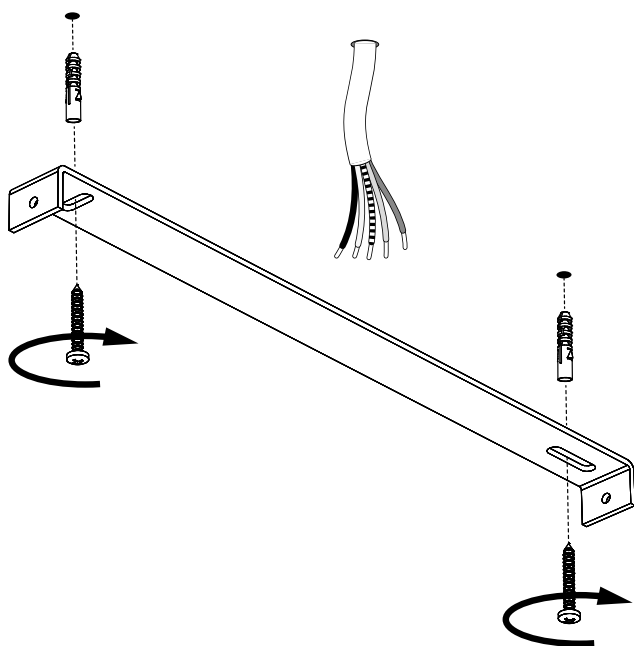

6

2x

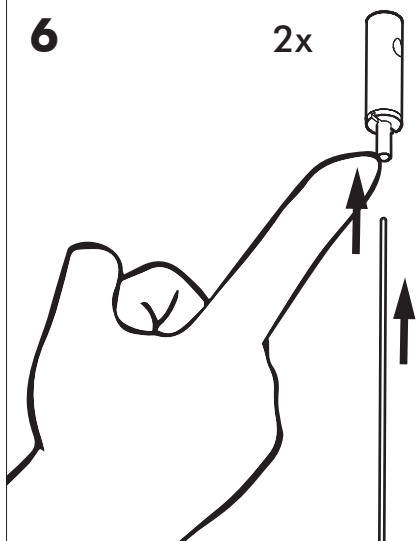

2x



7a

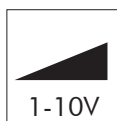

1-10V



DALI



DMX



DST

Connection including dimmable function



Dim+

Dim-

Blue	Neutral
Brown	Line
Red	DIM +
Black	DIM -

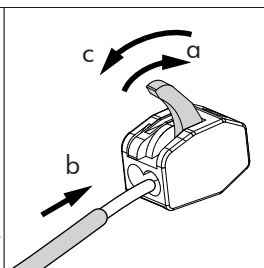
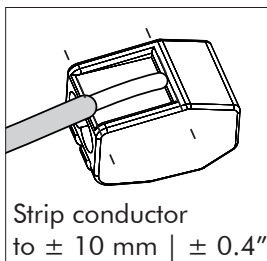

7b

Connection excluding dimmable function

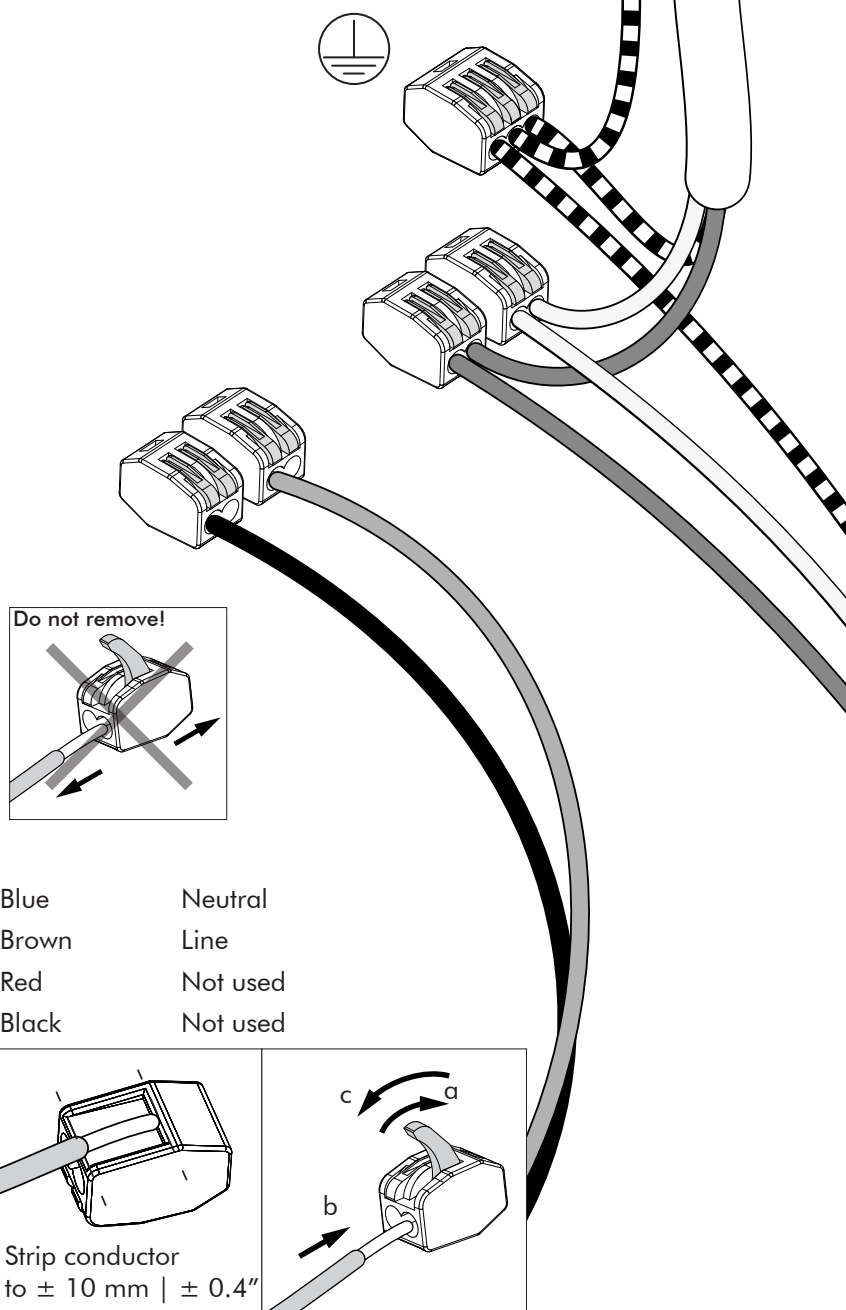

8

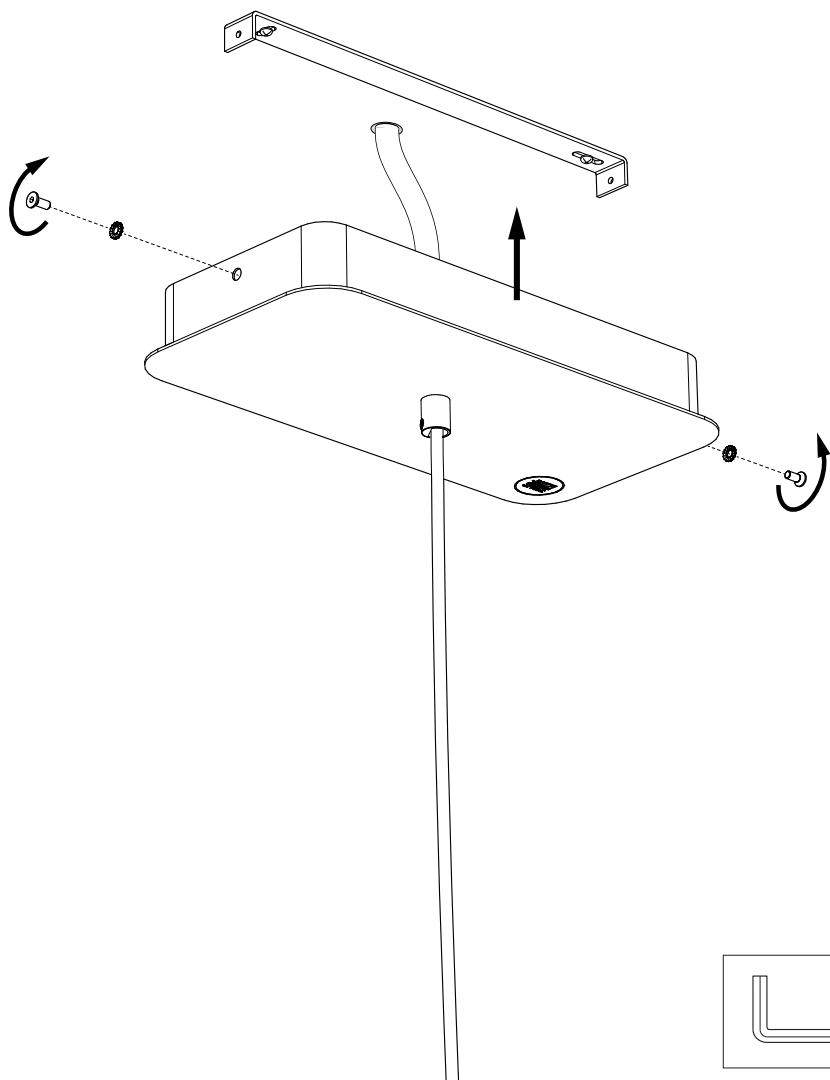

9 Globe

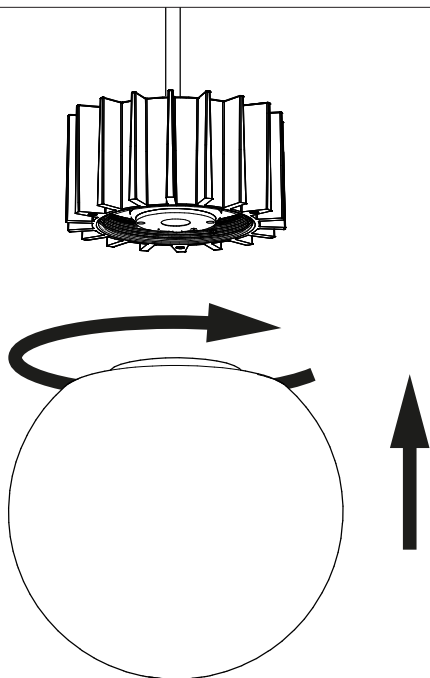

9 Spot

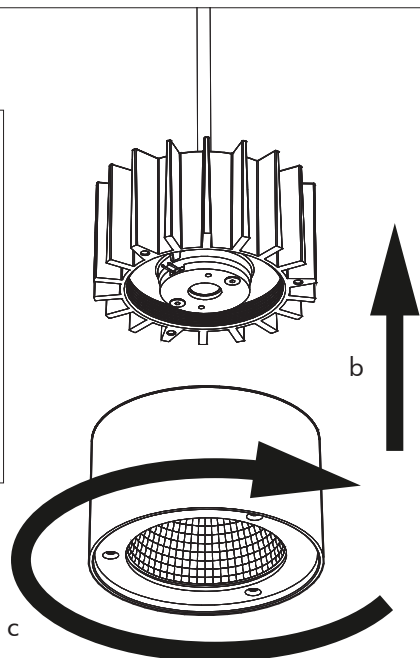
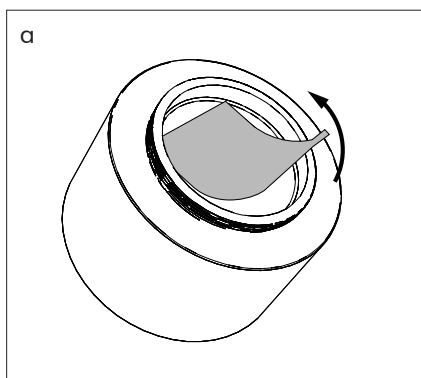

!

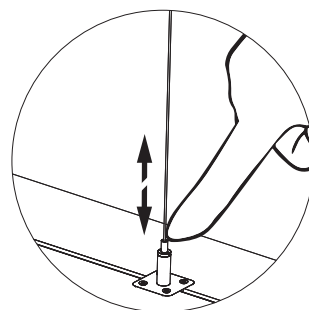
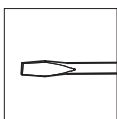
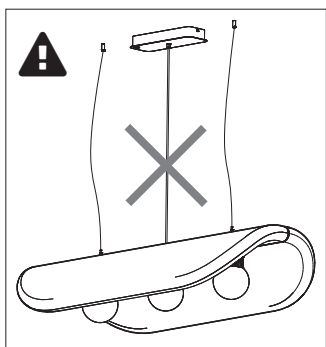
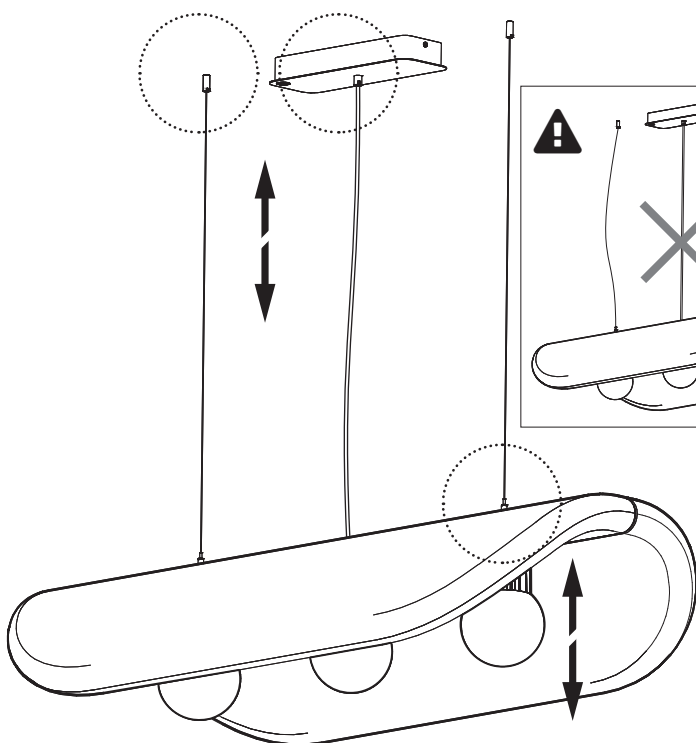
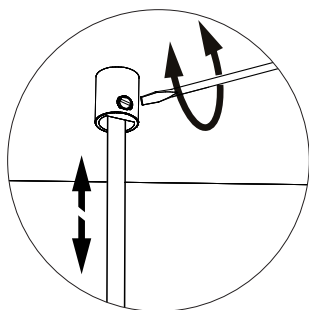
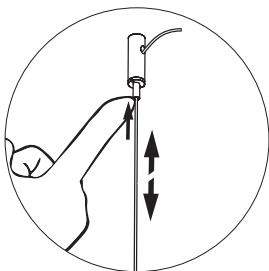

BuzziSpace Group NV
Italiëlei 8, 2000 Antwerp
Belgium

☎ +32 (0)3 846 10 00

✉ info@buzzi.space

🌐 www.buzzi.space



A-0000010709/02

Last update: 30/11/2023