



TECHNICAL SPECIFICATION SHEET

PRODUCT NAME: Flo Now Dynamic Monitor Arm with Split Clamp

PRODUCT CODE: FLO/013/001

Doc Rev 1

03/12/2024 CS

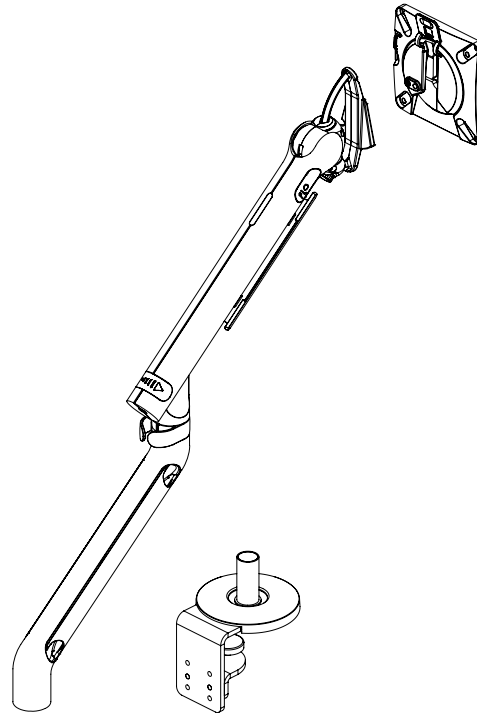

KEY FEATURES

- 2–7kg load range - Flo is designed to accommodate with ease the latest generation of screens (up to 34 inches) including curved screens (up to 1000R and above).
- Ultimate cable control – with a smart new cable cradle, built-in mid clip and removable side panels, it's easier than ever to control your cables and preserve the clean lines of Flo. A clutter-free workstation gives you the space to be more productive.
- Smooth, dynamic movement through its patent pending Flo Dual Rate Spring Technology. Diamond D Ring Tilt Mechanism – with effortless fingertip tilt control, Flo makes it easier than ever to quickly and precisely adjust your screen with minimal effort. Finding your optimal screen position helps eliminate glare, reduce visual fatigue and encourage a healthy posture.
- Tilt Head Adjustment Screw - with Flo's innovative tilt adjustment, you can quickly and easily adjust the friction to cater for different curvature sizes.
- Portrait / landscape screen rotation.
- Built with sustainability in mind – can be easily dismantled and more readily recycled.
- Timeless design upgraded feel - While Flo has been designed for the latest screens of today and tomorrow, we've stayed true to its minimalist design roots. Its clean, aesthetically pleasing lines are upgraded with a new texture and a contemporary monotone colour finish. And because Flo is

compatible across our current range, it will blend seamlessly into your existing workspace and set-up.

- Weight gauge reduces installation time and provides consistent performance.
- Range Compatible – Flo fits other accessories e.g. Ondo.
- Clamp is suitable for desk thicknesses from 0-65mm.
- Plastic free packaging.

PRODUCT PERFORMANCE GUIDELINES

Load Support Range: 2 – 7kg
(4.4 – 15.4lb)

Mounted Screen Size: 32" diagonal max (Aspect ratio: 16:9)
34" diagonal max (Aspect ratio: 21:9)

Screen Curvature Range: 1000R and above

Horizontal Reach: 584mm

Vertical Reach: 483mm

Tilt Range: 30° upwards, 25° downwards

Maximum screen size envelope covering Flat and Curved PC Monitors

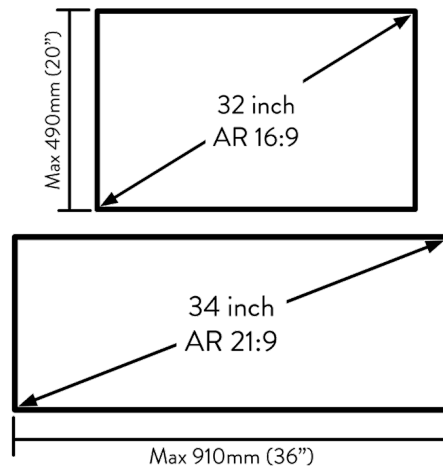

Maximum Monitor Depth

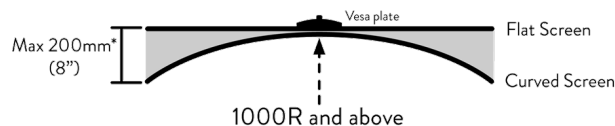

*Ensure that the total depth from the VESA plate mounting point, to the furthest forward vertical edge of the monitor does not exceed 200mm.

Minimum and Maximum Screen Weight (without stand)

2 - 7KG
4.4 - 15LB



colebrook bosson saunders

Maximum Reach Dimensions

Lowest Position

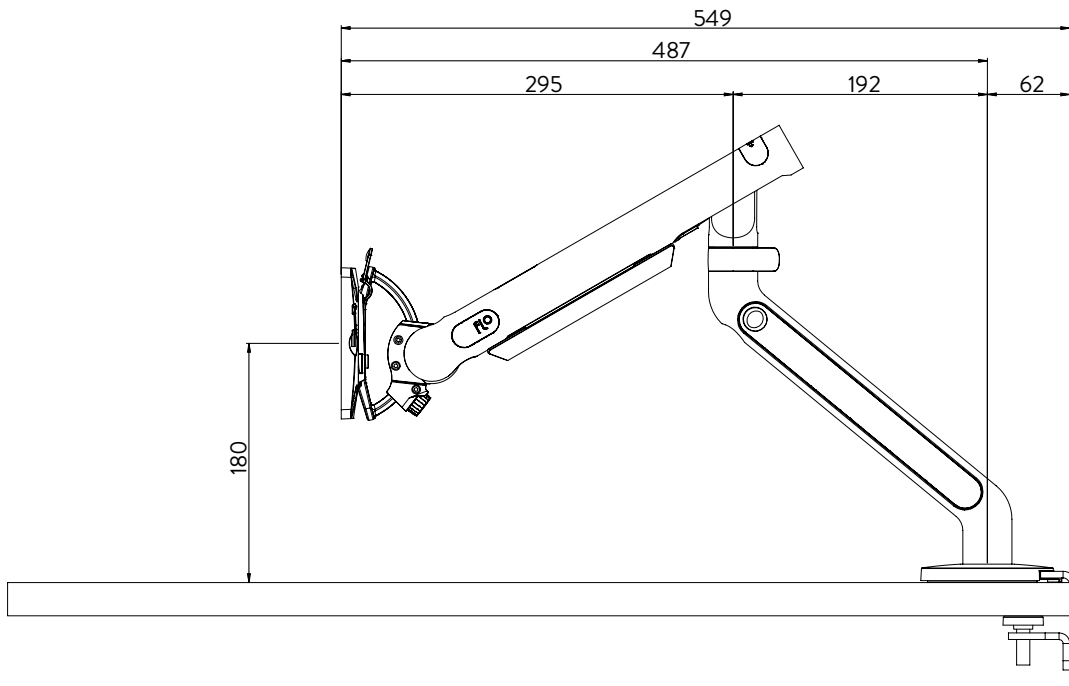

Mid Position

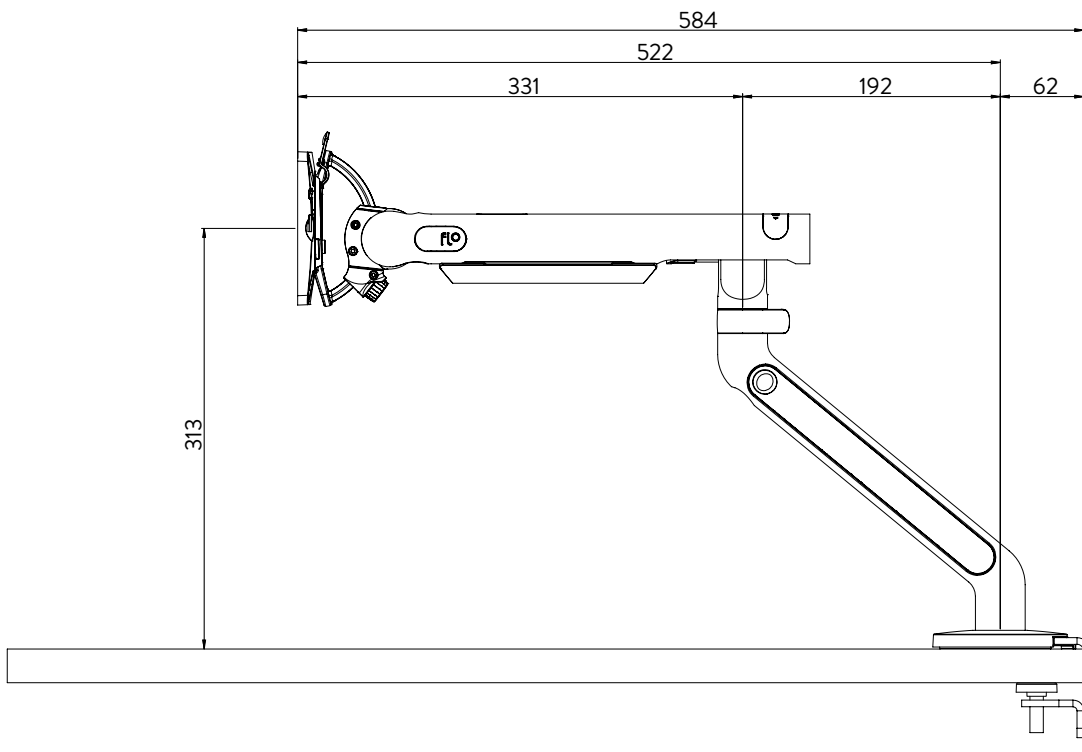

Highest Position

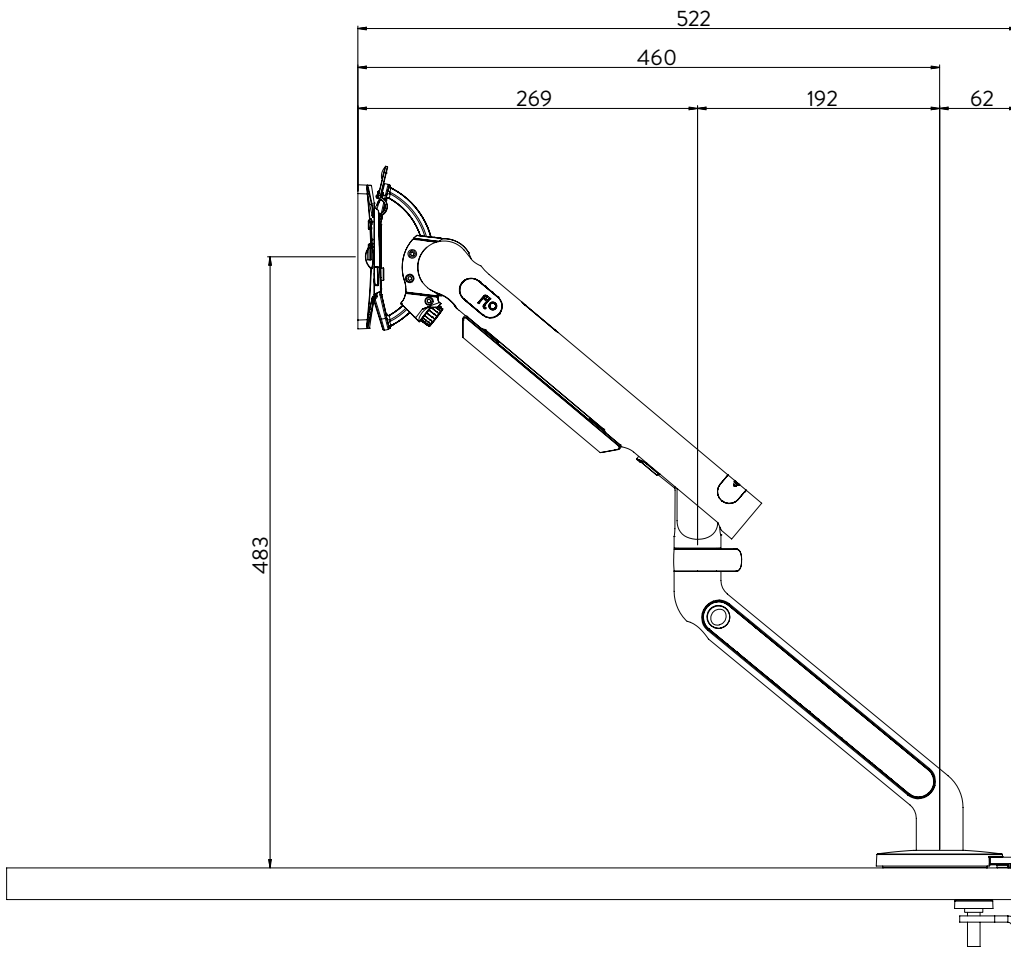

Minimum Reach Dimensions

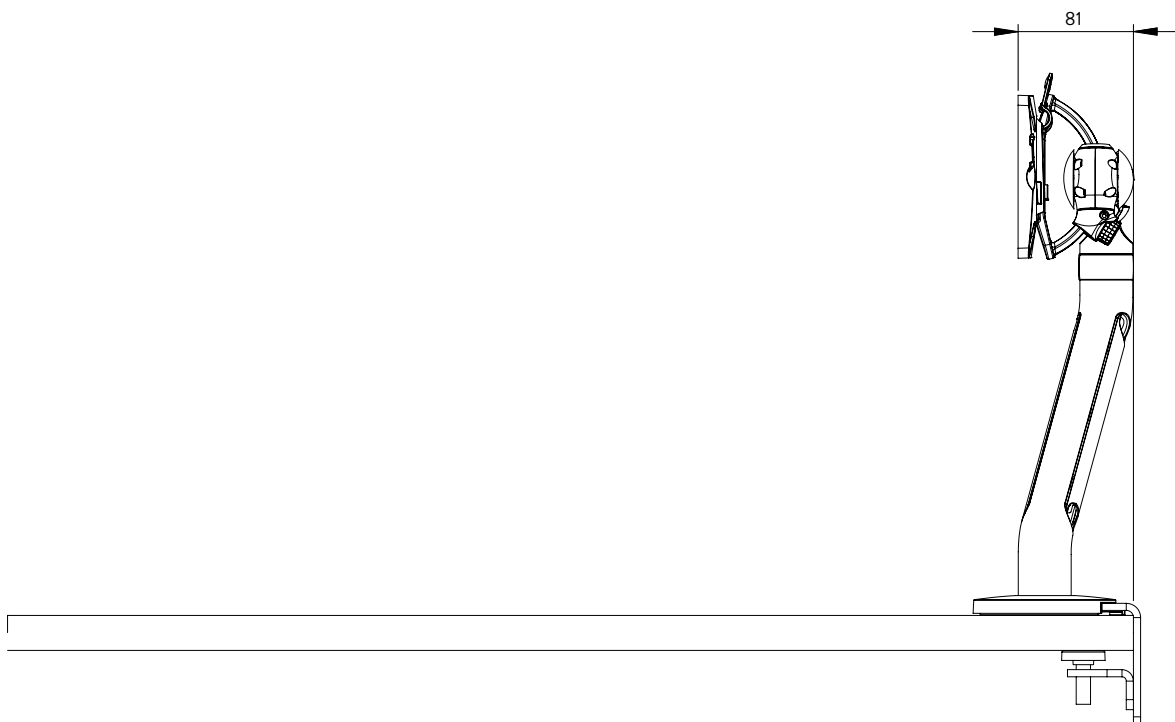

Height Dimensions

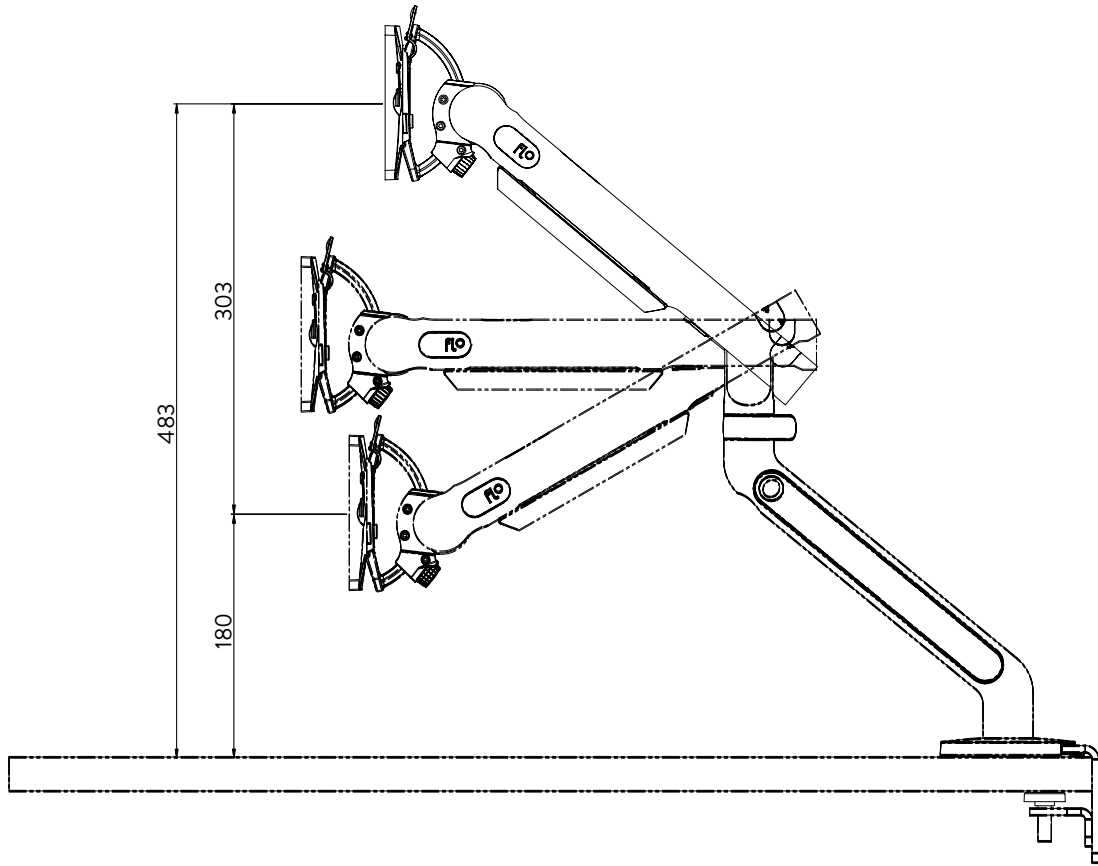

VESA Tilt Dimensions

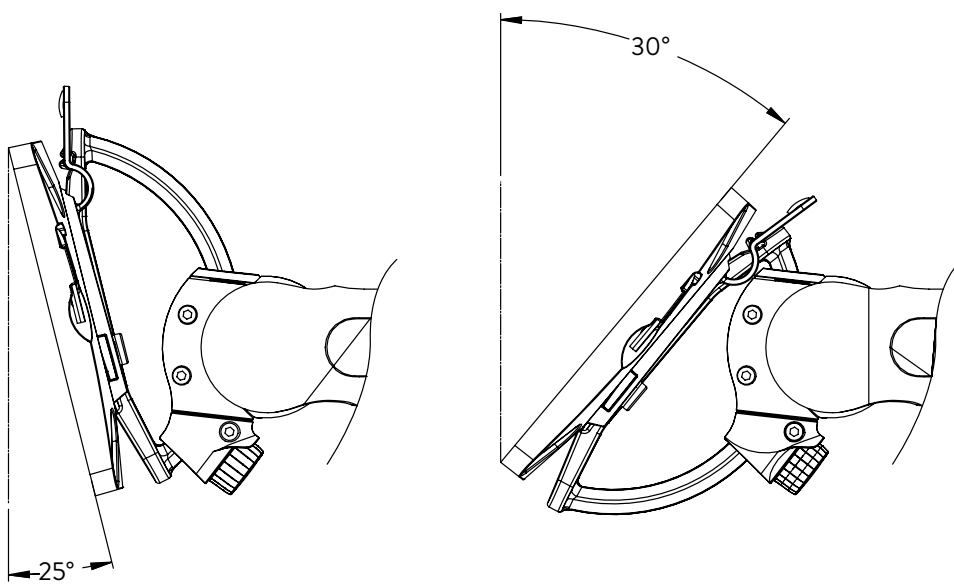

LOGISTICAL

Box contains	Arm & Quick Release Mount Plate (incl. VESA screw pack), Allen Key, Split Clamp with Accessories Bag (containing clamp screw & clamp pad), Instructions.
Product net weight:	2.57 kg
Box dims	706 x 145 x 112 mm
Box gross weight	2.96kg
Master carton quantity	6 units
Master carton dims	725 x 300 x 345 mm
Master carton weight	18.6kg
Country of origin	China

ORDERING INFORMATION

<u>Product Description</u>	<u>Product Code</u>	<u>Colour</u>
Flo Arm including Split Clamp Desk Fixing	FLO/013/001/B	Black
Flo Arm including Split Clamp Desk Fixing	FLO/013/001/W	White

WARRANTY

Warranty Term	12 years
----------------------	----------

COMPLIANCE & SAFETY CERTIFICATION

Whilst no mandatory standards apply to the monitor arm product sector, all Colebrook Bosson Saunders monitor arms have been designed with appropriate articulation features, dimensional range and adjustability to conform to the requirements of BS EN ISO 9241:5 1999 Ergonomic requirements for office work with visual display terminals (VDTs).

CLEANING, STORAGE & MAINTENANCE

Routine servicing	Periodic inspection
Service components	Available to order
Cleaning & Maintenance	Damp cloth, no abrasives, no solvents to be used on the cosmetic surfaces
Handling & Storage	Do not drop or expose to moisture

While every effort is made to ensure the accuracy of our technical information, Colebrook Bosson Saunders (Products) Ltd accept no liability for the accuracy of the information contained in this document and reserve the right to modify the specifications or data contained herein without prior notification.



TECHNICAL SPECIFICATION SHEET

PRODUCT NAME: Flo Now Dynamic Monitor Arm

PRODUCT CODE: FLO/013/010

Doc Rev 1

03/12/2024 CS

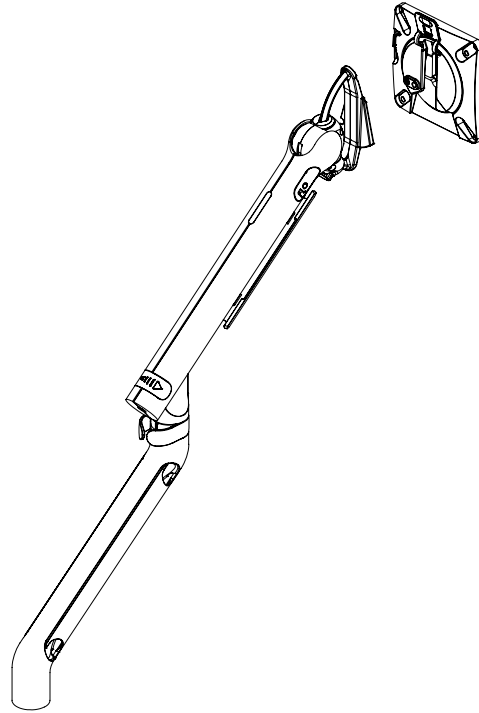

KEY FEATURES

- 2–7kg load range - Flo is designed to accommodate with ease the latest generation of screens (up to 34 inches) including curved screens (up to 1000R and above).
- Ultimate cable control – with a smart new cable cradle, built-in mid clip and removable side panels, it's easier than ever to control your cables and preserve the clean lines of Flo. A clutter-free workstation gives you the space to be more productive.
- Smooth, dynamic movement through its patent pending Flo Dual Rate Spring Technology. Diamond D Ring Tilt Mechanism – with effortless fingertip tilt control, Flo makes it easier than ever to quickly and precisely adjust your screen with minimal effort. Finding your optimal screen position helps eliminate glare, reduce visual fatigue and encourage a healthy posture.
- Tilt Head Adjustment Screw - with Flo's innovative tilt adjustment, you can quickly and easily adjust the friction to cater for different curvature sizes.
- Portrait / landscape screen rotation.
- Built with sustainability in mind – can be easily dismantled and more readily recycled.
- Timeless design upgraded feel - While Flo has been designed for the latest screens of today and tomorrow, we've stayed true to its minimalist design roots. Its clean, aesthetically pleasing lines are upgraded with a new texture and a contemporary monotone colour finish. And because Flo is compatible across our current range, it will blend seamlessly into your existing workspace and set-up.
- Weight gauge reduces installation time and provides consistent performance.

- Range Compatible – Flo fits existing desk clamps & other accessories e.g. Ondo.
- Available in a ‘Bulk Pack’ option in selected regions (pack of 10) – for less waste & reduced carbon emissions.
- Plastic free packaging.

PRODUCT PERFORMANCE GUIDELINES

Load Support Range:	2 – 7kg (4.4 – 15.4lb)
Mounted Screen Size:	32” diagonal max (Aspect ratio: 16:9) 34” diagonal max (Aspect ratio: 21:9)
Screen Curvature Range:	1000R and above
Horizontal Reach:	584mm
Vertical Reach:	483mm
Tilt Range:	30° upwards, 25° downwards

Maximum screen size envelope covering Flat and Curved PC Monitors

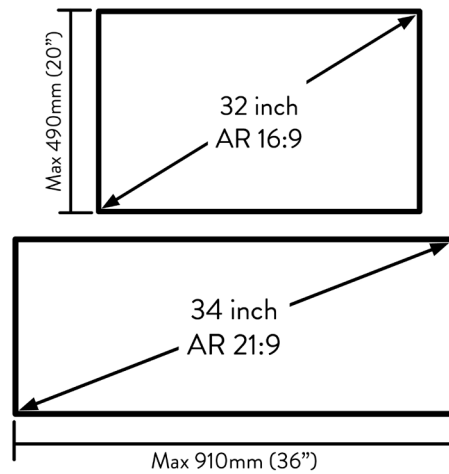

Maximum Monitor Depth

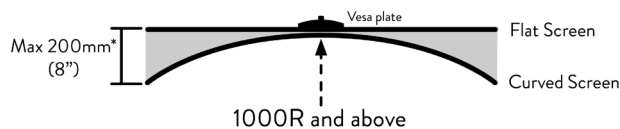

*Ensure that the total depth from the VESA plate mounting point, to the furthest forward vertical edge of the monitor does not exceed 200mm.

Minimum and Maximum Screen Weight (without stand)

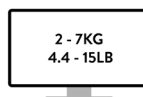

Maximum Reach Dimensions

Lowest Position

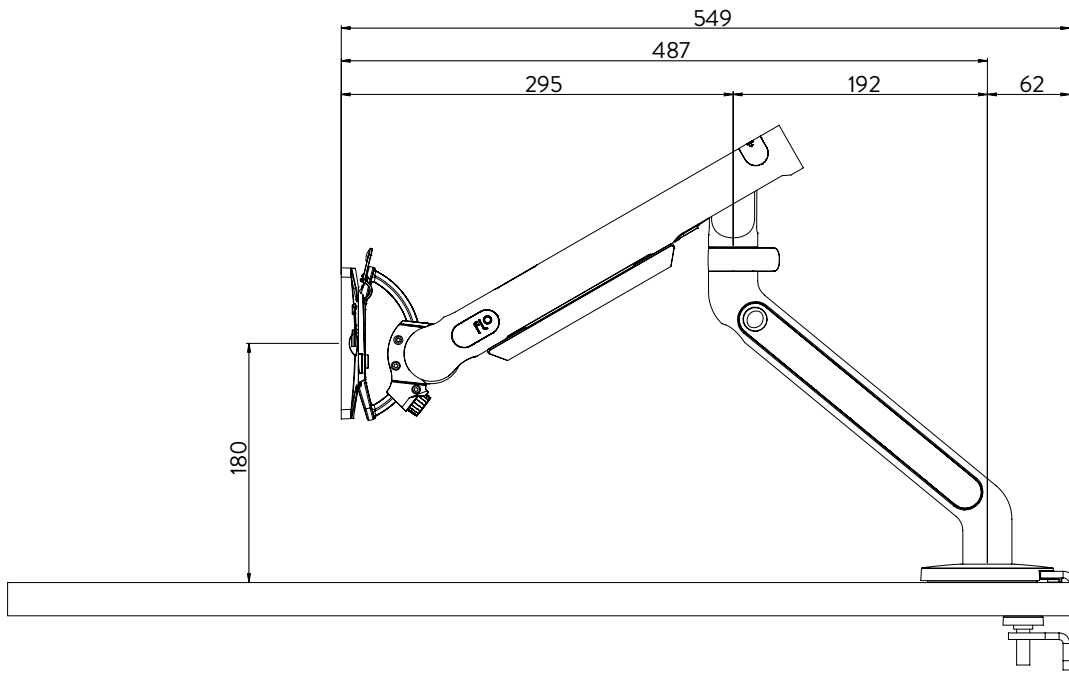

Mid Position

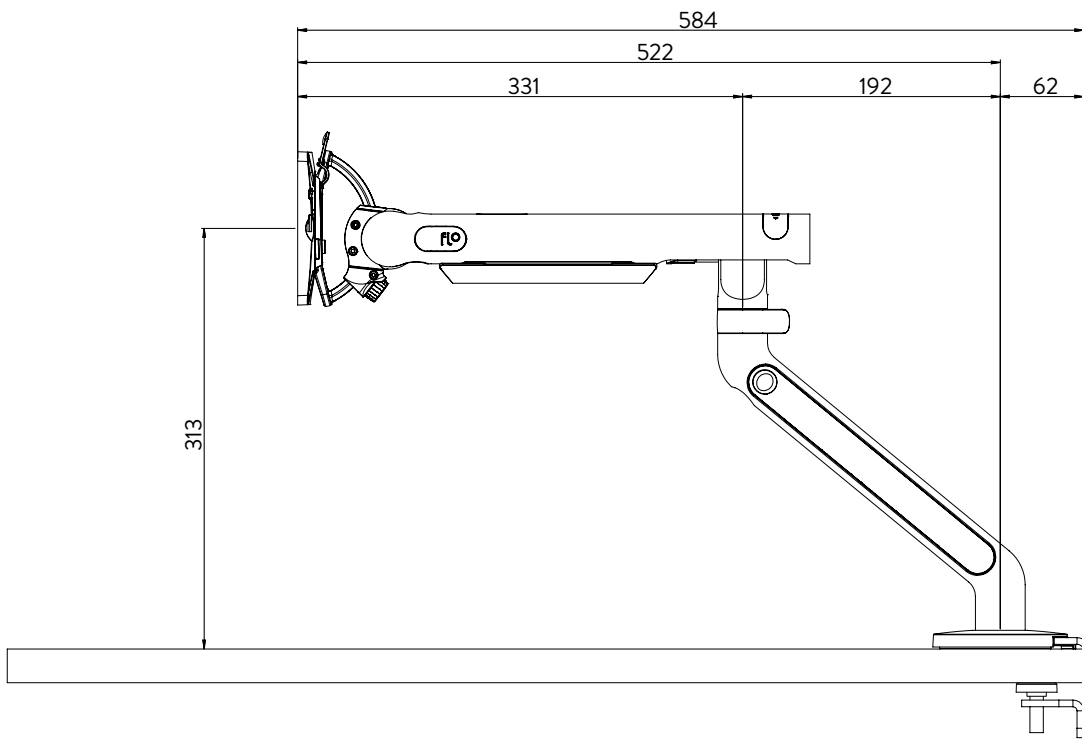

Highest Position

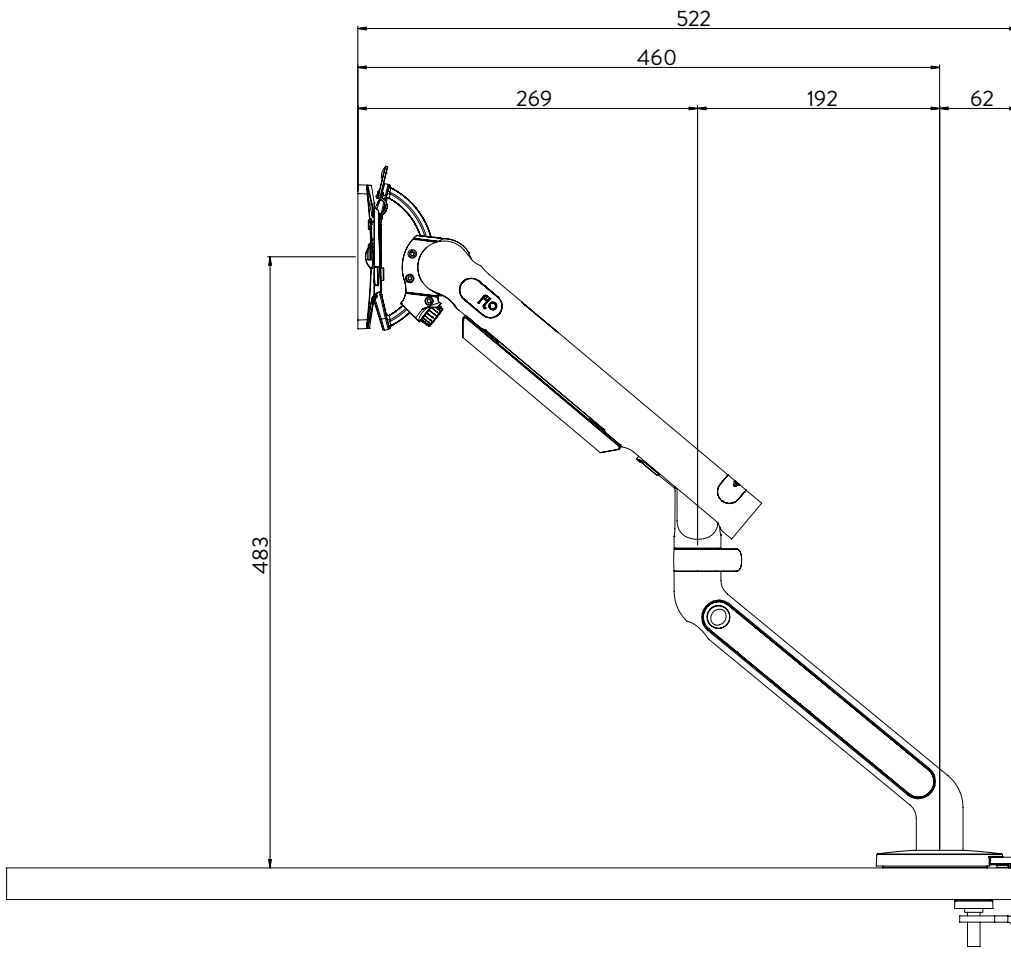

Minimum Reach Dimensions

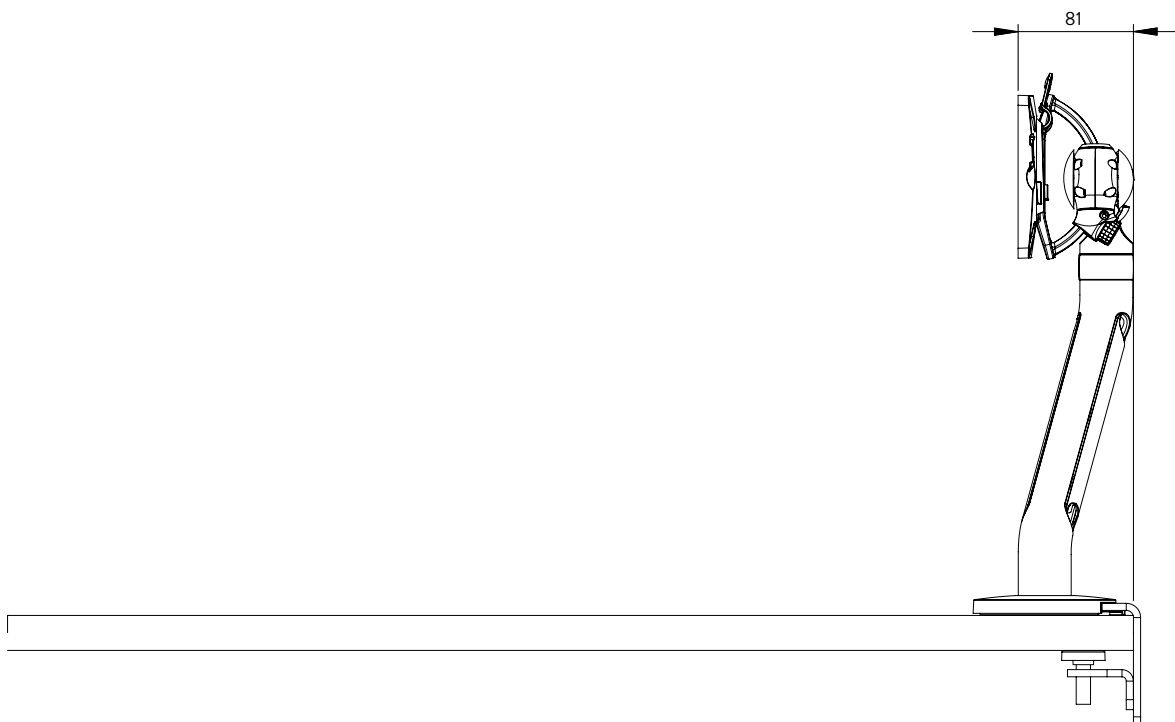

Height Dimensions

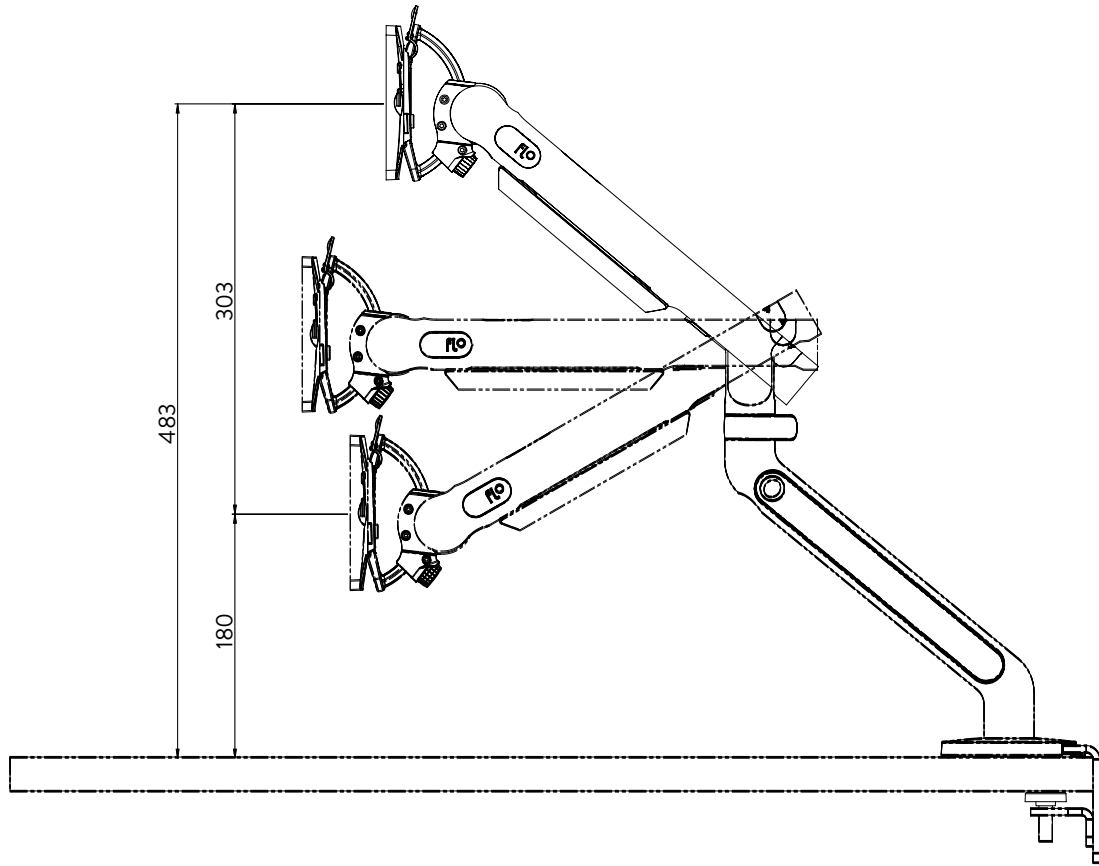

VESA Tilt Dimensions

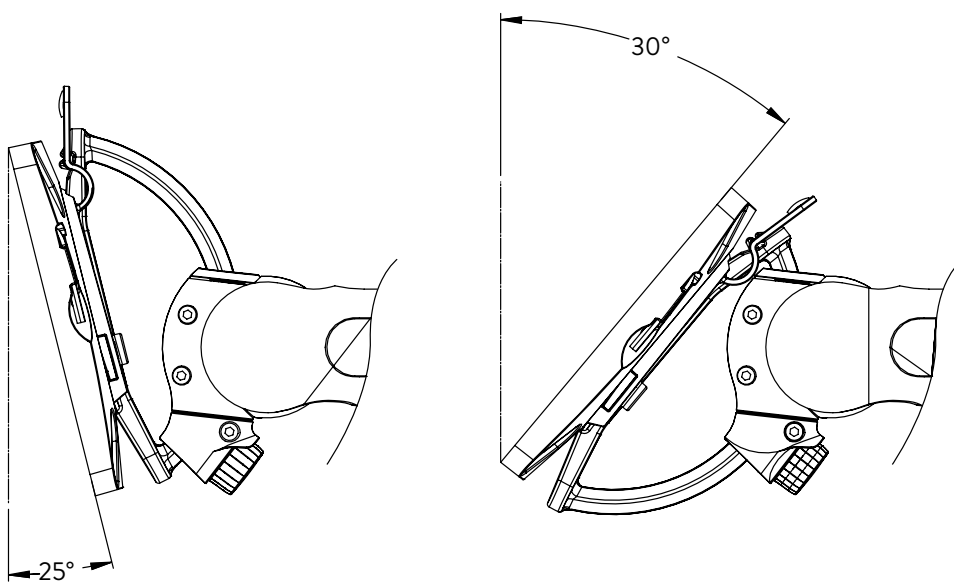

LOGISTICAL

Box contains	Arm & Quick Release Mount Plate (incl. VESA screw pack), Allen Key, Instructions
Product net weight:	1.52 kg
Box dims	720 x 125 x 68 mm
Box gross weight	1.77 kg
Master carton quantity	6 units
Master carton dims	725 x 255 x 223 mm
Master carton weight	11.55 kg
Country of origin	China

Bulk Pack (Pack of 10 - Selected Regions)

Box contains	10 x Arms, 10 x Quick Release Mount Plate (incl. VESA screw packs), 1 x Allen Key, 1 x Instructions
Master carton dims	700 x 300 x 290 mm
Master carton weight	17.5 kg
Country of origin	China

ORDERING INFORMATION

<u>Product Description</u>	<u>Product Code</u>	<u>Colour</u>
Flo Arm (Requires Desk Fixing)	FLO/013/010/S	Silver
Flo Arm (Requires Desk Fixing)	FLO/013/010/B	Black
Flo Arm (Requires Desk Fixing)	FLO/013/010/W	White
Flo Arm (Requires Desk Fixing), Bulk Pack	FLO/013/010/X10/S	Silver
Flo Arm (Requires Desk Fixing), Bulk Pack	FLO/013/010/X10/B	Black
Flo Arm (Requires Desk Fixing), Bulk Pack	FLO/013/010/X10/W	White

WARRANTY

Warranty Term	12 years
----------------------	----------

COMPLIANCE & SAFETY CERTIFICATION

Whilst no mandatory standards apply to the monitor arm product sector, all Colebrook Bosson Saunders monitor arms have been designed with appropriate articulation features, dimensional range and adjustability to conform to the requirements of BS EN ISO 9241:5 1999 Ergonomic requirements for office work with visual display terminals (VDTs).

CLEANING, STORAGE & MAINTENANCE

Routine servicing	Periodic inspection
Service components	Available to order
Cleaning & Maintenance	Damp cloth, no abrasives, no solvents to be used on the cosmetic surfaces
Handling & Storage	Do not drop or expose to moisture

While every effort is made to ensure the accuracy of our technical information, Colebrook Bosson Saunders (Products) Ltd accept no liability for the accuracy of the information contained in this document and reserve the right to modify the specifications or data contained herein without prior notification.