



ECHO**JAZZ** AG
RINGSTRASSE 25
6010 KRIENS
SWITZERLAND
[WWW.ECHO**JAZZ**.COM](http://WWW.ECHOJAZZ.COM)
+41 41 340 18 80
[INFO@ECHO**JAZZ**.COM](mailto:INFO@ECHOJAZZ.COM)

ECHOCARRY 12MM DATASHEET

TABLE OF CONTENTS



ECHOCARRY 12MM.....1

 TENDER TEXT3

 DATASHEET ECHOBOARD® 12MM4

 COLOURS ECHOBOARD® 12MM5

 DIMENSIONS & PARTS.....6

 ECHOCARRY 12MM M.....6

 ECHOCARRY 12MM LEATHER STRAPS (OPTIONAL)6

 ECHOCARRY 12MM L.....7

 CLEANING & CARE.....8

PRODUCT NAME

EchoCarry 12mm

DESCRIPTION

Mobile acoustic office organiser, with textile surface made of 100% PET and with integrated handle and optional leather straps.

The EchoCarry is an office organiser for personal equipment. At the workplace, laptop, accessories, office materials and private things are always well tidied and easily at hand thanks to two storage positions. The integrated handle allows the toolbox to be quickly stored in a compartment or cupboard at the end of the working day.

The elegant office companion is made of the acoustic absorber EchoBoard® around a stable central panel board with a hygienically clean handle unit. This central panel is either made from European birch wood or made from recycled cosmetics packaging and PET bottle tops. In use, EchoCarry is very quiet and muffles ambient noise. The organiser symbolises the focus on ergonomics in the modern mobile working environment.

Due to the recycled material, deviations in the quality of the plastic central panel are possible.

PRODUCT PROPERTIES

Dimensions: 400x312x190mm (EchoCarry M); 524x250x177mm (EchoCarry L)

ACOUSTIC PERFORMANCE

aw: 0.30-0.90

NRC: 0.45-0.85

INSTALLATION

- No installation needed

MATERIAL PROPERTIES

- Homogeneous edges throughout
- Extremely robust and shockproof
- Very high colour fastness of the all-round homogeneous textile surface available in over 10 colours
- Flame retardant. B-s1,d0 certified according to EN 13501
- Extremely low volatile organic compounds below $< 0.5\text{mg/m}^2/\text{h}$, certified according to ASTM D5116
- Formaldehyde emission below $< 0.1\text{mg/m}^2/\text{h}$, certified according to ASTM D5116
- Dimensionally stable up to 50°C and 95%rH
- Melting point: 250°C
- Decomposition Temp: $> 250^\circ\text{C}$
- Alkalinity: pH: 7.8 (pH 7 is neutral)

CLEANING & CARE

Can be cleaned dry and damp with chlorine or hydrogen peroxide.

ENVIRONMENT

- 100% PET with a content of over 50% from recycled PET bottles
- 100% recyclable
- eco-1 rating within eco-bau & Minergie-Eco requirements
- Cradle to Cradle Bronze certified

DISPOSAL

The product is recyclable as part of ECHOJAZZ's stewardship programme.

DATASHEET ECHOBOARD® 12MM



EchoBoard® 12mm is a high quality sound absorber with an α_w of up to 0.90 and a NRC of up to 0.85, which can be used for acoustic ceilings, walls, office desks or room dividers.

NAME	EchoBoard® 12mm																												
DIMENSIONS	1200mm (± 1mm) x 2800mm (± 1mm)																												
COMPOSITION	100% PET (> 50% recycled PET)																												
PET-BOTTLES* PER PANEL	168 PET-Bottles *The number of PET bottles refers to 500ml PET bottles with a bottle weight of 24g.																												
WEIGHT	2400g/m² (± 10%)																												
MATERIAL THICKNESS	12mm																												
LIGHT FASTNESS ISO 105-B02-1994	> 7																												
FIRE PROTECTION EN 13501	B-s1, d0																												
VOC EMISSIONS ASTM D5116	< 0.5mg/m²/h																												
FORMALDEHYDE EMISSIONS ASTM D5116	< 0.1mg/m²/h																												
ENVIRONMENTAL CERTIFICATES	eco1 Minergie-Eco Cradle to Cradle Certified® Bronze M1 emission-free materials																												
ABSORPTION COEFFICIENT DIN EN ISO 11654 ASTM C423	aw 0.30 (direct mounting) aw 0.60 (50mm wall/ceiling distance) aw 0.90 (200mm wall/ceiling distance) NRC = 0.45 (direct mounting) NRC = 0.70 (50mm wall/ceiling distance) NRC = 0.85 (200mm wall/ceiling distance)																												
COLOURS	> 10																												
ABSORPTION GRAPH	<div><table><caption>Approximate data points from the Absorption Graph</caption><thead><tr><th>Frequency (Hz)</th><th>Direct Mount (Green)</th><th>50mm Distance (Yellow)</th><th>200mm Distance (Blue)</th></tr></thead><tbody><tr><td>125</td><td>0.05</td><td>0.10</td><td>0.50</td></tr><tr><td>250</td><td>0.08</td><td>0.25</td><td>0.80</td></tr><tr><td>500</td><td>0.20</td><td>0.60</td><td>0.95</td></tr><tr><td>1000</td><td>0.50</td><td>0.95</td><td>0.80</td></tr><tr><td>2000</td><td>0.85</td><td>1.00</td><td>0.95</td></tr><tr><td>4000</td><td>1.00</td><td>0.95</td><td>0.95</td></tr></tbody></table><div><div>— Sound absorption coefficient (direct mount)</div><div>— Sound absorption coefficient (50mm)</div><div>— Sound absorption coefficient (200mm)</div></div></div>	Frequency (Hz)	Direct Mount (Green)	50mm Distance (Yellow)	200mm Distance (Blue)	125	0.05	0.10	0.50	250	0.08	0.25	0.80	500	0.20	0.60	0.95	1000	0.50	0.95	0.80	2000	0.85	1.00	0.95	4000	1.00	0.95	0.95
Frequency (Hz)	Direct Mount (Green)	50mm Distance (Yellow)	200mm Distance (Blue)																										
125	0.05	0.10	0.50																										
250	0.08	0.25	0.80																										
500	0.20	0.60	0.95																										
1000	0.50	0.95	0.80																										
2000	0.85	1.00	0.95																										
4000	1.00	0.95	0.95																										

COLOURS



ECHOB[®]BOARD 12MM



ECHOCARRY CENTRE PANEL

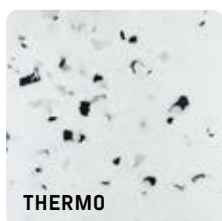
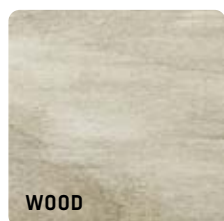

DIMENSIONS & PARTS



ECHOCARRY 12MM M
1630 (WOOD) / 1670 (THERMO)
400x312x190mm

ECHOCARRY 12MM LEATHER STRAPS (OPTIONAL)
1155
210x19x3mm

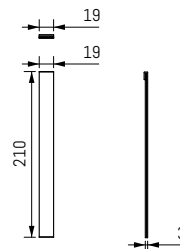
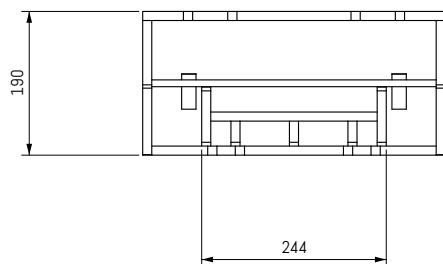
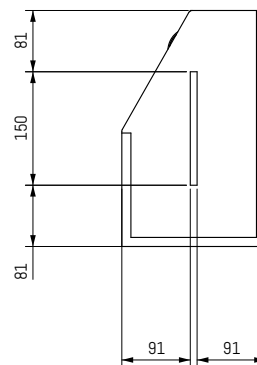
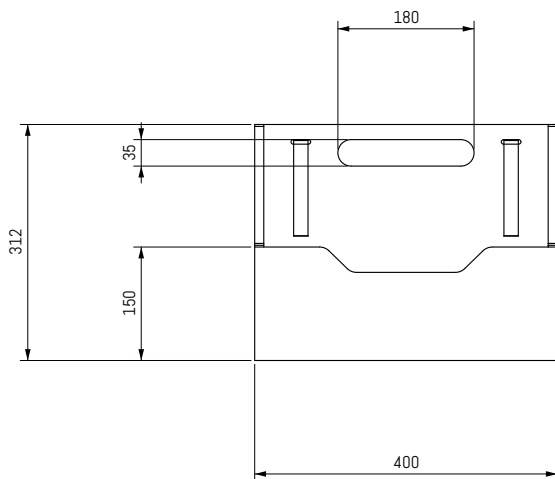
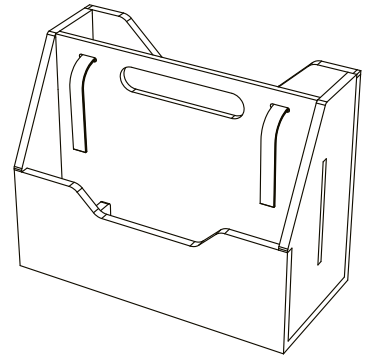

PARTS

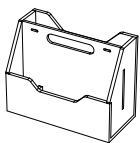

1x
EchoCarry 12mm M

2x
Leather strap
(Optional)

1x
Individually adjustable compartments

DIMENSIONS & PARTS

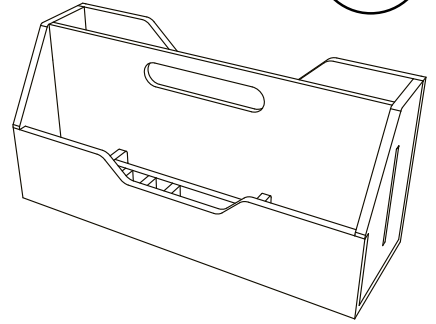

ECHOCARRY 12MM L
1668 (WOOD) / 1669 (THERMO)
524x250x177mm

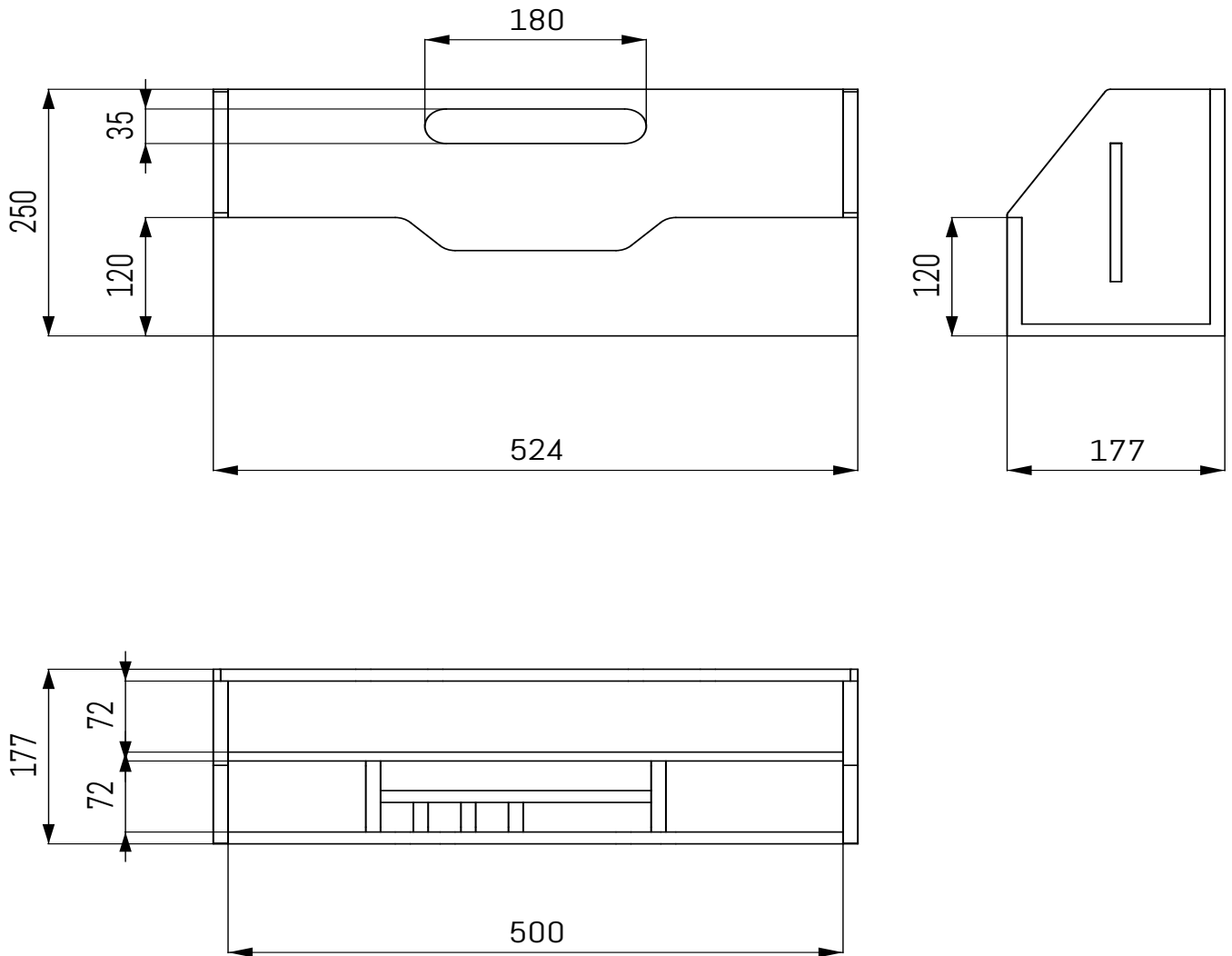

PARTS

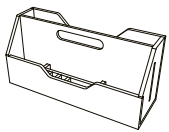

1x EchoCarry 12mm L
1x Individually adjustable compartments

SURFACE DISINFECTION

Spray disinfectants can be used for rapid surface disinfection.



DUSTER/VACUUM CLEANER

For dusting use duster or vacuum cleaner.



SPARKLING WATER

For slight contamination apply sparkling water to polluted area. Wipe carefully with a sponge.

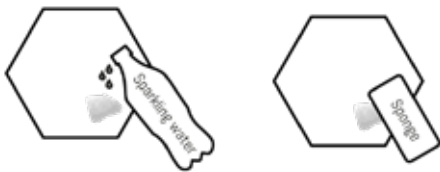

UPHOLSTERY CLEANER

For medium contamination apply upholstery cleaner to polluted area. Wipe carefully with a sponge.



BLEACH

For heavy contamination apply bleach as chlorine or hydrogen peroxide on polluted area. Wipe carefully with a sponge and sparkling water.

Use of protection gloves and glasses is mandatory!

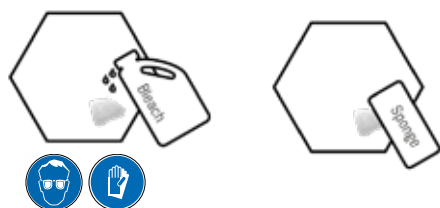

Please make first a cleaning attempt on an inconspicuous spot. Follow the instructions of the cleaning agents.